

LÜDECKE

Since 1930. The perfect connection.





Coupling Systems and Accessories for the Processing Industry

Product Range 2018 / 19

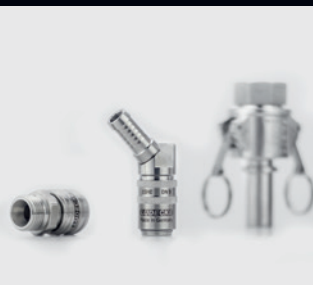

**Clean
Connect**
by LÜDECKE



LÜDECKE MADE IN GERMANY 



High Quality Coupling Systems for Applications with Elevated Hygienic Requirements and for Lines with Aggressive Media

Clean Connect
by **LUDECKE**



In applications with specific hygienic standards or in lines with aggressive media (i.e. gaseous, chemicals, pharmaceuticals or varnish products), premium couplings and fittings are required. These products allow a safe and reliable process within the connected machines, industrial equipment and tools.

The **LUDECKE** product portfolio made of stainless steel 1.4305, 1.4401 and 1.4404 (1.4571 on request), allows the utilization in various applications and markets, such as:

- Pharmaceutical and medical technology
- Chemical technology
- Food & beverage industry
- Temperature regulation and plastics industry
- Clean room applications
- Pneumatic applications
- High quality control, measurement and regulation technology
- Snow making machines
- Machine and plant manufacturing

Especially for high purity surroundings, we offer materials and surfaces which are easy to clean and exempt of notches or grooves.





Fittings for Cleaning Applications in the Food Industry

NEW!

New in our product portfolio are coupling systems and fittings for cleaning applications in the food processing sector.

- Extremely robust, secure and reliable
- High sealing characteristic and durable
- Easy handling
- High flow rate due to maximum bore
- Hygienic smooth surfaces to prevent dirt accumulation
- Different connection types
 - Squeeze nut (for low working pressure)
 - Hose crimping, thread (for high working pressure)

Quick Connect Couplings:

- Fast and easy coupling or decoupling
- For rinsing with water
- O-rings which are especially approved for the food industry (VO 1935/ 2004)

Fittings:

- For applications with aggressive cleaning agents



A Superior Product Range for the Processing Industry

From the classic claw couplings and quick connect couplings up to high pressure quick couplings - you will find the right product for nearly any application.



Quick Connect Couplings

OptiFlow-Line

Series **ESMCE** DN 2.7* **ESME** DN 5* **ESE** DN 7.2* **ESIE** DN 7.8* **ESIGE** DN 10* **ESGE** DN 19

Plug Profile
(original size)



Ø 5 mm

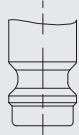

Ø 9 mm

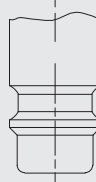

Ø 12 mm

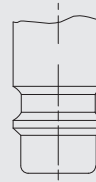

Ø 12 mm

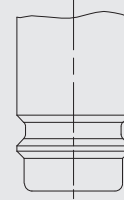

Ø 15 mm

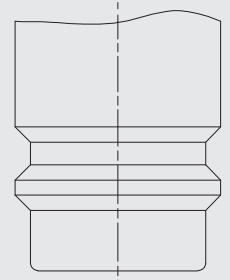

Ø 27 mm



Materials:

Body:	Stainless Steel 1.4305 Stainless Steel 1.4404	Stainless Steel 1.4305 Stainless Steel 1.4404	Stainless Steel 1.4305 Stainless Steel 1.4404	Stainless Steel 1.4305 Stainless Steel 1.4404	Stainless Steel 1.4305 Stainless Steel 1.4404	Stainless Steel 1.4404
Sleeve:	Stainless Steel 1.4305 Stainless Steel 1.4404	Stainless Steel 1.4305 Stainless Steel 1.4404	Stainless Steel 1.4305 Stainless Steel 1.4404	Stainless Steel 1.4305 Stainless Steel 1.4404	Stainless Steel 1.4305 Stainless Steel 1.4404	Stainless Steel 1.4404
Valve body:	Stainless Steel 1.4305 Stainless Steel 1.4404	Stainless Steel 1.4305 Stainless Steel 1.4404	Stainless Steel 1.4305 Stainless Steel 1.4404	Stainless Steel 1.4305 Stainless Steel 1.4404	Stainless Steel 1.4305 Stainless Steel 1.4404	Stainless Steel 1.4404
Valve:	Stainless Steel 1.4305 Stainless Steel 1.4404	Stainless Steel 1.4305 Stainless Steel 1.4404	Stainless Steel 1.4305 Stainless Steel 1.4404	Stainless Steel 1.4305 Stainless Steel 1.4404	Stainless Steel 1.4305 Stainless Steel 1.4404	Stainless Steel 1.4404
Springs, Retaining ring:	Stainless Steel 1.4310 Stainless Steel 1.4571	Stainless Steel 1.4310 Stainless Steel 1.4571	Stainless Steel 1.4310 Stainless Steel 1.4571	Stainless Steel 1.4310 Stainless Steel 1.4571	Stainless Steel 1.4310 Stainless Steel 1.4571	Stainless Steel 1.4571
Balls:	Stainless Steel 1.3541 Stainless Steel 1.4404	Stainless Steel 1.3541 Stainless Steel 1.4404	Stainless Steel 1.4305 Stainless Steel 1.4404	Stainless Steel 1.4034 Stainless Steel 1.4404	Stainless Steel 1.4034 Stainless Steel 1.4404	Stainless Steel 1.4404
O-rings:	FKM	FKM	FKM	FKM	FKM	FKM
Special seals for other media on request:	EPDM, FFKM	EPDM, FFKM	EPDM, FFKM	EPDM, FFKM	Buna N	EPDM, FFKM
Plug:	Stainless Steel 1.4305 Stainless Steel 1.4404	Stainless Steel 1.4305 Stainless Steel 1.4404	Stainless Steel 1.4305 Stainless Steel 1.4404	Stainless Steel 1.4305 Stainless Steel 1.4404	Stainless Steel 1.4305 Stainless Steel 1.4404	Stainless Steel 1.4404
Max. Working Pressure:	PN 35 bar	PN 35 bar	PN 35 bar	PN 35 bar	PN 35 bar	PN 35 bar
Temperature**:	-15°C – + 150°C	-15°C – + 200°C	-15°C – + 200°C	-15°C – + 200°C	-15°C – + 150°C	-15°C – + 150°C
Thread Types:	ISO 228/ DIN 13	ISO 228/ DIN 13	ISO 228	ISO 228	ISO 228	ISO 228
Flow Capacity: (Air – 6 bar/ 0.5 bar pressure drop) single shut-off.	165 l/min	510 l/min	1150 l/min	1850 l/min	2150 l/min	8000 l/min
Type of Valve: Operation:	single/ double one-hand	single/ double one-hand	single/ double one-hand	single/ double one-hand	single/ double one-hand	single/ double one-hand

*This stainless steel series is available in two versions on request (1.4305 and 1.4404). Therefore, also the component materials are different of Springs/Retaining Rings, Balls/Pins as well as plugs.
Example: Body, etc.: Stainless Steel 1.4305 → Springs/Retaining ring: Stainless Steel 1.4310 → Balls: Stainless Steel 1.3541 → Plug: 1.4305, but: Body, etc.: Stainless Steel 1.4404 → Springs/Retaining rings: Stainless Steel 1.4571 → Balls: Stainless Steel 1.4404 → Plugs: Stainless Steel 1.4404

**Max. Temperature resistance is subject to the suitable media and sealing material

Temperature Regulation Quick Connect Couplings



Series

ESHME
DN 6

NEW!
ESHMTE
DN 6

ESHE
DN 9

NEW!
ESHTe
DN 9

Manifolds for
Temperature Regulation
Lines

Plug Profile
(original size)

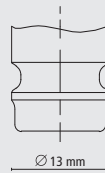
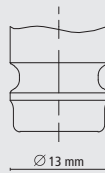

Materials:

Body:	Stainless Steel 1.4305	Stainless Steel 1.4305	Stainless Steel 1.4305	Stainless Steel 1.4305
Sleeve:	Stainless Steel 1.4305	Stainless Steel 1.4305	Stainless Steel 1.4305	Stainless Steel 1.4305
Valve body:	Stainless Steel 1.4305	Stainless Steel 1.4305	Stainless Steel 1.4305	Stainless Steel 1.4305
Valve:	Stainless Steel 1.4305	Stainless Steel 1.4305	Stainless Steel 1.4305	Stainless Steel 1.4305
Springs, retaining ring:	Stainless Steel 1.4310	Stainless Steel 1.4310	Stainless Steel 1.4310	Stainless Steel 1.4310
Balls:	Stainless Steel 1.4034	Stainless Steel 1.4034	Stainless Steel 1.4034	Stainless Steel 1.4034
O-rings:	FKM	Special-Hitec-FKM-O-Ring	FKM	Special-Hitec-FKM-O-Ring
Special seals for other media on request:	EPDM, FFKM	EPDM, FFKM	EPDM, FFKM	EPDM, FFKM
Plug:	Stainless Steel 1.4305	Stainless Steel 1.4305	Stainless Steel 1.4305	Stainless Steel 1.4305
Max. Working Pressure:	PN 15 bar	PN 15 bar	PN 15 bar	PN 15 bar
Temperature:	-20°C – + 200°C*	-20°C – + 200°C**	-20°C – + 200°C*	-20°C – + 200°C**
Thread Types:	ISO 228/ DIN 13	ISO 228/ DIN 13	ISO 228/ DIN 13	ISO 228/ DIN 13
Flow capacity: single shut-off:	Kv = 0.72	Kv = 0.72	Kv = 1.8	Kv = 1.8
Version:	straight/45°/90°	straight/45°/90°	straight/45°/90°	straight/45°/90°
Type of Valve:	single/double/ straight-trough	single/double/ straight-trough	single/double/ straight-trough	single/double/ straight-trough
Operation:	one-hand	one-hand	one-hand	one-hand

Material:	Stainless Steel 1.4401
Max. Working Press.:	PN 15 bar
Temperature:	-20°C – + 200°C
Thread connections:	ISO 228

*subject to the suitable media (oil: 200°C, water: 150°C, air: 200°C)
**subject to the suitable media (oil: 200°C, water: 160°C, air: 200°C)

Quick Connect Couplings and Fittings for Cleaning and Compressed Air Applications in the Food Industry

NEW!

Hose Barb with Crimping Ferrules	Thread Stems with Male Thread and Hose Squeeze Nut	Quick Connect Couplings with Hose Squeeze Nut	Quick Connect Couplings with Hose Squeeze Nut	Blow-off Valve
----------------------------------	--	---	---	----------------

Series

**ESLGE
DN 13**

**ESE
DN 7.2**

**ESE
DN 7.2**

Plug Profile
(original size)

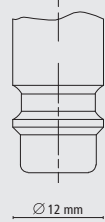
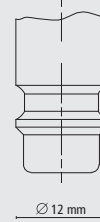
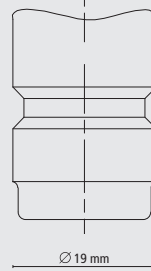

Materials:					
Body:	Stainless Steel 1.4404	Stainless Steel 1.4404	-	Stainless Steel 1.4305	Stainless Steel 1.4305
Hexagon nut:	Stainless Steel 1.4404	-	-	-	-
Crimping ferrule:	Stainless Steel 1.4404	-	-	-	-
Sleeve:	-	-	Stainless Steel 1.4404	-	-
Valve body:	-	-	Stainless Steel 1.4404	Stainless Steel 1.4305	-
Valve:	-	-	-	Stainless Steel 1.4305	-
Springs, Retaining Ring:	-	-	Stainless Steel 1.4571	Stainless Steel 1.4310	-
Balls:	-	-	Stainless Steel 1.4401	Pins: Stainless Steel 1.4305 FKM	-
Seals:	-	-	EPDM	EPDM, FFKM	FKM
Special seals for other media on request:	-	-	FKM	-	-
Plug:	-	-	Stainless Steel 1.4404	Stainless Steel 1.4305	-
Handle:	-	-	-	-	Stainless Steel 1.4308
Max. Working Pressure*:	PN 40 bar	PN 40 bar	PN 40 bar	PN 35 bar	PN 12 bar
Temperature:	up to +150°C	up to +150°C	up to +140°C	-15°C – + 200°C	-20°C – +90°C
Thread Types:	ISO 228	ISO 228	ISO 228	-	-
Type of Valve:	-	-	straight-through	single	-
Operation:	-	-	two-hands	one-hand	-



O-rings which are especially approved for the food sector VO 1935/2004, DVGW W 270, DVGW W 534

O-rings according to VO 1935/2004





O-rings according to VO 1935/2004

*subject to temperature, assembly and hose

Claw Couplings

Series	Claw Couplings	Mody-Safety-Screwing Couplings
		
Norm:	DIN 3489	DIN 3238
Materials:		
Claw:	Stainless Steel 1.4401	Stainless Steel 1.4401
Body:	Stainless Steel 1.4401	Stainless Steel 1.4404
Locking nut:	-	Stainless Steel 1.4305
Seals:	FKM	FKM
Special seals on request:	TFEP, EPDM	TFEP, EPDM
Max. Working Pressure:	PN 16 bar	PN 16 bar
Temperature:	-30°C – + 200°C	-30°C – + 200°C
Thread types:	ISO 228	ISO 228
Type of valve:	straight-through	straight-through
Operation:	two-hands	two-hands
Claw distance:	42 mm	42 mm

Chemical and Industrial Fittings

Series	Kamlok Quick Couplings	Steam Screwings	Thread Stems	SoftFlow Material Conveying Quick Connect Couplings
				
Norm:	DIN EN 14 420-7	DIN EN 14 423	DIN EN 14 420-5	DN 41
Materials:				
Body:	-	Steel zinc plated yellow passivated Brass MS 58 plain, St. Steel 1.4305	-	Stainless Steel 1.4305
Sleeve:	-	-	-	Aluminium (hard coated)
Coupling body:	Stainless Steel 1.4401	-	Stainless Steel 1.4401 electropolished	-
Valve body:	-	-	-	Stainless Steel 1.4305
Clamp:	-	Brass MS 58 plain	-	-
Springs, Retaining Ring:	-	-	-	Stainless Steel 1.4310
Balls:	-	-	-	Stainless Steel 1.4034
Screw:	-	-	-	Stainless Steel 1.4031
Seals:	Buna N	Frenzelit Novapress Multi II*	-	Buna N
Special seals on request:	Hypalon, EPDM, FKM	-	-	-
Handle:	Stainless Steel 1.4401	-	-	-
Plug:	Stainless Steel 1.4401	-	-	Stainless Steel 1.4305
Max. Working Pressure:	PN 16 bar	PN 18 bar	PN 25 bar	PN 10 bar
Temperature:	-40°C – + 95°C	up to +210°C (satur. steam)/ up to +120°C (hot water)	-40°C – + 95°C	-15°C – + 95°C
Thread Types:	-	ISO 228/ DIN 2999	ISO 228	-

*female thread

Water Fittings

Quick Connect Couplings



Series

**WSE
DN 9**



Materials:

Body: Stainless Steel 1.4305
Sleeve: Stainless Steel 1.4305
Valve body: Stainless Steel 1.4305
Valve: Stainless Steel 1.4305

Springs, Retaining Ring: Stainless Steel 1.4310

Pins: Stainless Steel 1.4305

Seals: EPDM

Plug: Stainless Steel 1.4305

Max. Working Pressure: PN 16 bar

Temperature: +95°C

Thread Types: ISO 228

Type of Valve: single/ straight-through

Operation: one-hand

Claw Couplings

Series

GEKA



Materials:

Claw: Chromium Steel similar to 1.4401
Body: Chromium Steel similar to 1.4401

Seals: FKM

Max. Working Pressure: PN 40 bar

Temperature: -5°C – +100°C

Thread Types: ISO 228

Type of Valve: straight-through

Operation: two-hands

Claw Distance: 40 mm

Hose Reels, Wall Hose Reels, Wall Hose Holders



Series

**ALBA STAR INOX
SERIES II**



Thread Connection: G 3/4 m

Materials:

Trestle: Stainless Steel electropolished
Wheels: Solid rubber

Swivelling connector: Brass Cuphin

Hose i.D. : 13 - 16 - 19 - 25 mm

Max. Working Pressure: 25 bar

Temperature: up to +100°C

Weight: 14 kg

**ALBA STATUS INOX
SERIES III**



G 3/4 m

Stainless Steel electropolished

Brass Cuphin

13 - 16 - 19 mm

25 bar

up to +100°C

11.2 kg

ALBA MIDI INOX



-

Stainless Steel 1.4301

-

-

13 - 16 - 19 - 25 mm

-

up to +100°C

0.9 kg

Fittings for Snow Pump Installations

High-Pressure Quick Couplings



Series/Nominal diameter:	US-Mil-Norm C-27487 / DIN EN 14 420-7
Materials:	
Body:	Steel zinc-plated and blue passivated
Coupling body:	Stainless Steel 1.4401
Valve:	-
Pins:	Stainless Steel 1.4401
Cord:	Stainless Steel 1.4401
Ring:	Stainless Steel 1.4401
Clip:	Steel zinc-plated
Seals:	Buna N, PTFE
Handle:	Stainless Steel 1.4401
Max. Working Pressure:	PN 60 bar
Temperature:	-40°C – + 95°C
Thread Types:	ISO 228/ DIN 2999

Drain Adaptor



Stainless Steel 1.4401
Stainless Steel 1.4401
MS 58 nickel-plated
Stainless Steel 1.4401
Stainless Steel 1.4401
Stainless Steel 1.4401
Steel zinc-plated
Buna N
Stainless Steel 1.4401
PN 60 bar
-40°C – + 95°C
-

High-Pressure Screwings



Steel zinc-plated and blue passivated
-
-
-
-
-
Steel zinc-plated
-
PUR*
-
PN 60 bar
-40°C – + 95°C
ISO 228/ DIN 2999

*female thread

Accessories

Hose Clamps



Norm:	DIN 20039 A
Materials:	
Clamps:	Stainless Steel 1.4401
Spacers:	Stainless Steel 1.4401
Screws:	Stainless Steel A4-70
Band:	-
Body:	-
Max. Working Pressure:	PN 16 bar

High-Performance Hose Clamps



DIN 3017
-
-
Stainless Steel W5
Stainless Steel W5
Stainless Steel W5
-

Heavy Duty Clamps



DIN 3017
-
-
Steel zinc-plated
Stainless Steel 1.4016
Steel zinc-plated
-

LÜDECKE

LÜDECKE

Since 1930. The perfect connection.

LÜDECKE GmbH · Heinrich-Hauck-Str. 2 · D-92224 Amberg · Telephone: +49 96 21 7682 0 · Fax: +49 96 21 7682 99
www.luedecke.com · E-Mail: info@luedecke.de