

power-driven carrier rollers // up to 40 kg

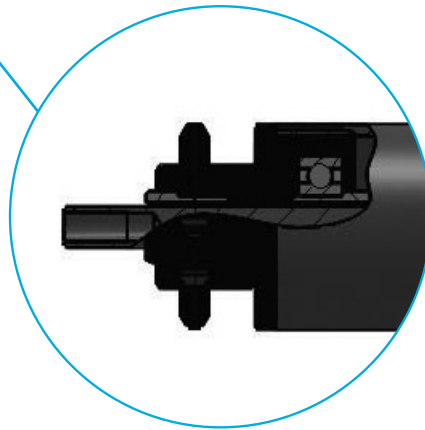
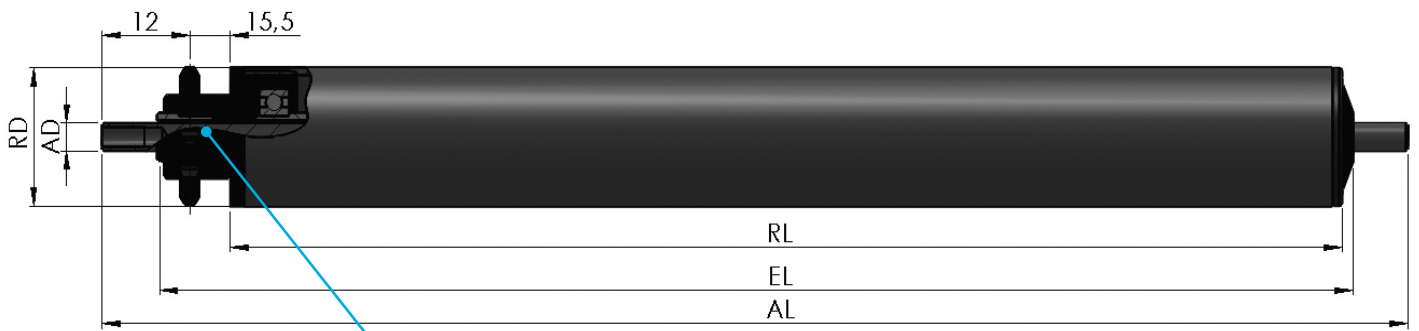

1K-KU-1/2-Z11-fixed/accumulating

Areas of use:

- for transporting lightweight products on a power-driven roller conveyor
- for dry and dust-free interiors

counter-bearing:

- the type of bearing depends on the application: select between TKL and TRK

Drive:

- single sprocket made of plastic, lantern gear sprocket teeth
- sprocket size: 1/2" x 5/16", with 11 teeth
- available as fix: (fixed drive) or accu: (accumulating drive)

Properties:

- minimal running noises
- low weight
- temperature range: -5 to +50° C
- speed: max. 0.5 m/s
- load capacity: max. 40 kg/roller
(Depending on the load limit of tube, bearing and axle; refer to the general information)

Optional:

- available with various coatings
- stainless steel bearing, tube and axle

Combination

counter-bearing

tkl	trk	tube-Ø	axle-Ø	ST	STI	STP	N	KB	KGH	ALU	STG
x	x	50 x 1.5	10 / 12 / 14	x	x	x	x			x	x
x	x	50 x 2	10 / 12 / 14	x	x	x	x				x
x		50 x 2.8	10 / 12 / 14					x	x		
x	x	60 x 2	10 / 12 / 14	x	x	x					x
x		60.3 x 1.65	10 / 12 / 14				x				x
x		63 x 3	10 / 12 / 14					x	x		
x	x	80 x 2	10 / 12 / 14	x	x	x	x				x
x		90 x 7	10 / 12 / 14					x	x		

Axle type

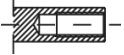
counter-bearing	axle-Ø mm	EL=	 external thread	 internal thread
TKL	10	RL +	45	33
	12	RL +	47	33
	14	RL +	49	33
TRK	10	RL +	47	35
	12	RL +	49	35
	14	RL +	51	35



“The axle length and installation length change depending on the type of axle end finishing”

Order example

type	1K-KU-1/2-Z11-fixed	TKL	50x2	STI	A12	IGM8	EL=553	AL= x
rollers type								
type counter-bearing								
tube-Ø and wall thickness								
tube surface								
axle-Ø								
axle end finishing								
installation length								
axle length AL								

power-driven carrier rollers // up to 100 kg

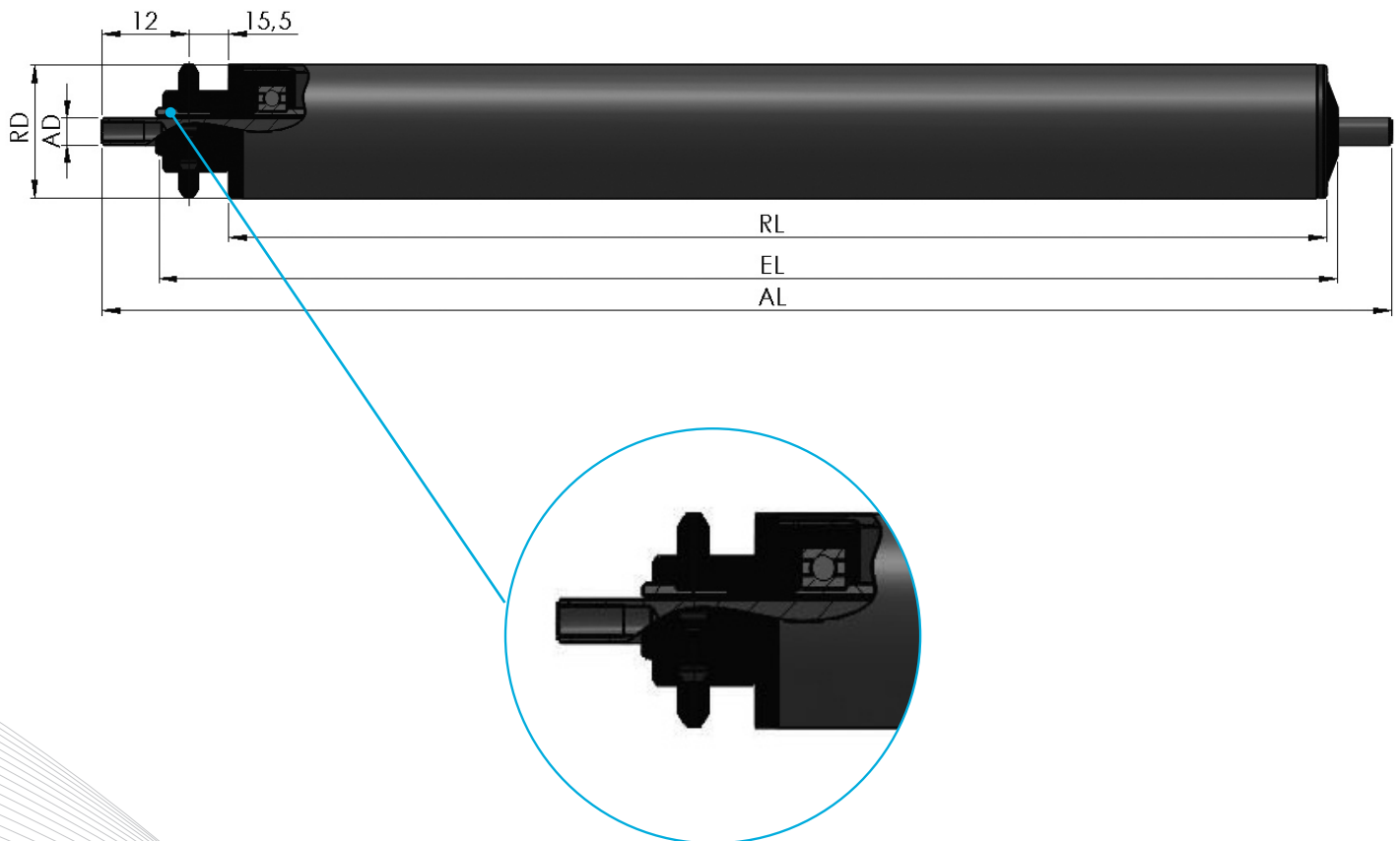

1K-ST-1/2-Z11-fixed/accumulating

Areas of use:

- for conveying lightweight to medium-weight products on a power-driven roller conveyor
- for dry and dust-free interiors

counter-bearing:

- the type of bearing depends on the application: select between TKL and TRK

Drive:

- single sprocket made of steel, lantern gear sprocket teeth
sprocket size: 1/2" x 5/16", with 11 teeth
- available as fix: (fixed drive) or accu: (accumulating drive)

Properties:

- minimal running noises
- low weight
- temperature range: -5 to +50° C
- speed: max. 0.5 m/s
- load capacity: max. 40 kg/roller
(Depending on the load limit of tube, bearing and axle; refer to the general information)

Optional:

- available with various coatings
- stainless steel bearing, tube and axle

Combination

counter-bearing		tube-Ø	axle-Ø	ST	STI	STP	N	KB	KGH	ALU	STG
TKL	TRK										
x	x	50 x 1.5	10 / 12 / 14	x	x	x	x			x	x
x	x	50 x 2	10 / 12 / 14	x	x	x	x				x
x		50 x 2.8	10 / 12 / 14					x	x		
x	x	60 x 2	10 / 12 / 14	x	x	x					x
x		60.3 x 1.65	10 / 12 / 14				x				x
x		63 x 3	10 / 12 / 14					x	x		
x	x	80 x 2	10 / 12 / 14	x	x	x	x				x
x		90 x 7	10 / 12 / 14					x	x		

Axle type

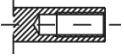
counter-bearing	axle-Ø mm	EL=	 external thread	 internal thread
TKL	10	RL +	45	33
	12	RL +	47	33
	14	RL +	49	33
TRK	10	RL +	47	35
	12	RL +	49	35
	14	RL +	51	35

 "The axle length and installation length change depending on the type of axle end finishing"

Order example

type	1K-ST-1/2-Z11-fixed	TKL	50x2	STI	A12	IGM8	EL=533	AL= x
rollers type								
type counter-bearing								
tube-Ø and wall thickness								
tube surface								
axle-Ø								
axle end finishing								
installation length								
axle length AL								

power-driven carrier rollers // up to 100 kg

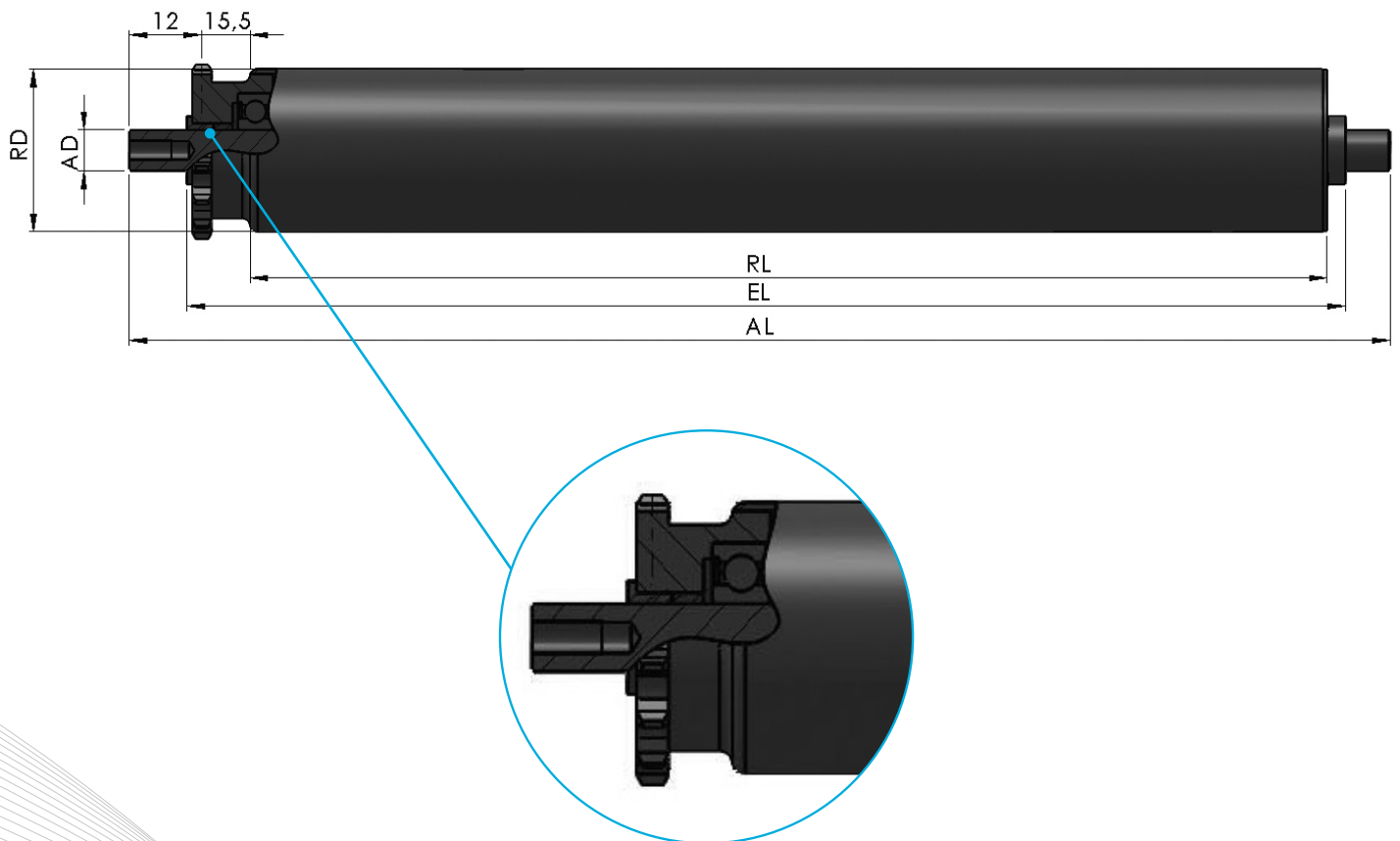

1K-ST-1/2-Z11-welded

Areas of use:

- for conveying lightweight to medium-weight products on a power-driven roller conveyor
- for dry and dust-free environments

counter-bearing:

- the type of bearing depends on the application: select between TKL and TRK

Drive:

- single sprocket made of steel, welded with the tube, lantern gear sprocket teeth
- sprocket size: 1/2" x 5/16", with 11 teeth

Properties:

- temperature range: -5 to +50° C
- speed: max. 0.5 m/s
- load capacity: max. 100 kg/roller
(Depending on the load limit of tube, bearing and axle; refer to the general information)

Optional:

- available with various coatings
- antistatic
- stainless steel bearing, tube and axle
- for heated and cold storage applications
- with flanges

Combination

counter-bearing

TKL	TRK	tube-Ø	axle-Ø	ST	STI	STP	N	KB	KGH	ALU	STG
x	x	50 x 1.5	10 / 12 / 14	x	x	x	x			x	x
x	x	50 x 2	10 / 12 / 14	x	x	x	x				x
x		50 x 2.8	10 / 12 / 14					x	x		
x	x	60 x 2	10 / 12 / 14	x	x	x					x
x		60.3 x 1.65	10 / 12 / 14				x				x
x		63 x 3	10 / 12 / 14					x	x		
x	x	80 x 2	10 / 12 / 14	x	x	x	x				x
x		90 x 7	10 / 12 / 14					x	x		

Axle type

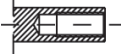
counter-bearing	axle-Ø mm	EL=	 external thread	 internal thread
TKL	10	RL +	45	33
	12	RL +	47	33
	14	RL +	49	33
TRK	10	RL +	47	35
	12	RL +	49	35
	14	RL +	51	35



"The axle length and installation length change depending on the type of axle end finishing"

Order example

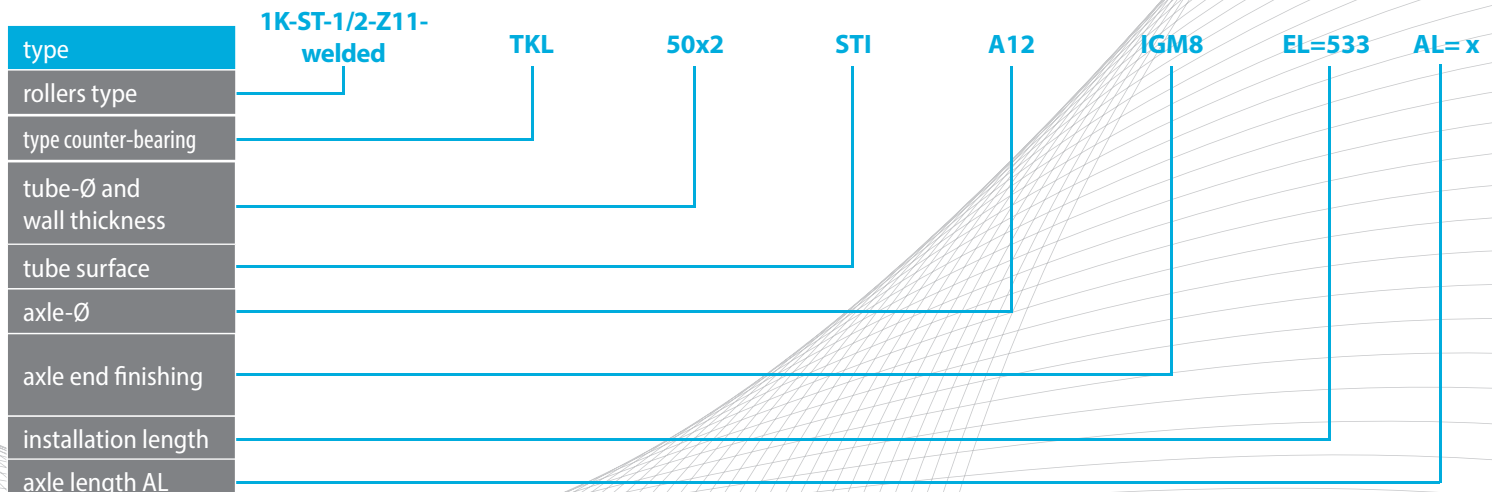

power-driven carrier rollers // up to 60 kg

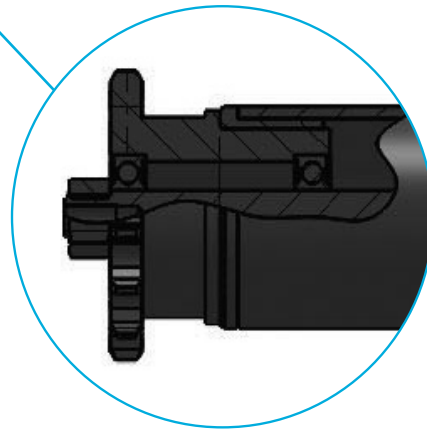
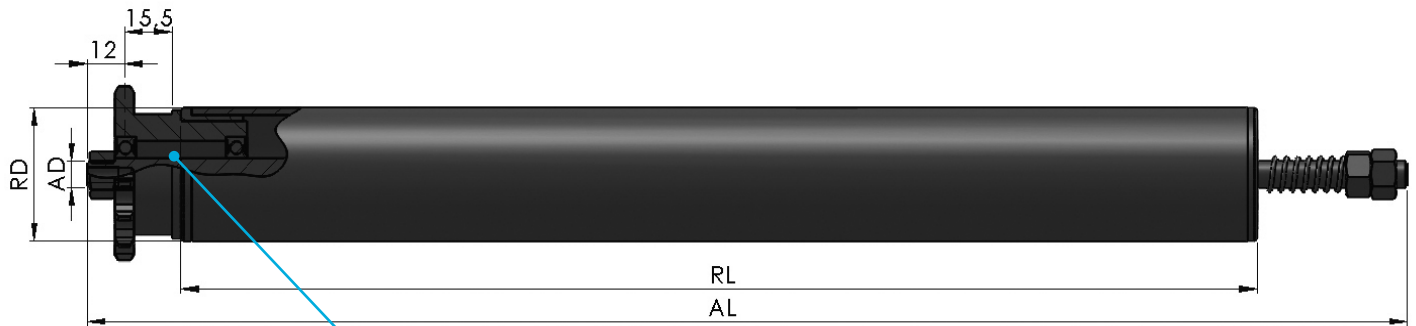

1K-ST-1/2-Z11-adjustable accumulating drive

Areas of use:

- for conveying lightweight to medium-weight products on a power-driven roller conveyor
- for dry and dust-free environments

counter-bearing:

- bearing type: TKL
- all suitable for operating in wet applications when using the RS bearing seal

Drive:

- single sprocket made of steel, lantern gear sprocket teeth
- sprocket size: 1/2" x 5/16", with 11 teeth
- the take-along force can be adjusted manually

Properties:

- temperature range: -5 to +50° C
- speed: 0.5 m/s
- load capacity: max. 60 kg/roller
(Depending on the load limit of tube, bearing and axle; refer to the general information)

Optional:

- available with various coatings
- antistatic
- stainless steel bearing, tube and axle
- for heated and cold storage applications
- with flanges

Combination

counter-bearing

TKL	tube-Ø	axle-Ø	ST	STI	STP	N	KB	KGH	ALU	STG
x	50 x 1.5	12	x	x	x	x			x	x
x	50 x 2	12	x	x	x	x				x
x	50 x 2.8	12					x	x		
x	60 x 2	12	x	x	x					x
x	60.3 x 1.65	12				x				x
x	63 x 3	12					x	x		

Axle type

counter-bearing	axle-Ø mm	EL=AL	 internal thread
TKL	12	RL +	59

 "The axle length and installation length change depending on the type of axle end finishing"

Order example

type	1K-ST-1/2-Z11-adjustable	TKL	50x2	STI	A12	IGM8	EL=559
rollers type							
type counter-bearing							
tube-Ø and wall thickness							
tube surface							
axle-Ø							
axle end finishing							
installation length							

power-driven carrier rollers // up to 350 kg

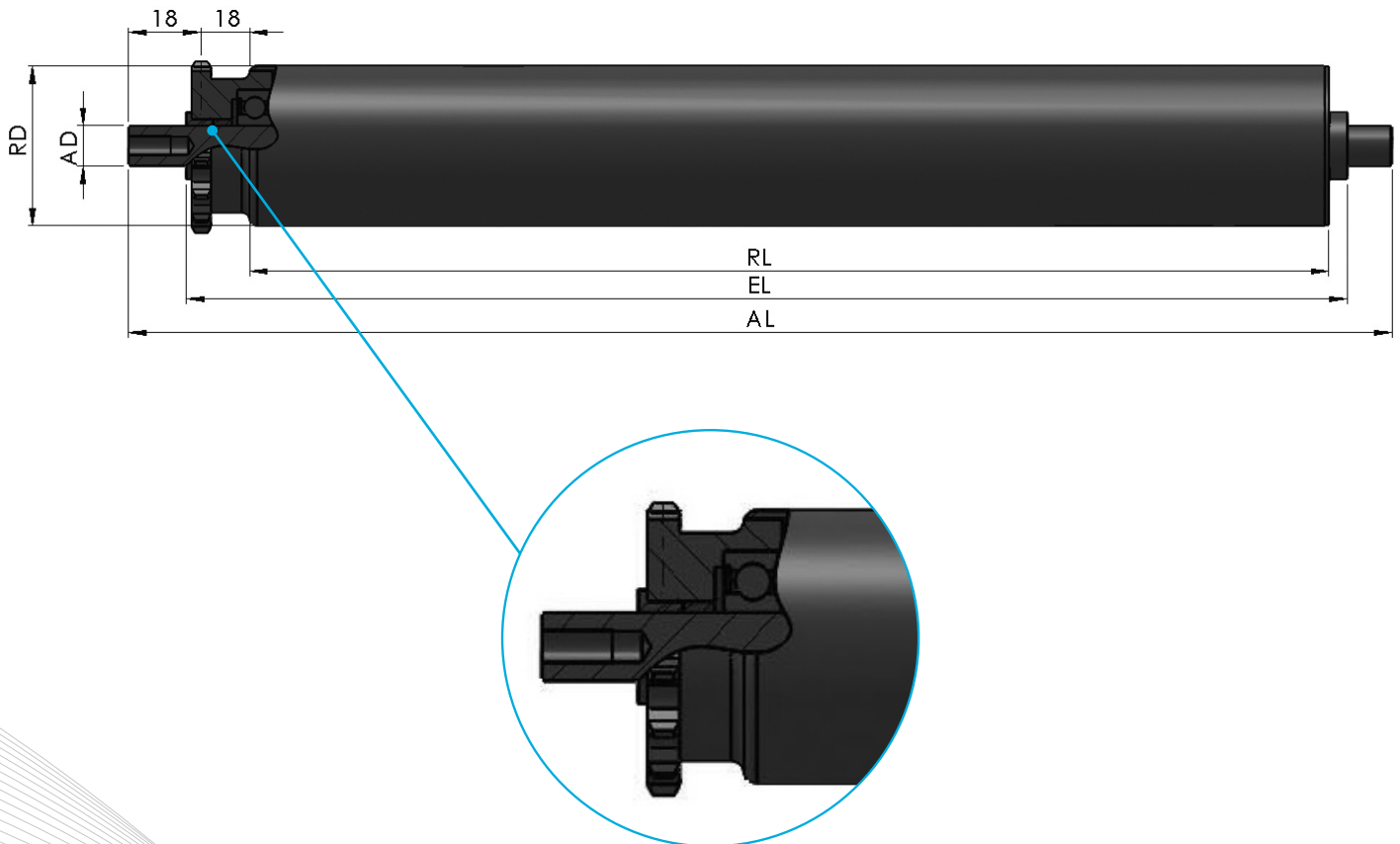

1K-ST-5/8-Z15

Areas of use:

- for conveying medium-weight to heavy products on a power-driven roller conveyor
- for dry and dust-free environments

counter-bearing:

- the type of bearing depends on the application: select between TRKS and TGF

Drive:

- single sprocket made of steel, welded to tube, lantern gear sprocket teeth
- sprocket size: 5/8" x 3/8", with 15 teeth

Properties:

- temperature range: -5 to +80° C
- speed: 0.5 m/s
- load capacity: max. 350 kg/roller
(Depending on the load limit of tube, bearing and axle; refer to the general information)

Optional:

- available with various coatings
- antistatic
- tube and axle made from stainless steel
- for heated and cold storage applications
- with flanges

Combination

counter-bearing		tube-Ø	axle-Ø	ST	STI	STP	STG
TGF	TRKS						
x	x	63.5 x 2.9	20	x	x		x
x	x	80 x 2	20 / 25	x	x	x	x
x	x	88.9 x 2.9	20 / 25	x	x	x	x
x	x	108 x 3.25	20 / 25	x	x	x	x
x		133 x 4	20 / 25	x	x		x

Axle type

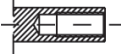
counter-bearing	axle-Ø mm	EL=		
			external thread	internal thread
TRKS	20	RL +	85	41
	25	RL +	87	41
TGF	20	RL +	85	41
	25	RL +	87	41



“The axle length and installation length change depending on the type of axle end finishing”

Order example

type	1K-ST-5/8 Z15	TGF	88.9x2.9	STI	A20	IGM12	EL=850	AL= x
rollers type								
type counter-bearing								
tube-Ø and wall thickness								
tube surface								
axle-Ø								
axle end finishing								
installation length								
axle length AL								

power-driven carrier rollers // up to 350 kg

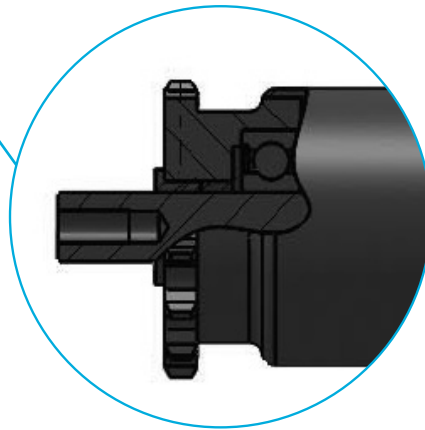
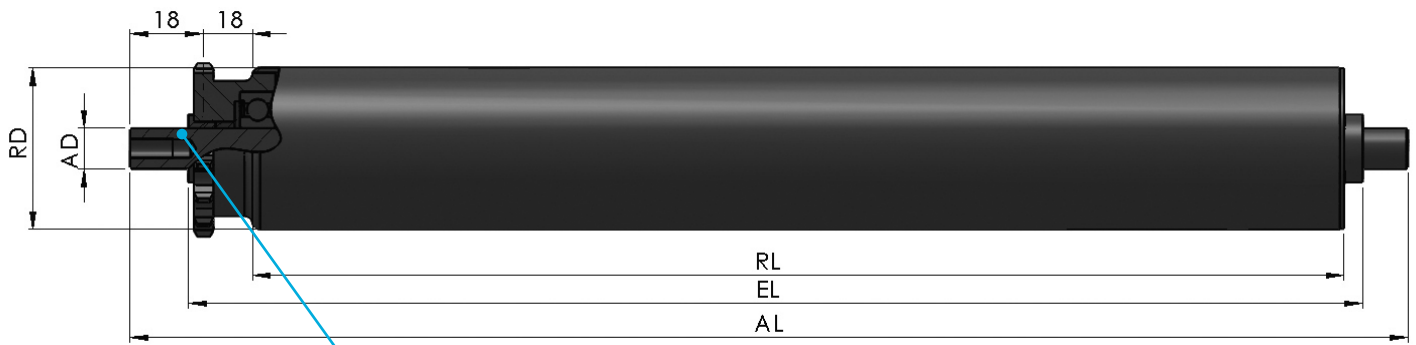

1K-ST-3/4-Z13

Areas of use:

- for conveying medium-weight to heavy products on a power-driven roller conveyor
- for dry and dust-free environments

counter-bearing:

- the type of bearing depends on the application: select between TRKS and TGF

Drive:

- single sprocket made of steel, welded to tube, lantern gear sprocket teeth
- sprocket size: 3/4" x 7/16", with 13 teeth

Properties:

- temperature range: -5 to +80° C
- speed: 0.5 m/s
- load capacity: max. 350 kg/roller
(Depending on the load limit of tube, bearing and axle; refer to the general information)

Optional:

- available with various coatings
- antistatic
- tube and axle made from stainless steel
- for heated and cold storage applications
- with flanges

Combination

counter-bearing		tube-Ø	axle-Ø	ST	STI	STP	STG
TGF	TRKS						
x	x	80 x 2	20 / 25	x	x	x	x
x	x	88.9 x 2.9	20 / 25	x	x	x	x
x	x	108 x 3.25	20 / 25	x	x	x	x
x		133 x 4	20 / 25	x	x		x

Axle type

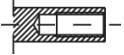
counter-bearing	axle-Ø mm	EL=	 external thread	 internal thread
TRKS	20	RL +	59	41
	25	RL +	61	41
TGF	20	RL +	59	41
	25	RL +	61	41



“The axle length and installation length change depending on the type of axle end finishing”

Order example

type	1K-ST-3/4 Z13	TGF	88.9x2.9	STI	A20	IGM12	EL=850	AL= x
rollers type								
type counter-bearing								
tube-Ø and wall thickness								
tube surface								
axle-Ø								
axle end finishing								
installation length								
axle length AL								