



- with digital display and radio control model TKI

The crane weigher can be operated by radio control. The displayed values can be taken off the remote control device and can be transferred to a PC. Several measured values can be totalled and saved. Various functions like piece counting, maximum weight (gross/net) can be realized.

Features

- TKI crane weigher has the same features like the model TKE.
- Remote control and data exchange via radio transmission.
- USB interface
- Accumulation memory

Options

- User software for data processing
- PC cable
- Lower hook

Scope of delivery

- Crane weigher with infrared remote control
- Remote control and data exchange via radio transmission.
- 8 x 1.5V AA batteries
- Carrying case
- Test certificate
- Upper and lower shackle

Crane weighers

Measuring range 0 - 9.5 t

The crane weighers TKE and TKI are compact measuring devices for the weighing of loads.

Due to the compact design and robust steel housing the crane weighers are suitable for a wide range of applications. The crane weighers have a liquid crystal display (LCD), which can tare as well as show either the gross or the net load.

Both models TKE and TKI are fitted with an infrared remote control with a range of 8m.

- with digital display model TKE

Features

- High accuracy: $\pm 0,03\%$ of the weighing range
- Lightweight design
- Easy-to-read display
- Easy to use
- Robust design
- Retains the peak value to memory.
- Operating time of about 40 hours (without radio frequency communication)
- Automatic setting to zero when load indicator is switched on.
- Display of maximum weight (gross/net).
- Display of measuring units on the load indicator.
- Measuring units g, kg, t and lbs.
- Automatic stand-by for a prolonged battery lifetime.

Option

- Lower hook

Scope of delivery

- Crane weigher with infrared remote control
- 4 x 1.5V AA batteries
- Carrying case
- Test certificate
- Upper and lower shackle

Technical data model TKE and model TKI

Model	TKE 1,5 TKI 1,5			TKE 6,0 TKI 6,0			TKE 9,5 TKI 9,5		
	EAN-No. model TKE 4053981**	**801995			**802008			**802015	
EAN-No. model TKI 4053981**	**841540			**856179			**841557		
Measuring range, t	0 - 1.5			0 - 6.0			0 - 9.5		
Breaking load, t	≥ 4.5			≥ 24.0			≥ 38.0		
Weight with lifting accessories, kg	6			10			15		
Resolution step, kg (partition)	up to 300 0.1	up to 600 0.2	up to 1500 0.5	up to 1500 0.5	up to 3000 1.0	up to 6000 2.0	up to 3000 1.0	up to 6000 2.0	up to 9500 5.0
Operation time, approx., h ¹	40								
Temperature range (operation)	-10 °C up to +40 °C								
Temperature range (storage)	-10 °C up to +40 °C								
Protection	IP40								
Display (LCD 25 mm high)	5 ½ digits								
Tare range	100 % of rated capacity								
Overload warning	The crane weigher switches off when exceeding the rated load.								

¹ with 4 x 1.5 V AA batteries (without radio frequency communication)

Dimensions model TKE and model TKI

Model	TKE 1,5 TKI 1,5	TKE 6,0 TKI 6,0	TKE 9,5 TKI 9,5
A, mm	193	226	246
B, mm	175	175	175
C, mm	49	59	80
D, mm	24	37	46
E, mm	44	58	74
F, mm	133	133	133
G, mm	104	104	104
H, mm	330	363	430
I, mm	153	170	180

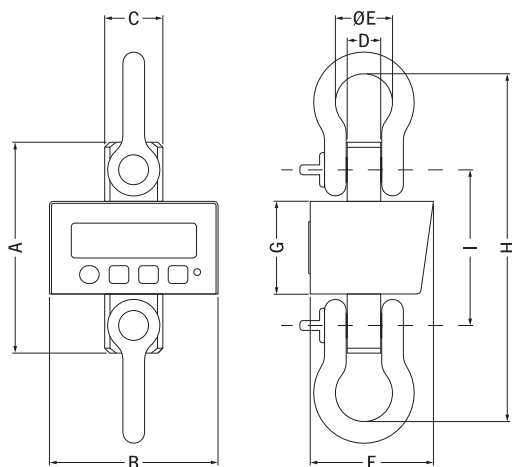



- with digital display and radio control model TKR

The crane weigher can be operated by radio control. The displayed values can be taken off the remote control device and can be transferred to a PC. The system can be combined with an easy-to-read display. Several measured values can be totalled and saved.

Features

- TKR crane weigher has the same features like the model TKL plus:
- Remote control and data exchange via radio transmission.
- USB interface
- Accumulation memory

Option

- External easy-to-read display.

Scope of delivery

- Crane weigher
- Remote control with display
- 7 x 1.5V AA batteries
- Carrying case
- Test certificate
- PC cable
- User software



Crane weighers

Measuring range 0 - 12 t

The crane weighers TKL and TKR are compact measuring devices for the weighing of loads. Use appropriate attachments like grade 8 forgings between the hook of the hoist or crane, the crane weigher and the load.

The crane weighers have a liquid crystal display (LCD), which can tare as well as show either the gross or the net load. It also indicates overload at 110% of the rated capacity and the status of the battery.

- with digital display model TKL

Features

- High accuracy
- Lightweight design
- Easy-to-read display
- Easy to use
- Robust design
- Housing can be rotated 180°
- Retains the peak value to memory.
- The battery capacity provides for around 200 operating hours.
- Automatic setting to zero when load indicator is switched on.
- Use of rechargeable batteries possible (external battery charger*).
- Display of maximum weight (gross/net).
- Display of measuring units on the load indicator.
- Measuring units kg, t, lbs, to, kN.
- Automatic stand-by for a prolonged battery lifetime.
- Simple change of batteries
- Warning if batteries are low
- Overload warning

Scope of delivery

- Crane weigher
- 4 x 1.5V AA batteries
- Carrying case
- Test certificate

* not part of the delivery package.

Technical data model TKL and model TKR

Model	TKL 1,0 TKR 1,0	TKL 2,0 TKR 2,0	TKL 3,2 TKR 3,2	TKL 5,0 TKR 5,0	TKL 8,0 TKR 8,0	TKL 12,0 TKR 12,0
EAN-No. model TKL 4025092*	*382878	*382922	*382984	*383059	*383073	*383097
EAN-No. model TKR 4025092*	*382915	*382946	*382779	*383066	*383080	*383103
Measuring range, t	0 - 1.0	0 - 2.0	0 - 3.2	0 - 5.0	0 - 8.0	0 - 12.0
Nominal load, t	1.0	2.0	3.2	5.0	8.0	12.0
Limit load, t	1.1	2.2	3.5	5.5	8.8	13.2
Breaking load, t	≥4.0	≥8.0	≥13.0	≥20.0	≥32.0	≥48.0
Weight without lifting accessories, kg	1.85	1.99	2.5	2.7	3.6	3.9
Weight with lifting accessories, kg	3.0	3.5	6.0	7.5	10.5	20.0
Accuracy of the end value	0.1%	0.1%	0.1%	0.1%	0.1%	0.1%
Resolution step, kg (partition)	0.5	1.0	1.0	1.0	2.0	5.0
Operation time, approx., h ¹	200					
Temperature range (operation)	-10 °C up to +50 °C					
Temperature range (storage)	-20 °C up to +70 °C					
Protection	IP 54					
Display (LCD 20.5 mm high)	4 ½ digits					
Tare range	100% of rated capacity					
Overload warning	Overload warning at 110% of the rated capacity					

¹ with 4x1.5V AA batteries

Dimensions model TKL and model TKR

Model	TKL 1,0 TKR 1,0	TKL 2,0 TKR 2,0	TKL 3,2 TKR 3,2	TKL 5,0 TKR 5,0	TKL 8,0 TKR 8,0	TKL 12,0 TKR 12,0
A, mm	389	417	488	571	657	804
B, mm	356	379	441	514	588	709
C, mm	60	60	75	90	100	140
D, mm	110	110	135	160	180	260
E, mm	13	16	18	22	26	35
F, mm	20	25	32	40	49	45
G, mm	70	81	103	126	152	190
H, mm	128	136	140	148	158	176
J, mm	77.4	77.4	84.4	84.4	97.4	97.4

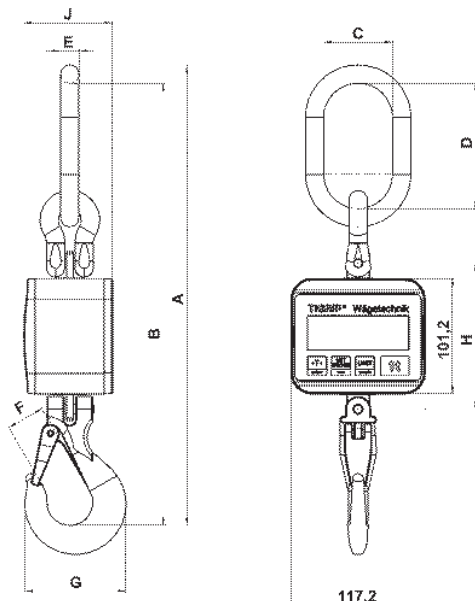



- with digital display and radio control model TZR

The load indicator can be operated via radio control. The displayed values can be taken off the remote control device and can be transmitted to a PC. The system can be combined with an easy-to-read display. Several measured values can be totalled and saved.

Features

- TZR load indicator has the same features like the model TZL plus:
- Remote control and data exchange via radio transmission.
- USB interface
- Accumulation memory

Option

- External easy-to-read display.

Scope of delivery

- Load indicator
- Remote control with display
- 7 x 1.5V AA batteries
- Carrying case
- Test certificate
- Without shackles and hooks
- PC cable
- User software



Load indicator

Measuring range 0 - 100t

The Tigrip® load indicator is a mechanical measuring instrument with electronic display. On account of its flexibility the Tigrip® load indicator has universal applications. Whether used as a conventional crane weigher or to measure forces, it is the economical choice for various applications. It can be used in conjunction with shackles and hooks.

The load indicator is provided with liquid crystal display (LCD), which can tare as well as show either the gross or the net load. It also indicates overload at 110% of the rated capacity and the status of the battery.

- with digital display model TZL

Features

- High accuracy
- Lightweight design
- Easy-to-read display
- Easy to use
- Robust design
- Retains the peak value to memory.
- The battery capacity provides for around 200 operating hours.
- Automatic setting to zero when load indicator is switched on.
- Use of rechargeable batteries possible (external battery charger*).
- Display of maximum weight (gross/net).
- Display of measuring units on the load indicator.
- Measuring units kg, t, lbs, to, kN.
- Automatic stand-by for a prolonged battery lifetime.
- Simple change of batteries
- Warning if batteries are low.
- Overload warning

Scope of delivery

- Load indicator
- 4 x 1.5V AA batteries
- Carrying case
- Test certificate
- Without shackles and hooks

* not part of the delivery package.

Technical data model TZL and model TZR

Model	TZL 1,0 TZR 1,0	TZL 2,5 TZR 2,5	TZL 5,0 TZR 5,0	TZL 10,0 TZR 10,0	TZL 20,0 TZR 20,0	- TZR 35,0	- TZR 50,0	- TZR 100,0
EAN-No. model TZL 4025092*	*262217	*262224	*262231	*256995	*262347	-	-	-
EAN-No. model TZL shackles 4025092*	*453509	*453653	*453660	*453714	*453714	-	-	-
EAN-No. model TZL hooks 4025092*	*270342	*557665	*557689	*551311	*551007	-	-	-
EAN-No. model TZR 4025092*	*262798	*266222	*272964	*257008	*272971	*455176	*455183	*455206
EAN-No. model TZR shackles 4025092*	*453509	*453653	*453660	*453714	*453714	*453738	*453745	*456746
EAN-No. model TZR hooks 4025092*	*270342	*557665	*557689	*551311	*551007	*552226	*555050	*558785
Measuring range, t	0 - 1.0	0 - 2.5	0 - 5.0	0 - 10.0	0 - 20.0	0 - 35.0	0 - 50.0	0 - 100.0
Nominal load, t	1.0	2.5	5.0	10.0	20.0	35.0	50.0	100.0
Limit load, t	1.1	2.75	5.5	11	22	38.5	55	110
Breaking load, t	≥4	≥10	≥20	≥40	≥80	≥140	≥200	≥400
Weight without lifting accessories, kg	1.1	1.7	2.1	3.9	6.8	9.4	14.4	39.3
Accuracy of the end value	0.2%	0.2%	0.2%	0.2%	0.2%	0.2%	0.2%	0.2%
Resolution step, kg (partition)	1	1	1	10	10	10	10	50
Operation time, approx., h ¹	200							
Temperature range (operation)	-10 °C up to +50 °C							
Temperature range (storage)	-20 °C up to +70 °C							
Protection	IP 54							
Display (LCD 20.5 mm high)	4 ½ digits							
Tare range	100% of rated capacity							
Overload warning	Overload warning at 110% of the rated capacity							

¹ with 4x 1.5V AA batteries

Dimensions model TZL and model TZR

Model	TZL 1,0 TZR 1,0	TZL 2,5 TZR 2,5	TZL 5,0 TZR 5,0	TZL 10,0 TZR 10,0	TZL 20,0 TZR 20,0	- TZR 35,0	- TZR 50,0	- TZR 100,0
A, mm	190	233	250	325	378	405	450	640
B, mm	118	118	118	118	141	156	180	260
C, mm	14	22	27	48	55	66	76	100
D, mm	151	173	180	213	233	245	264	380
E, mm	12.5	19	21.5	22	32	47	55	80
F, mm	37	-	-	-	-	-	-	-
G, mm	21	25	30.5	47	57	67	77	99
H, mm	38.4	42.2	45.1	64.4	74.2	84.2	94.2	113
J, mm	348	604	610	690	780	1000	1170	-
K, mm	30	34	50	105	92	130	140	300
L, mm	26	38	44	95	95	114	132	238
M, mm	10	16	19	35	35	44	51	89
N, mm	25	25	32	50	70	110	115	-
O, mm	23	23	37	63	80	123	132	-
P, mm	17	17	28	44	57	90	97	-
Q, mm	235	309	315	535	562	665	730	1240
R, mm	16	-	-	-	-	-	-	-

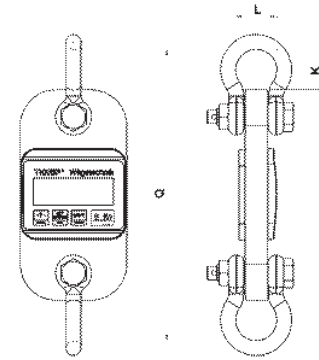

Load indicator model TZL/TZR with shackle

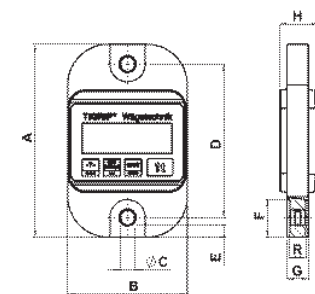

Load indicator model TZL/TZR 1.0t

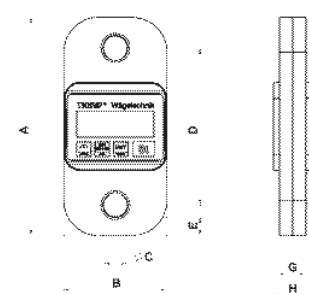

Load indicator model TZL/TZR 2.5 up to 100.0t

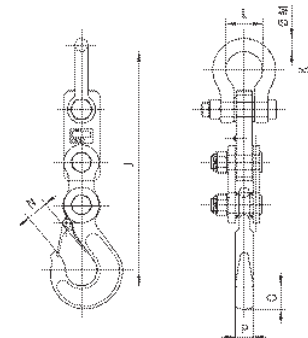

Load indicator model TZL/TZR with hook