

VERTICAL TRANSPORT OF PLATES: UNIVERSAL

IPU10



Model IPU10

Universal vertical safety lifting clamp IPU10 is suitable for the lifting, turning (**180°**) and vertical transfer of steel plates and constructions. The IPU10 lifting clamp is fitted with a locking device for both open and closed positions, which ensures complete safety. Fitted with a hinged hoisting eye moving in **all directions so as to enable the user to place and lift the load from any direction.** The IPU10 lifting clamps with a WLL of 12 tonnes and up are fitted with special hook-up facilities to enable easy placement of the clamp in horizontal position.



Model IPU10

For correct use of the clamp, please consult fig. 2 and 3. For special applications see also pages 6, 7, 8 and 9. Higher WLL and different jaw-apertures upon request.

Minimum load permitted:

- 5% of the WLL applying to plate surface hardness 27 Rc (900 N/mm²),
- 10% of the WLL applying to plate surface hardness 37 Rc (1170 N/mm²).

Before using the clamp always read the instruction manual supplied with the clamp.

Model	Order No.	WLL per pce in t.	Jaw		Dimensions in mm								Weight per pce kg
			A	B	C	D	E	F	G	H	J	K	
0,5-IPU10	1675	0,5	0-16	44	128	228	30	115	41	28	-	10	1,9
1 -IPU10	1663	1,0	0-20	45	139	222	30	126	41	38	-	10	2,1
2 -IPU10	1677	2,0	0-35	78	201	372	70	190	61	55	-	16	7,6
3 -IPU10	1665	3,0	0-40	100	253	445	75	225	78	60	-	20	14,8
4,5-IPU10	1667	4,5	0-40	100	253	445	75	232	82	65	-	20	16,0
6 -IPU10	1669	6,0	0-50	126	302	525	80	292	84	95	44	20	24,0
6 -IPU10/J	2469	6,0	50-100	126	302	525	80	342	84	95	44	20	30,5
9 -IPU10	1671	9,0	0-50	126	325	557	80	310	92	105	44	20	29,5
9 -IPU10/J	1673	9,0	50-100	126	325	562	80	360	92	105	44	20	30,5
12 -IPU10	1679	12,0	0-54	160	391	623	80	331	117	137	41	25	57,0
12 -IPU10/J	1681	12,0	54-108	178	439	673	80	415	117	137	41	25	59,0
16 -IPU10	1683	16,0	5-64	178	465	734	88	397	119	153	45	25	72,0
16 -IPU10/J	1685	16,0	64-128	208	521	790	88	472	119	161	45	25	85,0
22,5-IPU10	1687	22,5	5-80	222	554	855	110	470	136	186	49	25	127,0
22,5-IPU10/J	1689	22,5	80-155	253	628	930	110	575	136	196	49	25	130,0
30 -IPU10	1691	30,0	5-80	222	545	860	110	470	152	186	54	30	153,0
30 -IPU10/J	1693	30,0	80-155	250	620	935	110	565	152	196	54	30	165,0

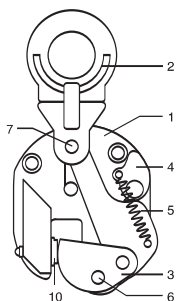
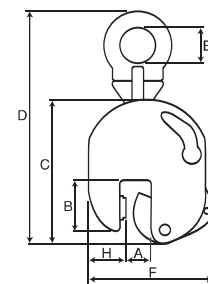

Spare parts for IPU10 safety lifting clamps:

- | | |
|--------------------------------|------|
| 1. body complete | 1041 |
| 2. hoisting eye complete | 1235 |
| 3. camsegment complete | 1234 |
| 4. latch complete | 1233 |
| 5. spring for latch complete | 1063 |
| 6. camsegment shaft complete | 1046 |
| 7. hoisting eye shaft complete | 1047 |
| 10. pivot complete (round) | 0098 |

3, 5 and 10 are included in maintenance set till 6 tonnes

3, 4, 5, 6, 7 and 10 are included in revision set till 6 tonnes

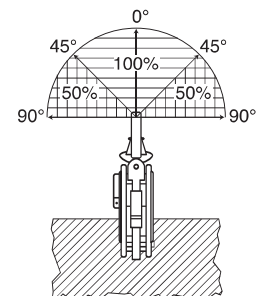
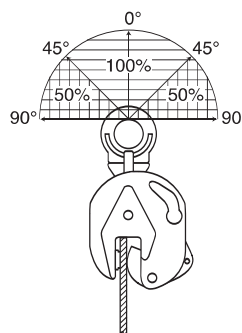

innovative

VERTICAL TRANSPORT OF PLATES: STAINLESS STEEL

IP(U)10/S



Model IPU10/S

IP10/S and IPU10/S vertical safety lifting clamps are suitable for the lifting, turning (**180°**) and transfer in vertical position of **stainless steel** plates, beams and sections. These lifting clamps are fitted with a camsegment and a pivot **made of stainless steel so as to avoid contact corrosion**.

Available in two versions:

1. **IPU10/S:** fitted with a hinged hoisting eye moving in all directions so as to enable the user to place and lift the load from any direction. Further specifications: see model IPU10. For a correct use of the clamp, see fig. 2 & 3.
2. **IP10/S:** fitted with a fixed hoisting eye. Further specifications: see model IP10. For a correct use of the clamp, see fig. 4 & 5.

Higher WLL and different jaw-apertures upon demand.

Minimum load permitted:

- 5% of the WLL applying to plate surface hardness 27 Rc (900 N/mm²),
- 10% of the WLL applying to plate surface hardness 37 Rc (1170 N/mm²).

Before using the clamp always read the instruction manual supplied with the clamp.

Model	Order No.	WLL per pce in t.	Jaw		Dimensions in mm								Weight per pce kg
			A	B	C	D	E	F	G	H	J	K	
With universal hoisting eye													
0,5-IPU10/S	2275	0,5	0-16	44	128	228	30	115	41	28	-	10	1,9
1 -IPU10/S	2263	1,0	0-20	45	139	222	30	126	41	38	-	10	2,1
2 -IPU10/S	2277	2,0	0-35	78	201	372	70	190	61	55	-	16	7,6
3 -IPU10/S	2265	3,0	0-40	100	253	445	75	225	78	60	-	20	14,8
4,5-IPU10/S	2267	4,5	0-40	100	253	445	75	232	82	65	-	20	16,0
With fixed hoisting eye													
0,5-IP10/S	2274	0,5	0-16	44	128	207	30	115	41	28	-	10	1,8
1 -IP10/S	2262	1,0	0-20	45	139	215	30	126	41	38	-	10	2,0
2 -IP10/S	2276	2,0	0-35	78	201	336	70	190	61	55	-	16	6,8
3 -IP10/S	2264	3,0	0-40	100	253	436	75	225	78	60	-	20	13,8
4,5-IP10/S	2266	4,5	0-40	100	253	436	75	232	82	65	-	20	15,0

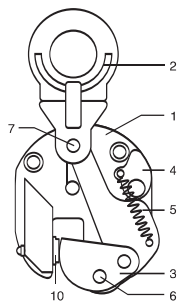
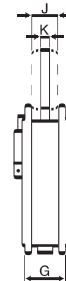
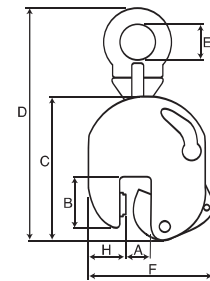

Spare parts for IP(U)10/S safety lifting clamps:

- | | |
|--------------------------------|------|
| 1. body complete | 1041 |
| 2. hoisting eye complete | 1235 |
| 3. camsegment complete | 1234 |
| 4. latch complete | 1233 |
| 5. spring for latch complete | 1063 |
| 6. camsegment shaft complete | 1046 |
| 7. hoisting eye shaft complete | 1047 |
| 10. pivot complete (round) | 0098 |
| 10. pivot complete (oval) | 0099 |

Order no.

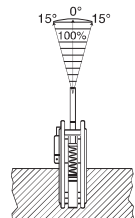
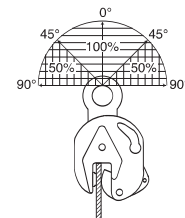
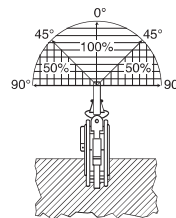
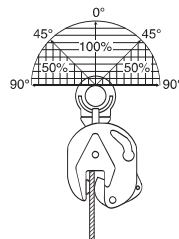

VERTICAL TRANSPORT OF PLATES: AUTOMATICALLY LOCKING

IPU10/A



Model IPU10/A

The IPU10/A **automatically clicks** on to the material as soon as the clamp is placed on the plate. The fact that the safety lock remains in position as the clamp closes precludes hazardous situations.

Fastening the IPU10/A clamp in places that are difficult to reach is no problem.

For correct use of the clamp, please consult fig. 2 and 3.

Minimum load permitted:

5% of the WLL applying to plate surface hardness 27 Rc (900 N/mm²),

10% of the WLL applying to plate surface hardness 37 Rc (1170 N/mm²).

Before using the clamp always read the instruction manual supplied with the clamp.

Model	Order No.	WLL per pce in t.	Jaw	Dimensions in mm									Weight per pce kg
				A	B	C	D	E	F	G	H	J	
1-IPU10/A	1628	1,0	0-20	45	138	238	30	128	41	37	-	10	2,3
2-IPU10/A	1629	2,0	0-35	78	201	378	70	200	61	72	-	16	8,9

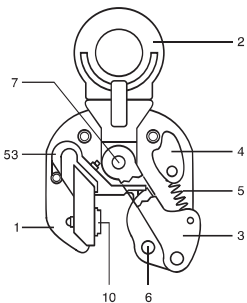
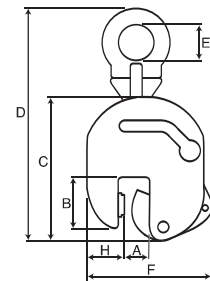

Spare parts for IPU10/A safety lifting clamps:

- | | |
|--------------------------------|------|
| 1. body complete | 1041 |
| 2. hoisting eye complete | 1235 |
| 3. camsegment complete | 1234 |
| 4. latch complete | 1233 |
| 5. spring for latch complete | 1063 |
| 6. camsegment shaft complete | 1046 |
| 7. hoisting eye shaft complete | 1047 |
| 10. pivot complete (round) | 0098 |
| 53. locking device complete | 1812 |

Order no.

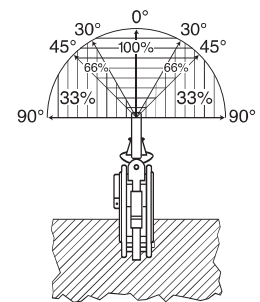
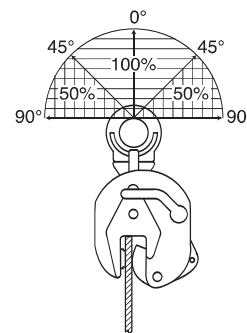

VERTICAL TRANSPORT OF PLATES: SMALL PROFILES

IPV(U)Z



Model IPVUZ

Vertical safety lifting clamp IPV(U)Z is specially designed for the transfer of small profiles. The IPV(U)Z lifting clamp is fitted with a locking device for both open and closed positions, which ensures complete safety.

Available in two versions:

1. Type **IPVUZ**: with universal hoisting eye. For correct use of the clamp, please consult fig. 2 & 3.
2. Type **IPVZ**: with fixed hoisting eye. For correct use of the clamp, please consult fig. 4 & 5.



Model IPVZ

Higher WLL and different jaw-apertures upon request.

Minimum load permitted:

- 5% of the WLL applying to plate surface hardness 27 Rc (900 N/mm²),
- 10% of the WLL applying to plate surface hardness 37 Rc (1170 N/mm²).

Before using the clamp always read the instruction manual supplied with the clamp.

Model	Order No.	WLL per pce in t.	Jaw		Dimensions in mm								Weight per pce kg
			A	B	C	D	E	F	G	H	J	K	
With universal hoisting eye													
0,75-IPVUZ	5146	0,75	0-15	26	128	228	30	115	41	30	-	10	2,2
1,5 -IPVUZ	5147	1,5	0-20	60	200	376	70	180	52	50	-	16	7,5
With fixed hoisting eye													
0,75-IPVZ	5096	0,75	0-15	26	128	207	30	115	41	30	-	10	2,1
1,5 -IPVZ	5097	1,5	0-20	60	200	339	70	180	52	50	-	16	6,2

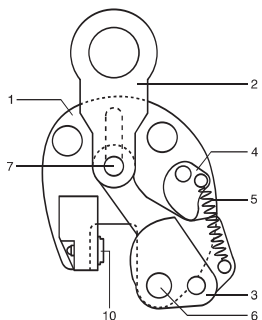
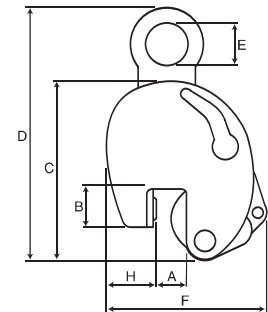

Spare parts for IPV(U)Z safety lifting clamps:

- | | |
|--------------------------------|------|
| 1. body complete | 1041 |
| 2. hoisting eye complete | 1235 |
| 3. camsegment complete | 1234 |
| 4. latch complete | 1233 |
| 5. spring for latch complete | 1063 |
| 6. camsegment shaft complete | 1046 |
| 7. hoisting eye shaft complete | 1047 |
| 10. pivot complete | 0098 |

