

# Lifting tables

Lifting and loading power  
by Pfaff-silberblau



# Lifting tables: As individual as your needs.

**Columbus McKinnon – Pfaff-silberblau have developed lifting tables with one objective:** They want to contribute to efficient, seamless work flows in your company. In industry and plant construction, construction industry and loading technology, the lifting tables complete present production and logistics chains. We at Columbus McKinnon know that different loading and mounting situations require individual lifting table solutions.

The brand Pfaff-silberblau has been successful for more than 140 years because the company has innovative power.

They all share this: They offer a true competitive benefit in terms of working power, ergonomics, operating safety and energy efficiency.

Our all-round package of services corresponds to our partnership-aligned thinking. In addition to high-performance products, we will support you with continuous services such as investment consulting and reliable maintenance.

The pleasant result for you and your lifting table is a long product life cycle and quick return-on-investment.



**Service:** We offer professional support on site on request.

**Reviews/maintenance according to BetrSV §10:** Our trained and qualified service staff will take care of professional and technical installation. We document this in a test log and based on a CE declaration of conformity. We ensure availability in the scope of a maintenance contract and schedule an appointment with you in time before due inspection.

Just call us: +49 8233 2121 777 or email: [service.kissing@cmco.eu](mailto:service.kissing@cmco.eu)

**All of our products meet the following prerequisites:**

- All lifting tables correspond to the DIN EN 1570-1, or EC – machinery directive 2006/42/EC
- Operating voltage 400 V – 50 Hz
- Ambient temperature indoor area 0° C to +40° C
- Maintenance supports, surrounding contact strip, line break protection, lowering brake valve

Series					
	HTF	HTH	HTS	HTA	HTV
Catalog side	5	6	7	8	9
<b>Handling area</b>	•	•	•	-	-
▪ Lifting table for mounting, packaging and maintenance work	•	•	•	-	-
▪ Ergonomic workplaces	•	•	•	-	-
▪ Height-adjustable platform	•	•	•	-	-
<b>System and industrial applications</b>	-	-	-	•	-
▪ Lifting table as PLC-controlled means of production	-	-	-	•	-
▪ Individual adjustment to production processes	-	-	-	•	-
▪ Suitable for customer-specific attachments	-	-	-	•	-
<b>Loading area</b>	-	-	-	-	•
Lifting table for the logistics industry	-	-	-	-	•
▪ Roust build	-	-	-	-	•
▪ Loading work in warehouse and carrier	-	-	-	-	•
▪ Optional adjustment for taking along passengers	-	-	-	-	•
Use indoors - hall operation	•	•	•	•	•
Use outdoors - optional adjustment	-	-	•	•	•
Lifting table with available accessories	-	-	•	•	•

# Lifting table

## Product overview

Page

5

### Flat scissor lifting table HTF

- Carrying load 1000 kg
- Lifting height 760 mm
- Platform closed or U-shape



6

### Handling lifting table HTH

- Carrying load 500 to 3000 kg
- Lifting height up to 820 mm
- Flexible control pendant



7

### Standard lifting table HTS

- Carrying load 500 to 2000 kg
- Lifting height from 590 to 1200 mm
- Individually expansible by options



8

### Industrial plant lifting table HTA

- Carrying load 1000 to 5000 kg
- Lifting height from 800 to 1600 mm
- Customer-specific special solutions



9

### Loading process lifting table HTV

- Carrying load 2000 to 6000 kg
- Lifting height from 1300 to 1600 mm
- Special design also for accompanying persons on the platform

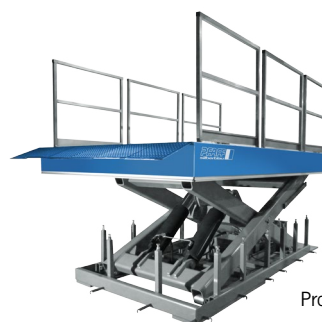

Product image shows options

# Flat scissor lifting table HTF

## Special features

- Carrying load 1000 kg
- Lifting height 760 mm
- Low height
- Shearing in lifting table for evenly distributed loads
- Smooth steel sheet platform or alternatively U-shape
- Use on industrial ground, without pitch installation
- External hydraulic unit with operation

## Technical Data

Model	Carrying load kg	Lifting height (H) mm	Design	Platform (L x B) mm	Platform (B2) mm	Height (C) mm	Lifting time sec.	Motor output kW	Weight approx. kg
HTF 10 - 760 G	1000	760	G-form	1450 x 1140	-	82	18.0	0.75	250
HTF 10 - 760 U	1000	760	U-form	1450 x 1140	585	80	18.0	0.75	235

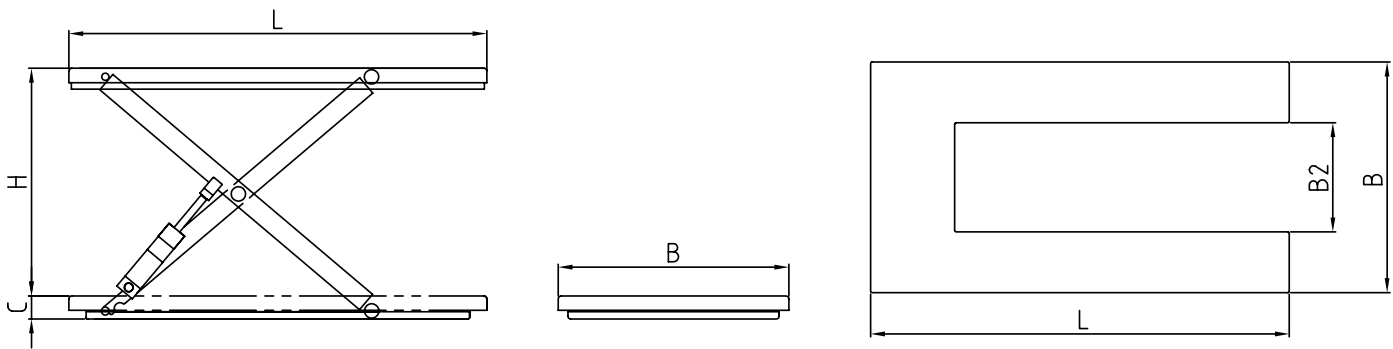



# Handling lifting table HTH

## Special features

- Carrying loads 500 – 3000 kg
- Lifting heights up to 820 mm
- Shearing in construction for evenly distributed loads
- Smooth steel sheet platform
- Control between the shears – operation by suspended button

## Technical Data

Model	Carrying load kg	Lifting height (H) mm	Platform (L x B) mm	Height (C) mm	Lifting time sec.	Motor output kW	Weight approx. kg
HTH 5 - 820	500	820	1300 x 800	190	15.0	0.75	160
HTH 10 - 820	1000	820	1300 x 800	190	25.0	0.75	220
HTH 20 - 820	2000	820	1300 x 800	190	40.0	0.75	280
HTH 30 - 800	3000	800	1300 x 800	220	26.0	1.5	320

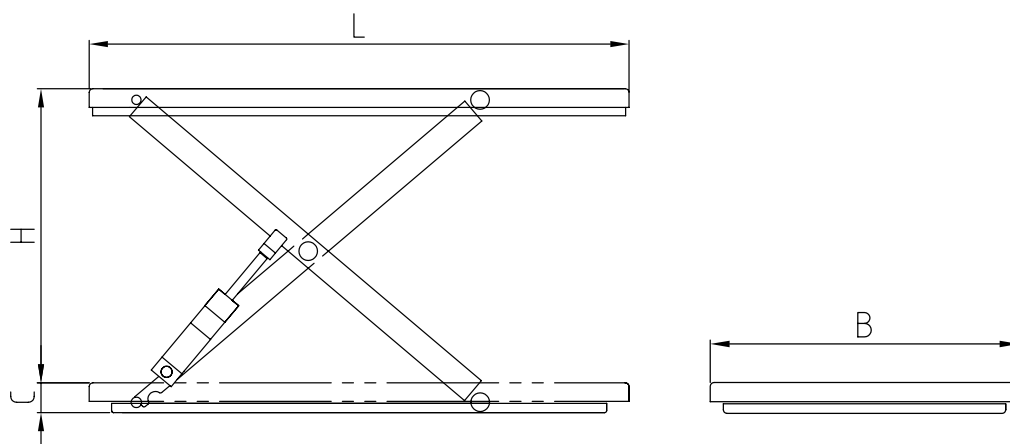

# Standard lifting table

## HTS

### Special features

- Carrying loads 500 – 2000 kg
- Lifting heights 590 – 1200 mm
- Shearing in construction for evenly distributed loads
- Smooth steel sheet platform with maintenance hatch
- Platform change possible
- Control between the shears – operation by suspended button
- Options – according to accessories list

### Technical Data

Model	Carrying load kg	Lifting height (H) mm	Platform (L x B) (min.) mm (max.) mm		Height (C) mm	Lifting time sec.	Motor output kW	Weight approx. kg
HTS 5 - 590	500	590	1000 x 600	1100 x 1000	200	10.0	0.55	135
HTS 5 - 800	500	800	1250 x 600	1450 x 1200	200	13.0	0.55	180
HTS 5 - 1000	500	1000	1500 x 600	1700 x 1200	220	20.0	0.55	200
HTS 5 - 1200	500	1200	1800 x 600	2000 x 1200	240	22.0	0.75	230
HTS 10 - 590	1000	590	1000 x 700	1100 x 1000	200	20.0	0.55	155
HTS 10 - 800	1000	800	1250 x 700	1450 x 1400	200	26.0	0.55	188
HTS 10 - 1000	1000	1000	1500 x 700	1700 x 1400	220	40.0	0.55	215
HTS 10 - 1200	1000	1200	1800 x 700	2000 x 1400	270	24.0	1.1	365
HTS 15 - 800	1500	800	1350 x 700	1400 x 1200	250	32.0	0.75	335
HTS 15 - 950	1500	950	1500 x 700	1650 x 1200	260	36.0	0.75	355
HTS 15 - 1200	1500	1200	1800 x 700	2000 x 1200	270	24.0	1.1	365
HTS 20 - 800	2000	800	1350 x 700	1400 x 1200	250	24.0	1.1	335
HTS 20 - 950	2000	950	1500 x 700	1650 x 1200	260	27.0	1.1	360
HTS 20 - 1200	2000	1200	1800 x 700	2000 x 1200	270	37.0	1.1	385

Platform width less than 800 mm with external unit possible  
 Further options, e.g. higher lifting loads, different platform sizes on request

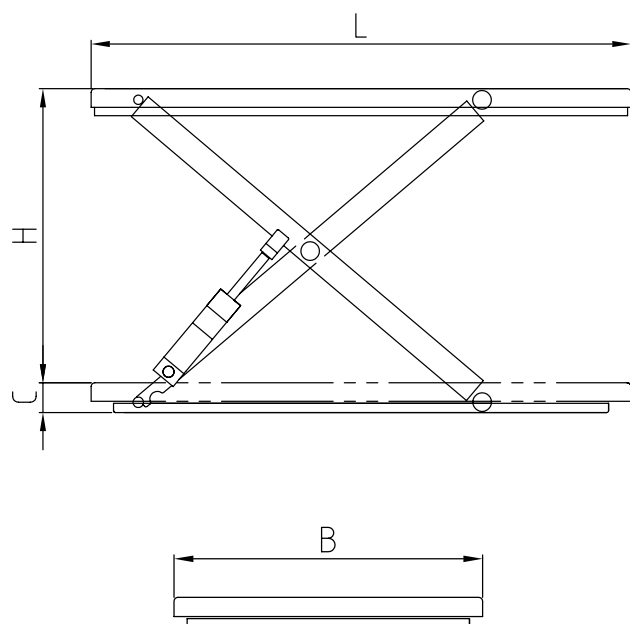

# Industrial plant lifting table HTA

## Special features

- Carrying loads 1000 - 5000 kg
- Lifting heights 800 – 1600 mm
- Individual customer solutions
- Smooth steel sheet platform with maintenance hatch
- Higher cycle times possible
- With upper, adjustable limit switch
- Comprehensive accessories range

## Technical Data

Model	Carrying load kg	Lifting height (H) mm	Platform (L x B) (min.) mm (max.) mm		Height (C) mm	Lifting time sec.	Motor output kW	Weight approx. kg
HTA 10 - 800	1000	800	1350 x 800	1500 x 1000	250	15.0	1.5	310
HTA 10 - 1000	1000	1000	1500 x 800	2000 x 1000	250	15.0	1.5	375
HTA 10 - 1300	1000	1300	2000 x 800	2500 x 1000	250	15.0	1.5	410
HTA 10 - 1600	1000	1600	2000 x 1000	3000 x 2000	250	35.0	1.5	510
HTA 20 - 800	2000	800	1350 x 1000	1500 x 1500	250	28.0	1.5	355
HTA 20 - 1000	2000	1000	1500 x 1000	2000 x 1500	250	30.0	1.5	420
HTA 20 - 1300	2000	1300	2000 x 1000	2700 x 2000	250	45.0	1.5	485
HTA 20 - 1600	2000	1600	2250 x 1000	3000 x 2400	300	38.0	2.2	575
HTA 30 - 800	3000	800	1350 x 1000	1500 x 1500	250	25.0	2.2	380
HTA 30 - 1100	3000	1100	1800 x 1000	2000 x 1500	300	30.0	2.2	565
HTA 30 - 1300	3000	1300	2000 x 1000	2500 x 2000	300	28.0	3	645
HTA 30 - 1600	3000	1600	2250 x 1000	3000 x 2400	300	35.0	3	685
HTA 40 - 1300	4000	1300	2000 x 1000	2500 x 1600	300	35.0	3	750
HTA 40 - 1600	4000	1600	2250 x 1000	3000 x 1600	320	48.0	3	850
HTA 50 - 1300	5000	1300	2200 x 1200	2700 x 2200	370	22.0	5.5	980
HTA 50 - 1600	5000	1600	2500 x 1200	3200 x 2500	370	28.0	5.5	1045

Further options, e.g. higher lifting loads, different platform sizes on request

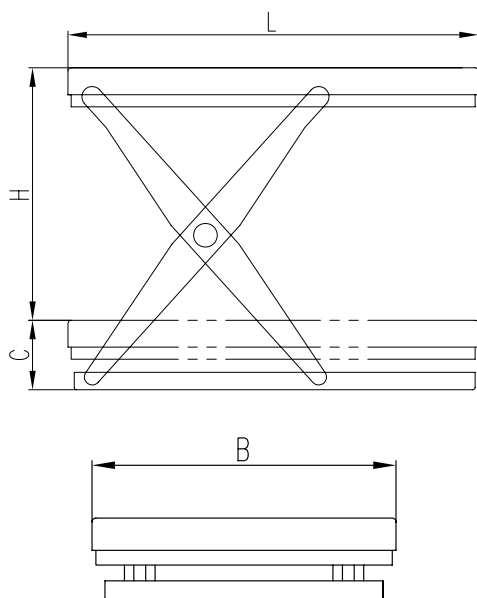



# Loading process lifting table

## HTV

### Special features

- Carrying loads 2000 – 6000 kg
- Lifting heights 1300 – 1600 mm
- Shearing in construction for evenly distributed loads
- Overrun capacity by reinforced platform (5 t -wheel and 10 t -axle load)
- Platform of bulb plate with maintenance hatch
- Self-supporting basic frame
- Control in separate control cabinet including operating elements
- With upper, adjustable limit switch
- Individual adjustment for use outdoors
- Diverse accessories range

### Technical Data

Model	Carrying load kg	Lifting height (H) mm	Platform (L x B) (min.) mm (max.) mm		Height (C) mm	Lifting time sec.	Motor output kW	Weight approx. kg
HTV 20-1300	2000	1300	2100 x 1400	2500 x 2000	370	35	3	1090
HTV 20-1450	2000	1450	2200 x 1400	2600 x 2400	350	40	3	1150
HTV 20-1600	2000	1600	2400 x 1400	3000 x 2400	350	50	3	1350
HTV 30-1300	3000	1300	2500 x 1500	2500 x 2000	370	35	3	1095
HTV 30-1450	3000	1450	2200 x 1400	2600 x 2400	350	40	3	1160
HTV 30-1600	3000	1600	2400 x 1400	3000 x 2400	350	50	3	1360
HTV 40-1300	4000	1300	2300 x 1400	2500 x 2000	400	25	5.5	1300
HTV 40-1600	4000	1600	2500 x 1400	3000 x 2400	400	35	5.5	1480
HTV 50-1300	5000	1300	2300 x 1400	2500 x 2000	400	25	5.5	1330
HTV 50-1600	5000	1600	2500 x 1400	3000 x 2400	400	35	5.5	1490
HTV 60-1600	6000	1600	2500 x 1400	3000 x 2000	450	40	5.5	1600



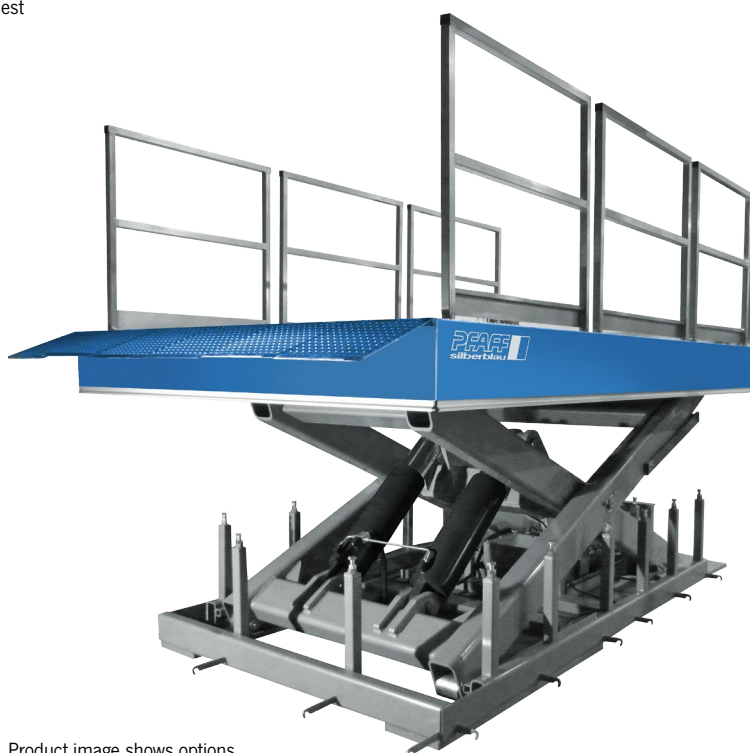
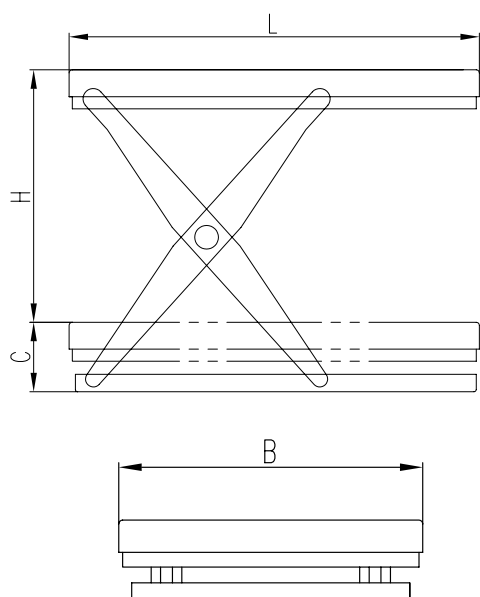



Further options, e.g. higher lifting loads, different platform sizes on request

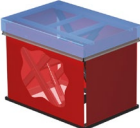

Product image shows options

# Lifting tables

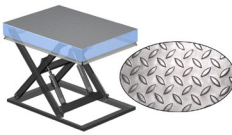
## Options

Series	HTS	HTA	HTV
<b>Railing protects the staff traveling along against falling</b> <ul style="list-style-type: none"> <li>Available for the long and the narrow sides</li> <li>Screwed or pluggable</li> <li>Operating point at the railing possible</li> </ul>		•	•
			
<b>Underrun protection</b> <ul style="list-style-type: none"> <li>Closes the open space under the platform</li> <li>Necessary when open sides cannot be viewed by the operator</li> <li>Design as PVC-roller shutter or bellows</li> </ul>		•	•
			
<b>Safety portal</b> <ul style="list-style-type: none"> <li>Effective protection against fall of persons from heights</li> </ul>		•	•
			
<b>Safety door</b> <ul style="list-style-type: none"> <li>Protects the staff traveling along against falling</li> <li>Electrically lockable (lifting table moves only with the door closed)</li> </ul>		•	•
			
<b>Overloading flap</b> <ul style="list-style-type: none"> <li>Level compensation between truck and ramp</li> <li>Multiply divided</li> </ul>		•	•
			
<b>Unrolling protection</b> <ul style="list-style-type: none"> <li>Automatic protection against accidental unrolling</li> </ul>		•	•
			
<b>Bulb plate</b> <ul style="list-style-type: none"> <li>Slip-inhibiting platform support</li> </ul>		•	•
			
<b>Electrical equipment:</b> 2. Operating point, interim stop, potential-free contacts		•	•
			
<b>Changed platform</b>	•	•	•
<b>Can be overrun</b> (please indicated wheel or axle load)		•	•
<b>Special coating</b>	•	•	•
<b>Design for the outdoor area</b>	•	•	•
<b>Self-supporting frame</b>		•	•
<b>Tipping protection platform n./t. Underframe</b>		•	•

# Lifting tables

## Special solutions



### HTA-D

- Double scissor lifting table
- 500 – 1000 kg
- Lifting heights 1600 – 2000 mm



### HTA-T

- Tandem scissor lifting table
- 1000 – 6000 kg
- Lifting heights 800 – 1600 mm



### Special lifting tables

E.g. lifting table with bellows and railing

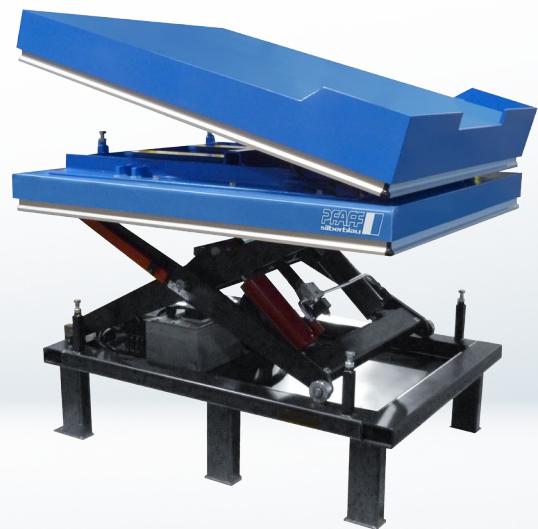

### Special lifting table

with raised base frame and tipping platform



**COLUMBUS McKINNON  
Engineered Products GmbH**

Am Silberpark 2-8  
86438 Kissing  
Germany  
Phone: +49 8233 2121 777  
Fax: +49 8233 2121 805  
sales.kissing@cmco.eu  
www.pfaff-silberblau.com



Technical changes reserved. No warranty for print errors or mistakes. Valid as of 10/2016. Reprint and any reproduction, even in excerpts, only with written consent of Columbus McKinnon Engineered Products GmbH, Kissing

192035998 10/2016 EN