



Movable, stable, height-adjustable...
 For every application case there suitable
Castors and feet

FEET SUPPORT

100087 AD30PA **Small type** Foot support 1/2" with PA-plastic ring, foot made of plastic (PA) and/or metal (WA-version)

● WZ / ● ivory

	Weight	Quantity	Foot Ø	L	ESD
AD30PA	35 g	150	30 mm	38 mm	-
AD32WA	53 g	125	32 mm	38 mm	yes

100088 AD32WA

For drive-in bush type A (1/2" thread)

AD32... **Normal type** Foot support 1/2"

	Weight	Quantity	foot Ø	L	ESD
100089 AD32WB	105g	150	32 mm	50 mm	yes
100090 AD32WC	110g	150		100 mm	yes

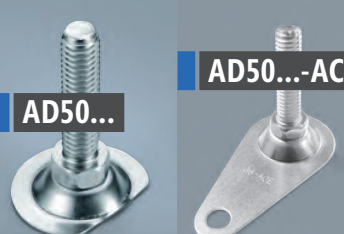

AD50...-AC

Normal type
Foot support 1/2"

		Foot Ø	L	ESD
100091	AD50WA	50 mm	50 mm	yes
100092	AD50WB		100 mm	yes
123277	AD50WA-AC	50 mm	50 mm	yes
123278	AD50WB-AC		100 mm	yes



AD40...

Normal type
Foot support 1/2"

		Foot Ø	L	ESD
126207	AD35SA	35 mm	50 mm	yes
126208	AD35SB		100 mm	yes
126209	AD40SPA	40 mm	50 mm	no
126210	AD40SPB		100 mm	no



AD50...

Rubber type
Foot support 1/2",
rubber insert

Standard		ESD version		Foot Ø	L
126393	AD32RA-M	126394	AD32RA-EM	32 mm	50 mm
		126389	AD32WB-M		70 mm
100093	AD32RA	100094	AD32RA-E		100 mm
100096	AD32RB	100097	AD32RB-E	50 mm	73 mm
		126396	AD32RB-EM		100 mm
100098	AD50RAN	100095	AD50RAN-E		123 mm
130796	AD50RAN-H	126392	AD50WB-M	100 mm	123 mm
100099	AD50RBN	100100	AD50RBN-E		123 mm
100099	AD50RBN	100100	AD50RBN-E		123 mm

For drive-in bush M10 & M12



AD45...

Foot Support

		Foot Ø	L	ESD
107530	AD30M10-35	30 mm	35 mm	yes
107531	AD30M10-70		70 mm	
118190	AD30M12-70	31 mm	100 mm	yes
107528	AD45M10-35PA	45 mm	35 mm	-
107529	AD45M10-70PA		70 mm	-
119168	AD45M12-100		100 mm	-

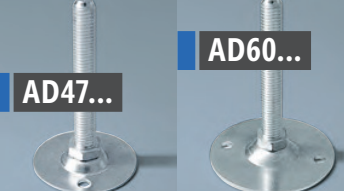

AD60...

Foot support, thread M10

		Foot Ø	L	ESD
107533	AD47M10-70	47 mm	70 mm	yes
	AD60M10-70	60 mm	70 mm	yes



115215 BSF80

Leg
Thread M12 x 1.75
Thread length:
150 mm

100082 RF-01

grey

100055 RF-01-E

ESD black

Rubber foot
weight:
35 g
quantity/box:
250

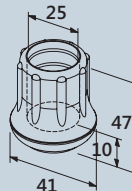

100083 RF-02

black

Rubber foot
weight:
11 g
quantity/box:
450

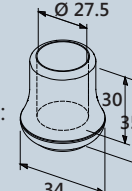

Drive-in bush, metal thread inserts, fitted inside a pipe

* suitable also for aluminium pipe AL 2820

Type A thread 1/2" 12N	Type B thread M12 x 1.75	Type M10 thread M10 x 1.5	For pipe type	Pipe Ø	Ø A	Material			
100104	BC2807A	100105	BC2807B	101663	BC2807D	D-Coat pipe	28 x 0.7 mm	24.1 mm	Steel, galvanised
100101	BC2810A*	100102	BC2810B*	100114	BC2810D*		28 x 1.0 mm	23.5 mm	Steel, galvanised
		112134	AC2814B				28 x 1.4 mm	23.0 mm	Aluminium
100107	BC2820A	100108	BC2820B	101664	BC2820D		28 x 2.0 mm	21.9 mm	Steel, galvanised
100109	BS07A	100110	BS07B	109723	BS07SM10	Eco pipe, SUS pipe	28 x 0.7 mm	26.3 mm	Steel, galvanised
100111	BS12A	100112	BS12B	100113	BS12SM10		28 x 1.2 mm	25.3 mm	Steel, galvanised

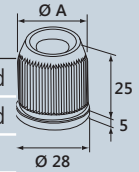

Drive-in bush

Type A thread 1/2" 12N	Type B thread M12 x 1.75	For pipe type	Pipe Ø	Ø A	Material		
126213	AC2809A	126214	AC2809B	D-Coat-pipe	28 x 1,0 mm	22,8 mm	Aluminium
100115	AC2814A	112134	AC2814B		28 x 1,4 mm	23,8 mm	Aluminium
126211	AS2807A	126216	AS2807B	Eco-pipe, SUS-pipe	28 x 0,7 mm	26,5 mm	Aluminium

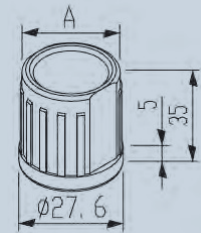

Metal thread attachments for mounting on pipe with thread facing floor for mounting of support feet

Type A 1/2" 12N	Type B thread M12 x 1.75	For pipe type	Pipe Ø	Ø A	Material		
100116	OB28A	100117	OB28B	all pipes	28 mm	27.6 mm	Steel, galvanised

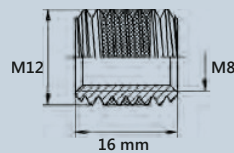
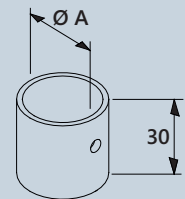

Thread reduction from M12 to M8 for mounting drive-in brush coated with adhesive

length	Material	
115237	16 mm	Steel, galvanised

100043 AP-50



Floor fixing plate
weight: 52 g
quantity/box: 220

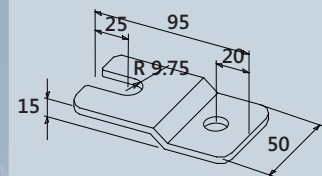

130851 RB-AD37



Rubber base for AD32WB/WC

weight: 6 g
quantity/box: 1.500

