

Cam Units DLC-DLCA
Schieber DLC-DLCA
Unità a Camme DLC-DLCA

OMCR[®]
STANDARD DIE COMPONENTS

2018.01

OMCR CODE	Work Angle	Slider Width (mm)	Closed Cam Height (mm)	Work Area W x H (mm)	Max Work Force with shoulder 10 ⁶ cycles (kN)	Extraction Force (kN)	Page number
	β				F _s	F _f	
DLC-DLCA052	0°	52	140	52x65	30	0,62÷0,65	922
DLC-DLCA065	0÷20°	65	160 (00.40÷05.45 / 10.45) 170 (05.70 / 10.70÷20.70)	65x70	39	0,78÷1,02	926
DLC-DLCA100	0÷20°	100	200	100x100	59÷79	1,17÷1,36	930
DLC-DLCA150	0÷20°	150	220 (00.40÷15.45 / 20.45) 230 (15.70 / 20.70)	150x100	89÷98	1,91÷1,96	934
DLC-DLCA200	0°	200	240	200x110	126	2,91÷2,93	938
DLC-DLCA250	0°	250	270	250x130	158	3,8÷3,83	942
DLC-DLCA300	0°	300	270	300x130	189	3,8÷3,83	946

FOR REPLACEMENT ONLY
SEE DHC FROM PAGE 886
FOR NEW DIES

Cam Units
DLC/DLCA

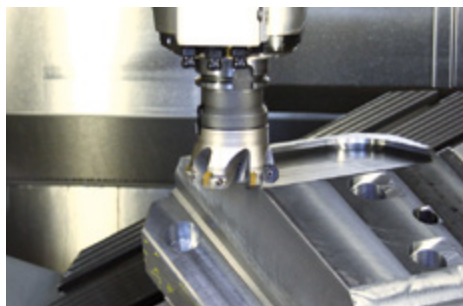

Production experience

DIE MOUNTED CAM UNIT - HORIZONTALSCHIEBER - UNITÀ A CAMME A BASE STAMPO

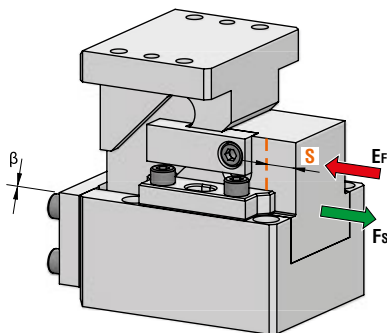

P.605

OMCR CODE	Work Angle	Stroke (mm)	Max Work Force with shoulder (kN)	Extraction Force (kN)
				E _F
	β	S	F _s	Spring
DLC-DLCA052.00.25	0°	25	30	0,62
DLC-DLCA052.00.40	0°	40	30	0,63
DLC-DLCA052.00.60	0°	60	30	0,65

FOR REPLACEMENT ONLY
SEE DHC FROM PAGE 886
FOR NEW DIES



Art.	Work Angle = 0°	Stroke = 40
DLC052	00	40

OMCR CODE		Work Angle	Stroke (mm)	Overall Dimensions (mm)						
				β	S	A	B	C	D	E
DLC052.00.25	DLCA052.00.25	0°	25	120	120	80	70	40	40	80
DLC052.00.40	DLCA052.00.40	0°	40	135	135	95	80	50	45	90
DLC052.00.60	DLCA052.00.60	0°	60	180	180	140	55	70	55	110

DIE MOUNTED CAM UNIT - HORIZONTALSCHIEBER - UNITÀ A CAMME A BASE STAMPO

X VIEW

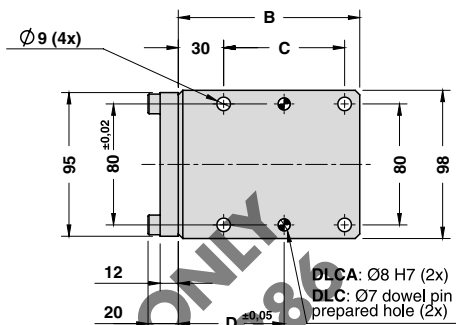
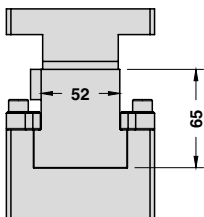

CAM DIAGRAM

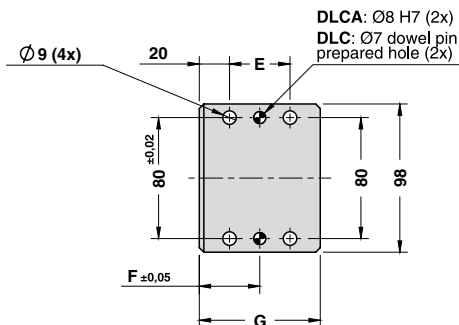
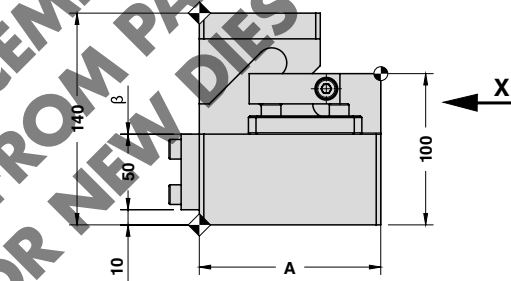
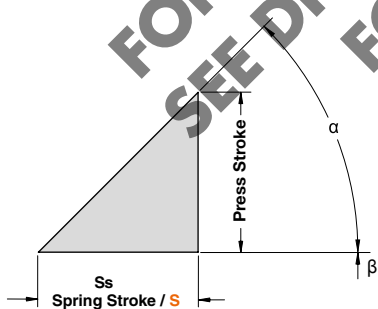

Work Angle	Inner Angle	Slider Work Stroke (mm)	Press Stroke (mm)	Spring Stroke (mm)
β	α	S	Ps	Ss
0°	45°	25	25	25
0°	45°	40	40	40
0°	45°	60	60	60

Cam Units
DLC/DLCA

DIE MOUNTED CAM UNIT - HORIZONTALSCHIEBER - UNITÀ A CAMME A BASE STAMPO

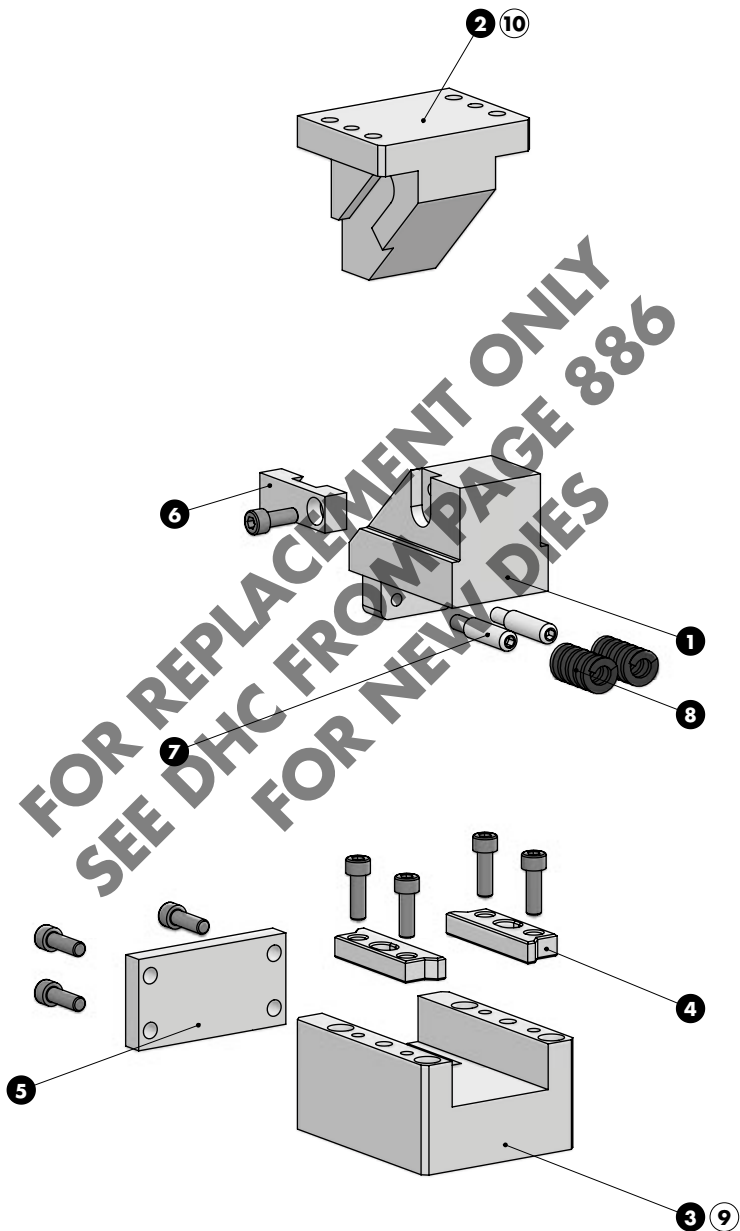

DIE MOUNTED CAM UNIT - HORIZONTALSCHIEBER - UNITÀ A CAMME A BASE STAMPO

SLIDER STRUCTURE, POSITIVE RETURN STRUCTURE AND CLEARANCES

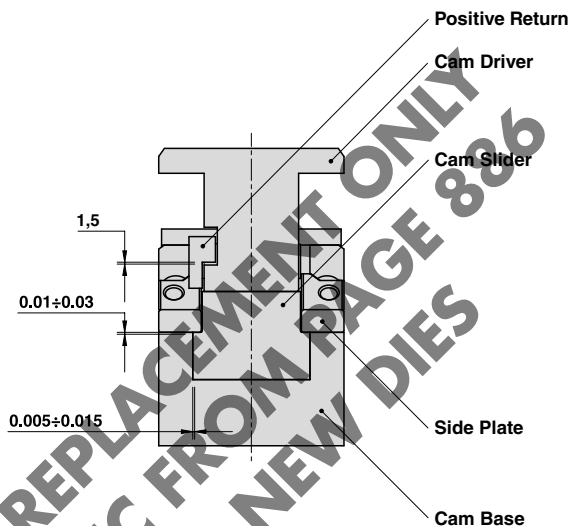

PART LIST

Particular number	Description	Material	Quantity
1	Cam Slider	GG-25 + Graphite	1
2	Cam Driver	GG-25 + Graphite	1
3	Cam Base	GG-25	1
4	Side Plate	CK45	2
5	Stopper Plate	St44	1
6	Positive Return	CK45	1
7	Spring Guide Pin	CK45	2
8	Spring	-	2
9	Cam Base Fixing Screws M8x50 DIN 912	-	4
10	Cam Driver Fixing Screws M8x30 DIN 912	-	4

DIE MOUNTED CAM UNIT - HORIZONTALSCHIEBER - UNITÀ A CAMME A BASE STAMPO

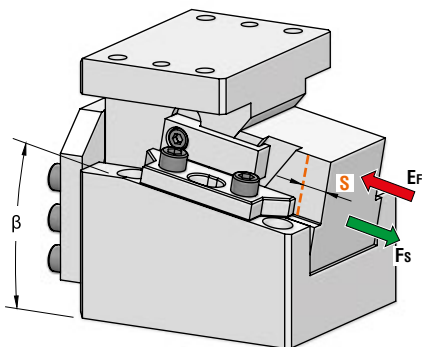

P.605

OMCR CODE	Work Angle	Stroke (mm)	Max Work Force with shoulder (kN)	Extraction Force (kN)
	β	S	Fs	Ef Spring
DLC-DLCA065.00.40	0°	40	39	0,79
DLC-DLCA065.00.60	0°	60	39	0,80
DLC-DLCA065.05.45	5°	45	39	0,78
DLC-DLCA065.05.70	5°	70	39	1,02
DLC-DLCA065.10.45	10°	45	39	0,78
DLC-DLCA065.10.70	10°	70	39	1,02
DLC-DLCA065.15.45	15°	45	39	0,78
DLC-DLCA065.15.70	15°	70	39	1,02
DLC-DLCA065.20.45	20°	45	39	0,78
DLC-DLCA065.20.70	20°	70	39	1,02

FOR REPLACEMENT ONLY
SEE DHC FROM PAGE 385
FOR NEW DIES



Art.	Work Angle = 0°	Stroke = 60
DLC065	00	60

OMCR CODE		Work Angle	Stroke (mm)	Overall Dimensions (mm)														
				β	S	A	B	C	D	E	F	G	H	I	J	K	L	M
DLC065.00.40	DLCA065.00.40	0°	40	140	115	25	50	160	145	30	100	12	27	80	60	50	100	
DLC065.00.60	DLCA065.00.60	0°	60	190	115	25	50	160	180	40	125	12	22	105	70	55	110	
DLC065.05.45	DLCA065.05.45	5°	45	150,55	112,10	12,5	100	160	145	30	100	15	25	80	60	50	100	
DLC065.05.70	DLCA065.05.70	5°	70	195,38	123,17	25	100	170	180	40	125	15	25	65	60	50	100	
DLC065.10.45	DLCA065.10.45	10°	45	154,95	108,76	20	100	160	145	30	100	15	25	79	60	50	100	
DLC065.10.70	DLCA065.10.70	10°	70	199,27	110,94	25	100	170	180	40	125	15	25	65	60	50	100	
DLC065.15.45	DLCA065.15.45	15°	45	158,18	105,09	25	100	170	145	30	100	15	25	80	60	50	100	
DLC065.15.70	DLCA065.15.70	15°	70	201,64	103,44	40	100	170	180	40	125	15	25	65	70	55	110	
DLC065.20.45	DLCA065.20.45	20°	45	160,20	101,19	30	100	170	145	30	100	15	25	80	60	50	100	
DLC065.20.70	DLCA065.20.70	20°	70	202,48	95,79	40	100	170	180	40	125	15	25	65	70	55	110	

DIE MOUNTED CAM UNIT - HORIZONTALSCHIEBER - UNITÀ A CAMME A BASE STAMPO

X VIEW

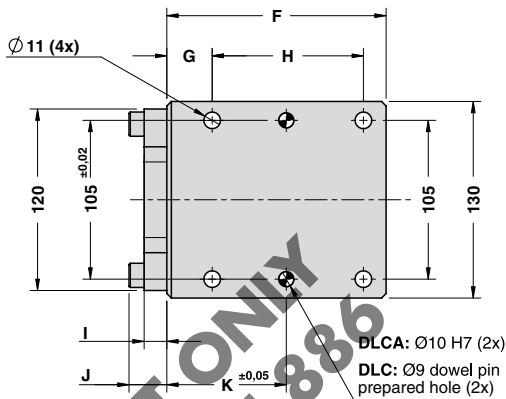
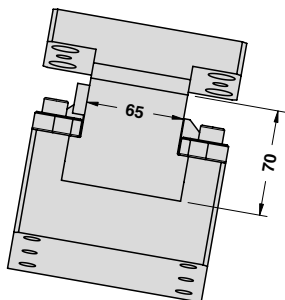

CAM DIAGRAM

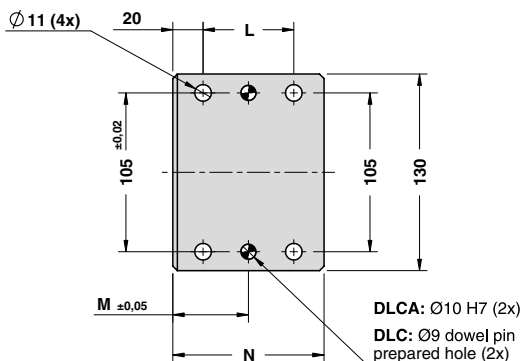
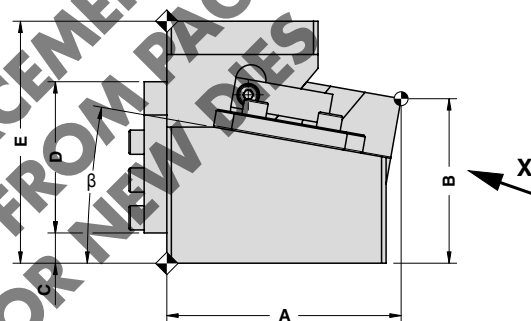
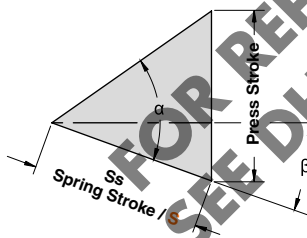

Work Angle	Inner Angle	Slider Work Stroke (mm)	Press Stroke (mm)	Spring Stroke (mm)
β	α	S	Ps	Ss
0°	45°	40	40	40
0°	45°	60	60	60
5°	60°	45	67,94	45
5°	60°	70	105,69	70
10°	60°	45	60,63	45
10°	60°	70	94,31	70
15°	60°	45	55,11	45
15°	60°	70	85,73	70
20°	60°	45	50,87	45
20°	60°	70	79,14	70

Cam Units
 DLC/DLCA

DIE MOUNTED CAM UNIT - HORIZONTALSCHIEBER - UNITÀ A CAMME A BASE STAMPO

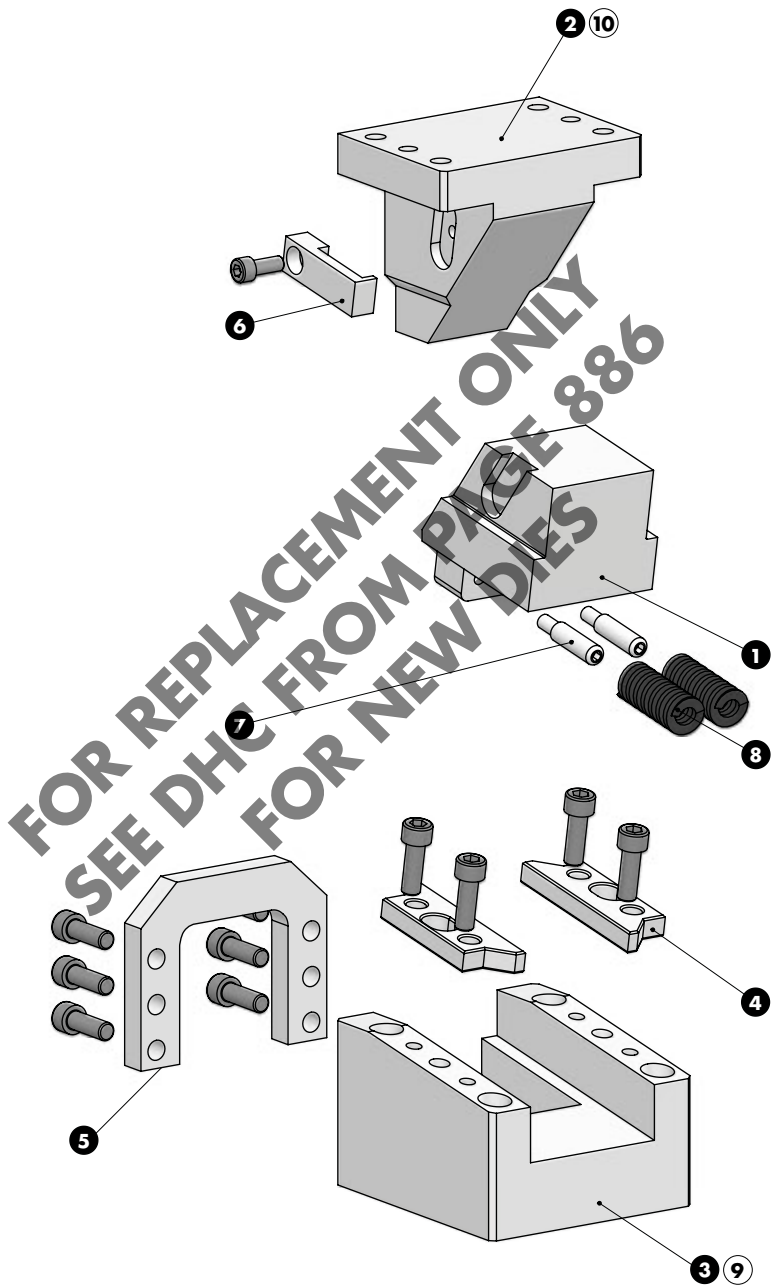

DIE MOUNTED CAM UNIT - HORIZONTALSCHIEBER - UNITÀ A CAMME A BASE STAMPO

SLIDER STRUCTURE, POSITIVE RETURN STRUCTURE AND CLEARANCES

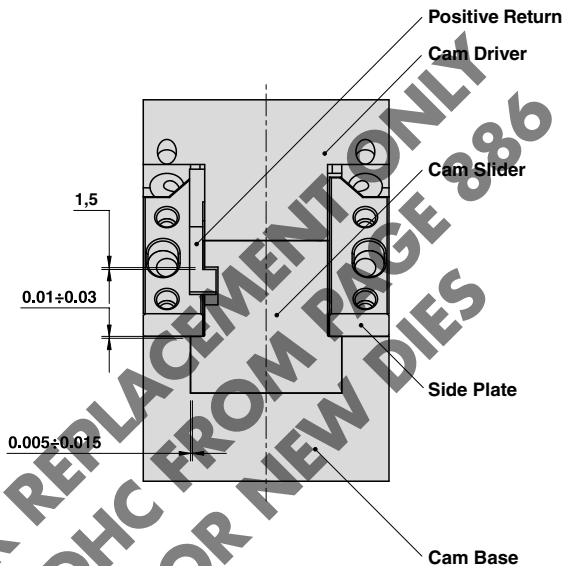

Cam Units
DLC/DLCA

PART LIST

Particular number	Description	Material	Quantity
1	Cam Slider	GG-25 + Graphite	1
2	Cam Driver	GG-25 + Graphite	1
3	Cam Base	GG-25	1
4	Side Plate	CK45	2
5	Stopper Plate	St44	1
6	Positive Return	CK45	1
7	Spring Guide Pin	CK45	2
8	Spring	-	2
9	Cam Base Fixing Screws M10x50 DIN 912	-	4
10	Cam Driver Fixing Screws M10x40 DIN 912	-	4

DIE MOUNTED CAM UNIT - HORIZONTALSCHIEBER - UNITÀ A CAMME A BASE STAMPO

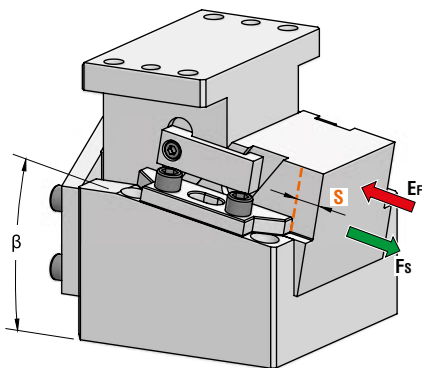

P.605

OMCR CODE	Work Angle	Stroke (mm)	Max Work Force with shoulder (kN)	Extraction Force (kN)
	β	S	Fs	Ef
DLC-DLCA100.00.40	0°	40	59	1,19
DLC-DLCA100.00.60	0°	60	59	1,20
DLC-DLCA100.00.80	0°	80	59	1,36
DLC-DLCA100.05.45	5°	45	79	1,17
DLC-DLCA100.05.70	5°	70	79	1,20
DLC-DLCA100.10.45	10°	45	79	1,17
DLC-DLCA100.10.70	10°	70	79	1,20
DLC-DLCA100.15.45	15°	45	79	1,17
DLC-DLCA100.15.70	15°	70	79	1,20
DLC-DLCA100.20.45	20°	45	79	1,17
DLC-DLCA100.20.70	20°	70	79	1,20

OPTION CODE

N

Ø 12 H7 DLCA only

FOR REPLACEMENT ONLY SEE DHC FROM PAGE 380 FOR NEW DIES



Art.	Work Angle = 0°	Stroke = 60	OPTION CODE (DLCA only)
DLCA100	00	60	N12

OMCR CODE	DLCA100.00.40	Work Angle	Stroke (mm)	Overall Dimensions (mm)															
				β	S	A	B	C	D	E	F	G	H	I	J	K	L	M	N
DLC100.00.40	DLCA100.00.40	0°	40	190	150	30	60	190	45	130	140	16	28	105	80	60	120	100	
DLC100.00.60	DLCA100.00.60	0°	60	210	150	30	60	190	45	130	140	16	28	105	100	70	140	100	
DLC100.00.80	DLCA100.00.80	0°	80	250	150	10	115	220	45	160	140	15	27	135	110	75	150	100	
DLC100.05.45	DLCA100.05.45	5°	45	172,22	145,28	27,5	115	160	40	105	140	15	27	90	60	50	100	90	
DLC100.05.70	DLCA100.05.70	5°	70	207,08	147,23	30	115	190	45	130	150	15	27	70	80	60	120	90	
DLC100.10.45	DLCA100.10.45	10°	45	178,12	134,98	30	115	160	40	105	140	15	27	90	60	50	100	90	
DLC100.10.70	DLCA100.10.70	10°	70	212,59	133,90	30	115	190	45	130	150	15	27	70	80	60	120	90	
DLC100.15.45	DLCA100.15.45	15°	45	182,67	129,23	32,5	115	160	40	105	140	15	27	90	70	55	110	90	
DLC100.15.70	DLCA100.15.70	15°	70	216,48	130,17	35	115	190	45	130	150	15	27	70	90	65	130	90	
DLC100.20.45	DLCA100.20.45	20°	45	185,83	118,14	35	115	160	40	105	140	15	27	90	70	55	110	90	
DLC100.20.70	DLCA100.20.70	20°	70	218,72	121,17	45	115	190	45	130	150	15	27	70	90	65	130	90	

DIE MOUNTED CAM UNIT - HORIZONTALSCHIEBER - UNITÀ A CAMME A BASE STAMPO

X VIEW

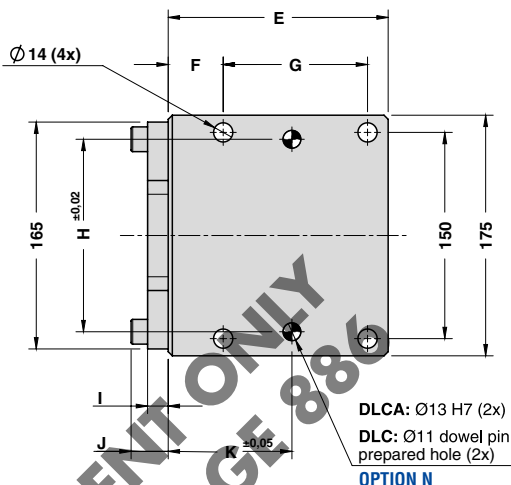
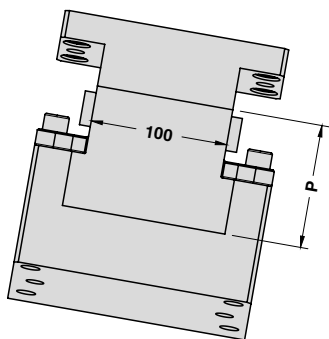

CAM DIAGRAM

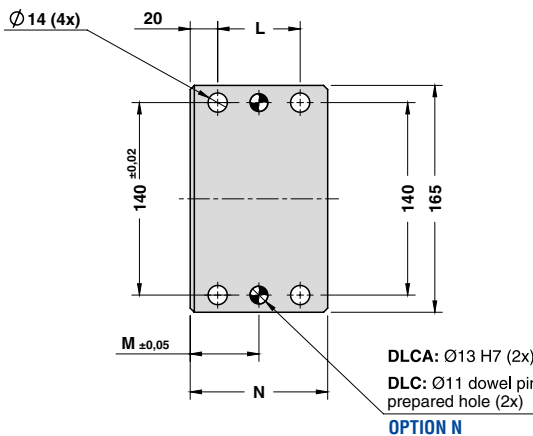
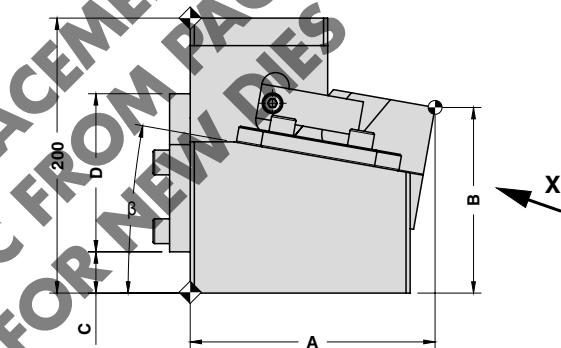
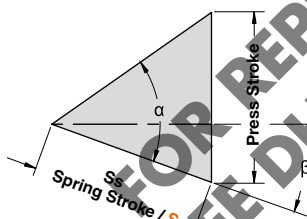

Work Angle	Inner Angle	Slider Work Stroke (mm)	Press Stroke (mm)	Spring Stroke (mm)
β	α	S	Ps	Ss
0°	45°	40	40	40
0°	45°	60	60	60
0°	45°	80	80	80
5°	60°	45	67,94	45
5°	60°	70	105,69	70
10°	60°	45	60,63	45
10°	60°	70	94,31	70
15°	60°	45	55,11	45
15°	60°	70	85,73	70
20°	60°	45	50,87	45
20°	60°	70	79,14	70

Cam Units
DLC/DLCA

DIE MOUNTED CAM UNIT - HORIZONTALSCHIEBER - UNITÀ A CAMME A BASE STAMPO

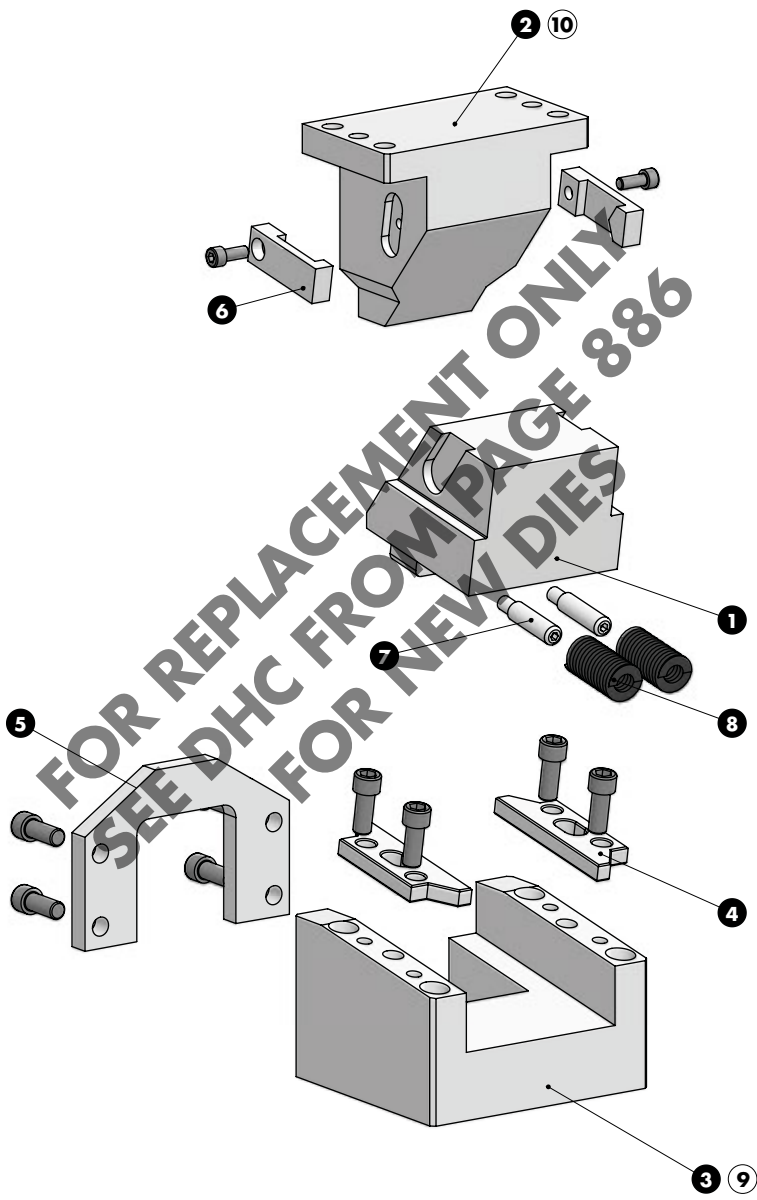

DIE MOUNTED CAM UNIT - HORIZONTALSCHIEBER - UNITÀ A CAMME A BASE STAMPO

SLIDER STRUCTURE, POSITIVE RETURN STRUCTURE AND CLEARANCES

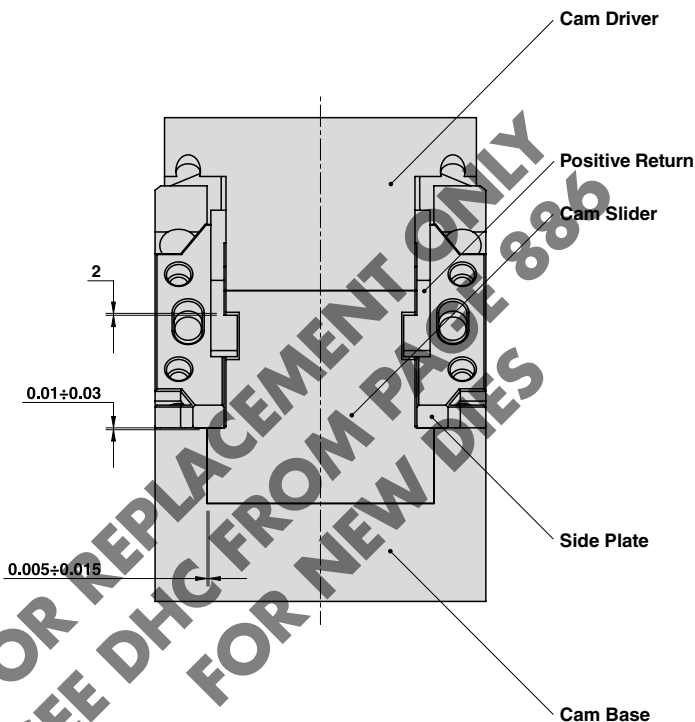

Cam Units
DLC/DLCA

PART LIST

Particular number	Description	Material	Quantity
1	Cam Slider	GG-25 + Graphite	1
2	Cam Driver	GG-25 + Graphite	1
3	Cam Base	GG-25	1
4	Side Plate	CK45	2
5	Stopper Plate	St44	1
6	Positive Return	CK45	1
7	Spring Guide Pin	CK45	2
8	Spring	-	2
9	Cam Base Fixing Screws M12x60 DIN 912	-	4
10	Cam Driver Fixing Screws M12x45 DIN 912	-	4

DIE MOUNTED CAM UNIT - HORIZONTALSCHIEBER - UNITÀ A CAMME A BASE STAMPO

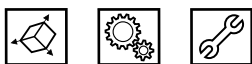
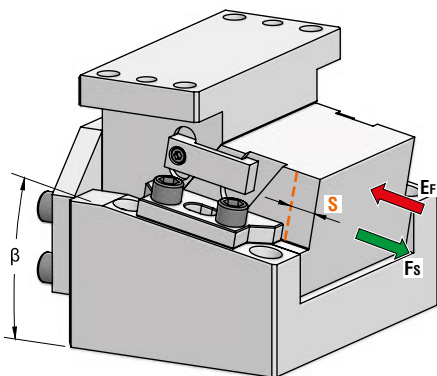

P.605

OMCR CODE	Work Angle	Stroke (mm)	Max Work Force with shoulder (kN)	Extraction Force (kN)
	β			Spring
DLC-DLCA150.00.40	0°	40	89	1,94
DLC-DLCA150.00.60	0°	60	89	1,96
DLC-DLCA150.05.45	5°	45	98	1,91
DLC-DLCA150.05.70	5°	70	98	1,94
DLC-DLCA150.10.45	10°	45	98	1,91
DLC-DLCA150.10.70	10°	70	98	1,94
DLC-DLCA150.15.45	15°	45	98	1,91
DLC-DLCA150.15.70	15°	70	98	1,94
DLC-DLCA150.20.45	20°	45	98	1,91
DLC-DLCA150.20.70	20°	70	98	1,94

FOR REPLACEMENT ONLY
SEE DHC FROM PAGE 380
FOR NEW DIES



Art.	Work Angle = 0°	Stroke = 60
DLC150	00	60

OMCR CODE		Work Angle	Stroke (mm)	Overall Dimensions (mm)												
				β	S	A	B	C	D	E	F	G	H	I	J	K
DLC150.00.40	DLCA150.00.40	0°	40	190	170	45	65	220	190	125	19	35	105	80	60	120
DLC150.00.60	DLCA150.00.60	0°	60	210	170	45	65	220	200	135	19	35	110	100	70	140
DLC150.05.45	DLCA150.05.45	5°	45	193,01	158,50	30	125	220	190	125	20	36	105	70	55	110
DLC150.05.70	DLCA150.05.70	5°	70	217,92	166,32	40	125	220	200	135	20	36	120	90	65	130
DLC150.10.45	DLCA150.10.45	10°	45	199,55	151,36	40	125	220	190	125	20	36	105	70	55	110
DLC150.10.70	DLCA150.10.70	10°	70	224,17	152,02	40	125	220	200	135	20	36	120	90	65	130
DLC150.15.45	DLCA150.15.45	15°	45	204,58	143,71	40	125	220	190	125	20	36	105	80	60	120
DLC150.15.70	DLCA150.15.70	15°	70	228,73	152,24	55	125	230	200	135	20	36	120	100	70	140
DLC150.20.45	DLCA150.20.45	20°	45	208,05	135,70	40	125	220	190	125	20	36	105	80	60	120
DLC150.20.70	DLCA150.20.70	20°	70	231,54	137,15	55	125	230	200	135	20	36	120	100	70	140

DIE MOUNTED CAM UNIT - HORIZONTALSCHIEBER - UNITÀ A CAMME A BASE STAMPO

X VIEW

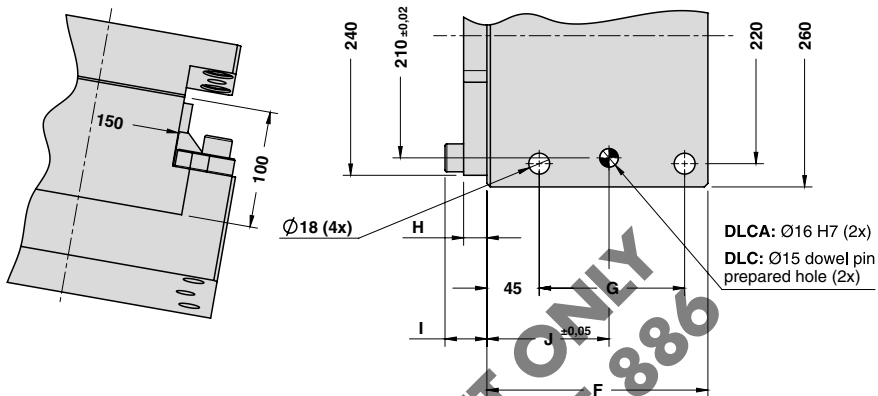

CAM DIAGRAM

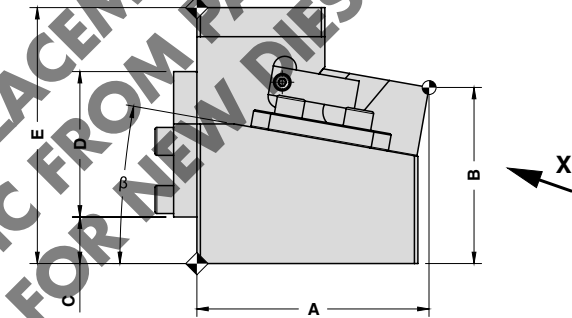
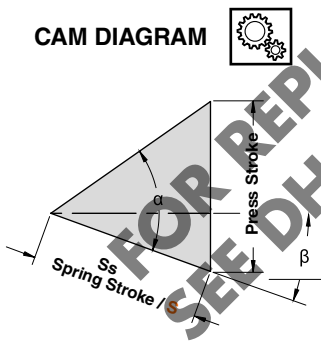

Work Angle	Inner Angle	Slider Work Stroke (mm)	Press Stroke (mm)	Spring Stroke (mm)
β	α	S	Ps	Ss
0°	45°	40	40	40
0°	45°	60	60	60
5°	60°	45	67,94	45
5°	60°	70	105,69	70
10°	60°	45	60,63	45
10°	60°	70	94,31	70
15°	60°	45	55,11	45
15°	60°	70	85,73	70
20°	60°	45	50,87	45
20°	60°	70	79,14	70

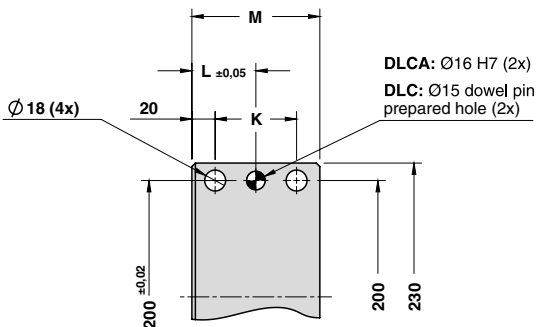

Cam Units
DLC/DLCA

DIE MOUNTED CAM UNIT - HORIZONTALSCHIEBER - UNITÀ A CAMME A BASE STAMPO

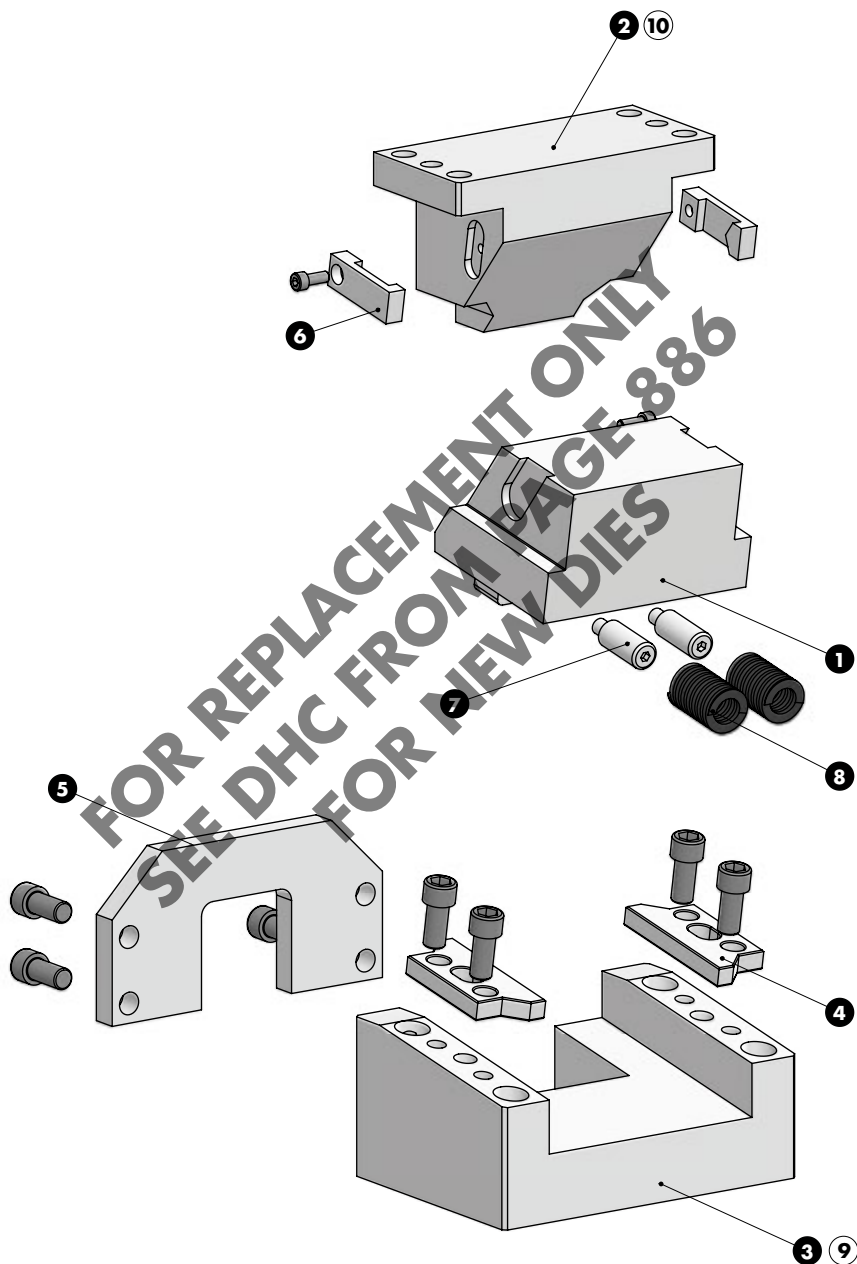

DIE MOUNTED CAM UNIT - HORIZONTALSCHIEBER - UNITÀ A CAMME A BASE STAMPO

SLIDER STRUCTURE, POSITIVE RETURN STRUCTURE AND CLEARANCES

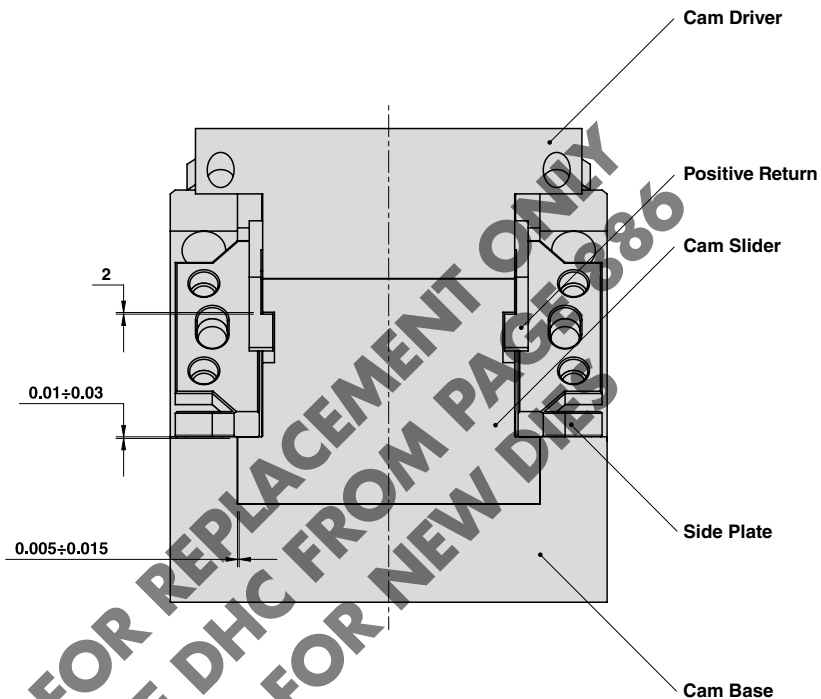

Cam Units
DLC/DLCA

PART LIST

Particular number	Description	Material	Quantity
1	Cam Slider	GG-25 + Graphite	1
2	Cam Driver	GG-25 + Graphite	1
3	Cam Base	GG-25	1
4	Side Plate	CK45	2
5	Stopper Plate	St44	1
6	Positive Return	CK45	1
7	Spring Guide Pin	CK45	2
8	Spring	-	2
9	Cam Base Fixing Screws M16x80 DIN 912	-	4
10	Cam Driver Fixing Screws M16x55 DIN 912	-	4

DIE MOUNTED CAM UNIT - HORIZONTALSCHIEBER - UNITÀ A CAMME A BASE STAMPO

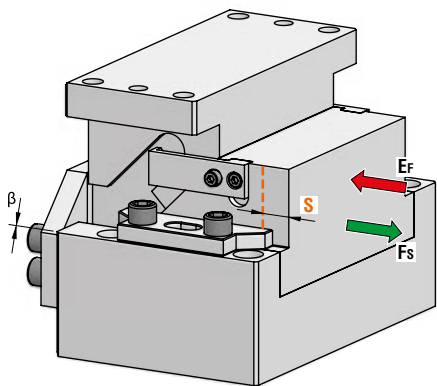

OMCR CODE	Work Angle	Stroke (mm)	Max Work Force with shoulder (kN)	Extraction Force (kN)
	β	S	F _s	E _f Spring
DLC-DLCA200.00.40	0°	40	126	2,91
DLC-DLCA200.00.60	0°	60	126	2,93



P.605

FOR REPLACEMENT ONLY
SEE DHC FROM PAGE 886
FOR NEW DIES



Art.	Work Angle = 0°	Stroke = 60
DLC200	00	60

OMCR CODE		Work Angle	Stroke (mm)	Overall Dimensions (mm)						
				β	S	A	B	C	D	E
DLC200.00.40	DLCA200.00.40	0°	40	200	200	135	110	90	65	130
DLC200.00.60	DLCA200.00.60	0°	60	220	210	145	120	110	75	150

DIE MOUNTED CAM UNIT - HORIZONTALSCHIEBER - UNITÀ A CAMME A BASE STAMPO

X VIEW

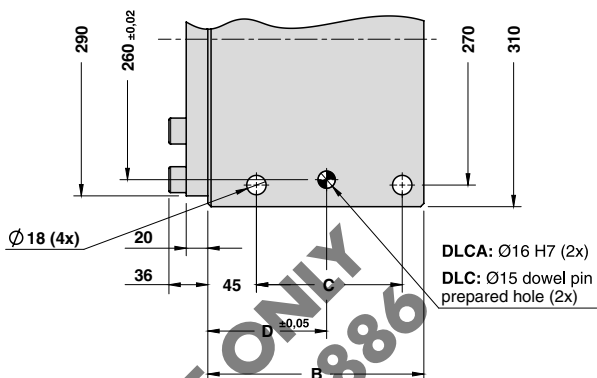
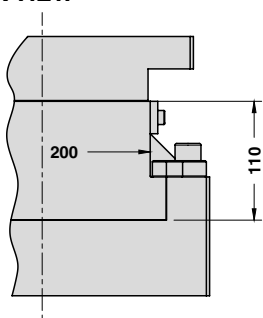

CAM DIAGRAM

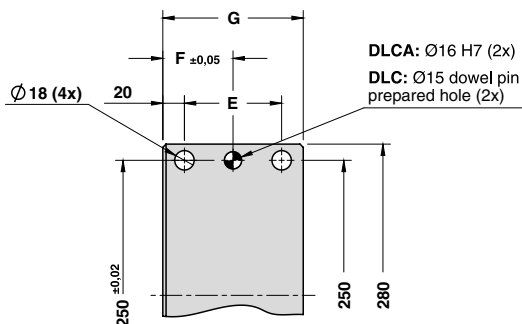
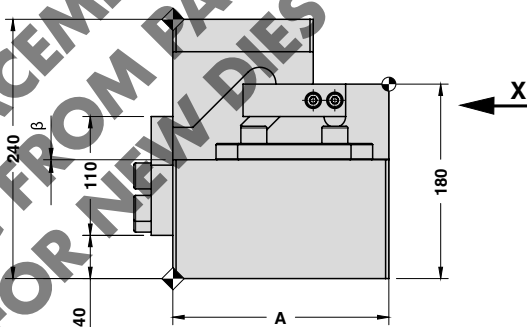
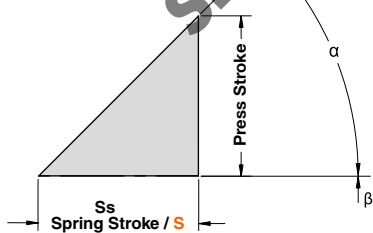

Work Angle	Inner Angle	Slider Work Stroke (mm)	Press Stroke (mm)	Spring Stroke (mm)
β	α	S	Ps	Ss
0°	45°	40	40	40
0°	45°	60	60	60

Cam Units
DLC/DLCA

DIE MOUNTED CAM UNIT - HORIZONTALSCHIEBER - UNITÀ A CAMME A BASE STAMPO

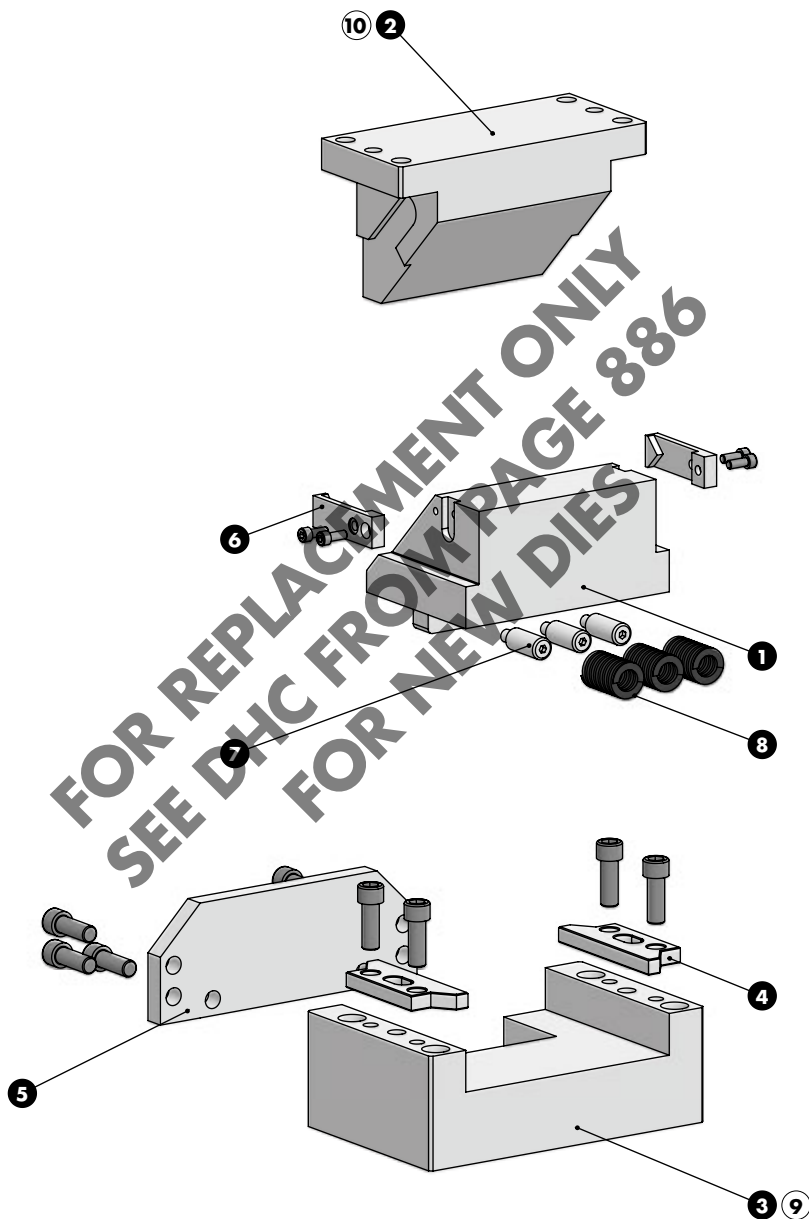

DIE MOUNTED CAM UNIT - HORIZONTALSCHIEBER - UNITÀ A CAMME A BASE STAMPO

SLIDER STRUCTURE, POSITIVE RETURN STRUCTURE AND CLEARANCES

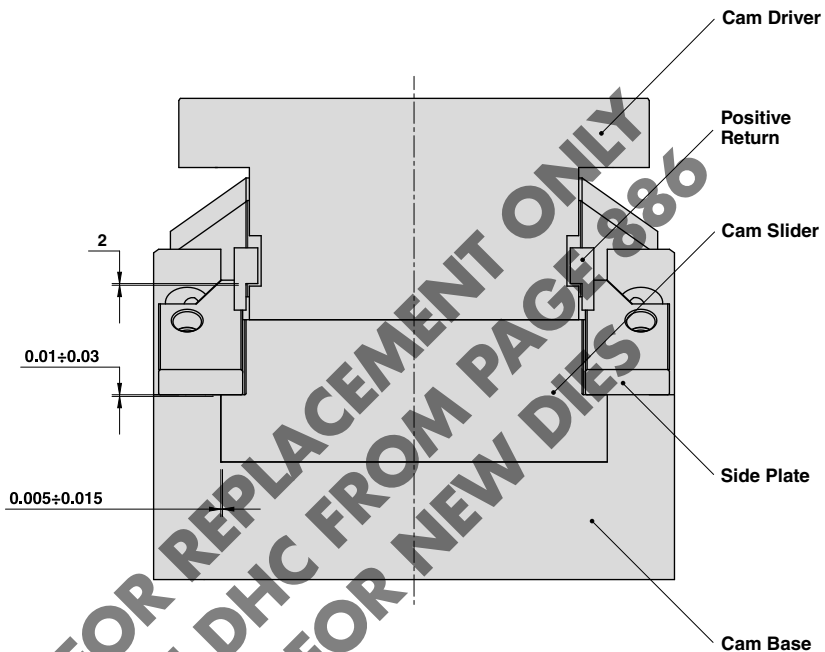

Cam Units
DLC/DLCA

PART LIST

Particular number	Description	Material	Quantity
1	Cam Slider	GG-25 + Graphite	1
2	Cam Driver	GG-25 + Graphite	1
3	Cam Base	GG-25	1
4	Side Plate	CK45	2
5	Stopper Plate	St44	1
6	Positive Return	CK45	2
7	Spring Guide Pin	CK45	3
8	Spring	-	3
9	Cam Base Fixing Screws M16x80 DIN 912	-	4
10	Cam Driver Fixing Screws M16x60 DIN 912	-	4

DIE MOUNTED CAM UNIT - HORIZONTALSCHIEBER - UNITÀ A CAMME A BASE STAMPO

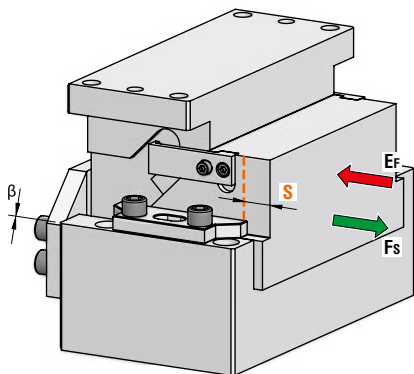

P.605

OMCR CODE	Work Angle	Stroke (mm)	Max Work Force with shoulder (kN)	Extraction Force (kN)
	β	S	F _s	E _f Spring
DLC-DLCA250.00.40	0°	40	158	3,80
DLC-DLCA250.00.60	0°	60	158	3,83

FOR REPLACEMENT ONLY
SEE DHC FROM PAGE 886
FOR NEW DIES



Art.	Work Angle = 0°	Stroke = 60
DLC250	00	60

OMCR CODE		Work Angle	Stroke	Overall Dimensions (mm)						
				β	S	A	B	C	D	E
DLC250.00.40	DLCA250.00.40	0°	40	210	200	135	105	100	70	140
DLC250.00.60	DLCA250.00.60	0°	60	230	220	155	125	120	80	160

DIE MOUNTED CAM UNIT - HORIZONTALSCHIEBER - UNITÀ A CAMME A BASE STAMPO

X VIEW

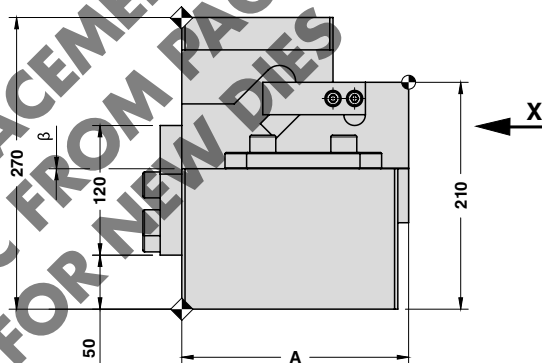
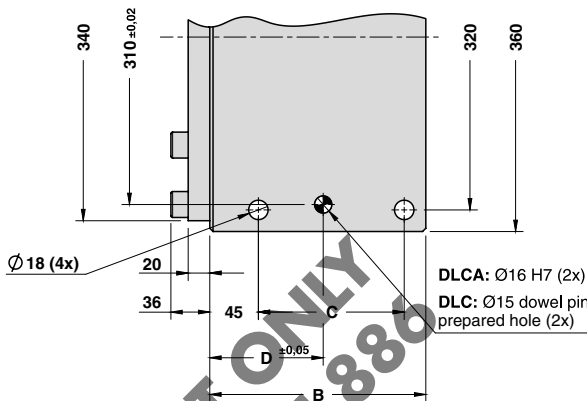
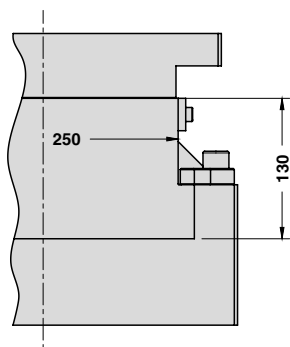

CAM DIAGRAM

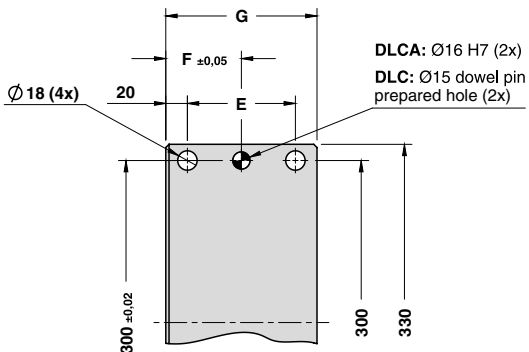
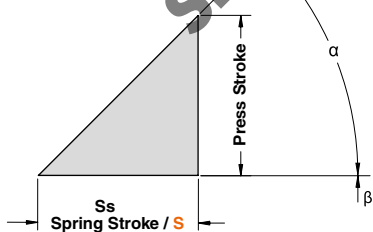

Work Angle	Inner Angle	Slider Work Stroke (mm)	Press Stroke (mm)	Spring Stroke (mm)
β	α	S	Ps	Ss
0°	45°	40	40	40
0°	45°	60	60	60

Cam Units
DLC/DLCA

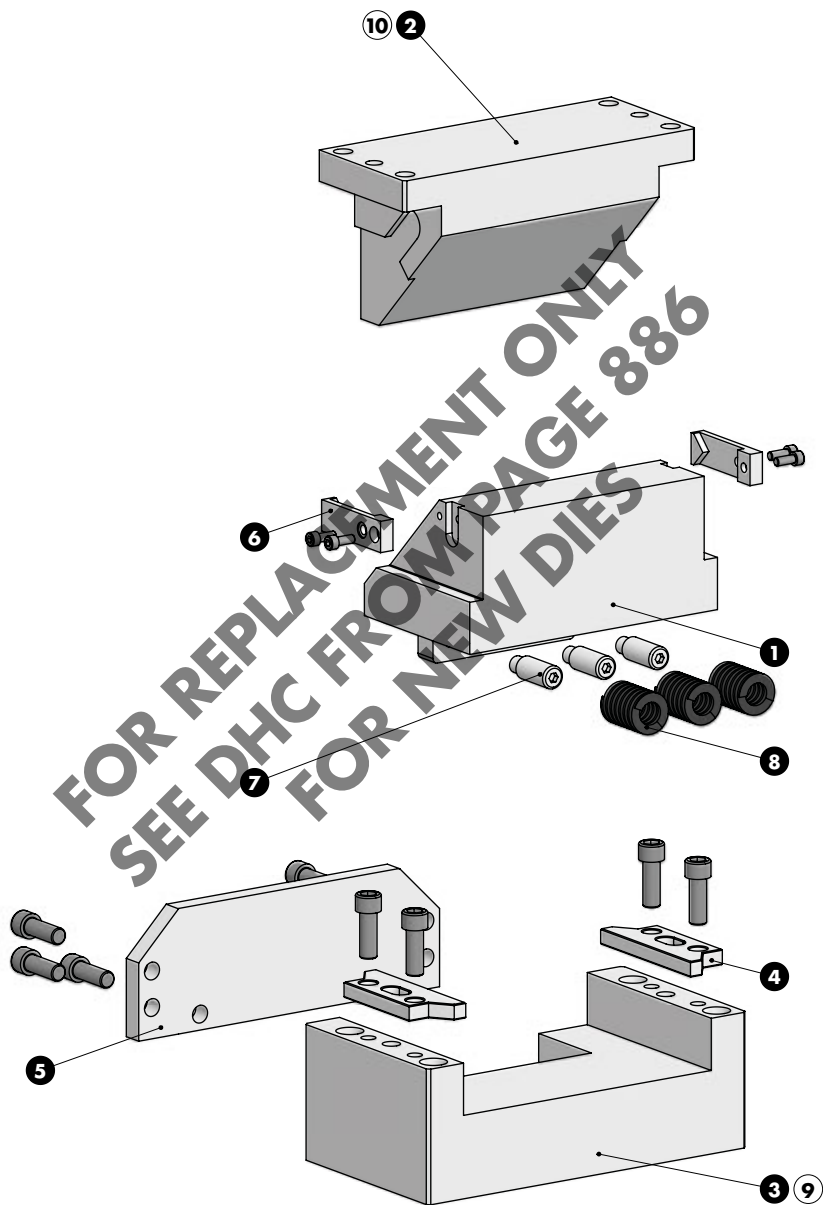

DIE MOUNTED CAM UNIT - HORIZONTALSCHIEBER - UNITÀ A CAMME A BASE STAMPO

SLIDER STRUCTURE, POSITIVE RETURN STRUCTURE AND CLEARANCES

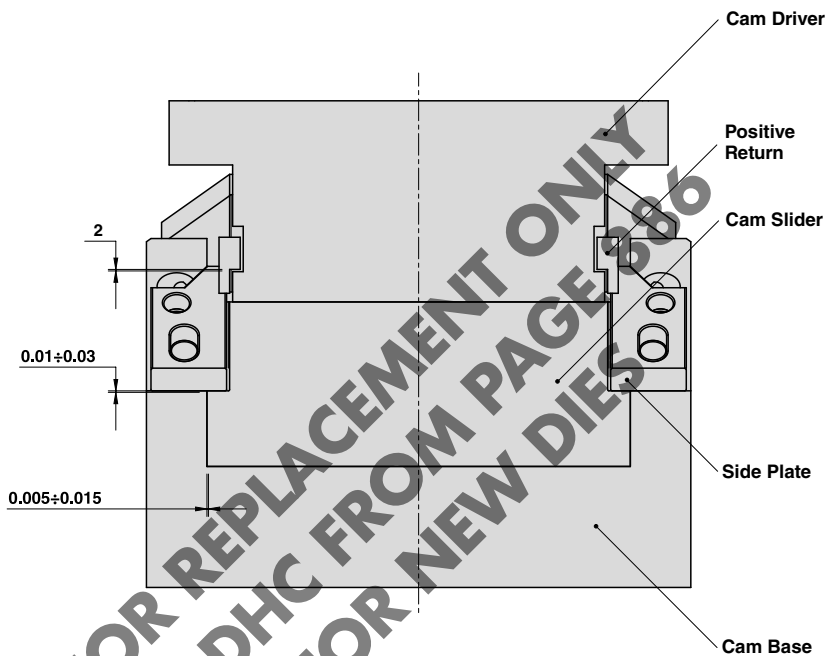

PART LIST

Particular number	Description	Material	Quantity
1	Cam Slider	GG-25 + Graphite	1
2	Cam Driver	GG-25 + Graphite	1
3	Cam Base	GG-25	1
4	Side Plate	CK45	2
5	Stopper Plate	St44	1
6	Positive Return	CK45	2
7	Spring Guide Pin	CK45	3
8	Spring	-	3
9	Cam Base Fixing Screws M16x90 DIN 912	-	4
10	Cam Driver Fixing Screws M16x60 DIN 912	-	4

DIE MOUNTED CAM UNIT - HORIZONTALSCHIEBER - UNITÀ A CAMME A BASE STAMPO

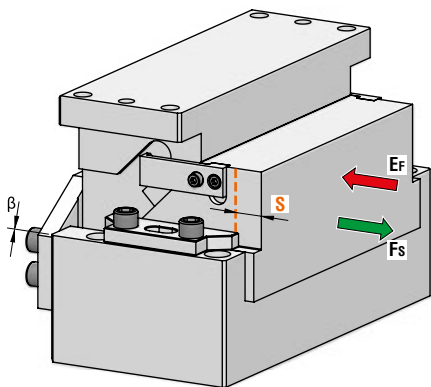

OMCR CODE	Work Angle	Stroke (mm)	Max Work Force with shoulder (kN)	Extraction Force (kN)
	β	S	F _s	E _f Spring
DLC-DLCA300.00.40	0°	40	189	3,80
DLC-DLCA300.00.60	0°	60	189	3,83



P.605

FOR REPLACEMENT ONLY
SEE DHC FROM PAGE 886
FOR NEW DIES



Art.	Work Angle = 0°	Stroke = 60
DLC300	00	60

OMCR CODE		Work Angle	Stroke	Overall Dimensions (mm)						
		β	S	A	B	C	D	E	F	G
DLC300.00.40	DLCA300.00.40	0°	40	210	200	135	105	100	70	140
DLC300.00.60	DLCA300.00.60	0°	60	230	220	155	125	120	80	160

DIE MOUNTED CAM UNIT - HORIZONTALSCHIEBER - UNITÀ A CAMME A BASE STAMPO

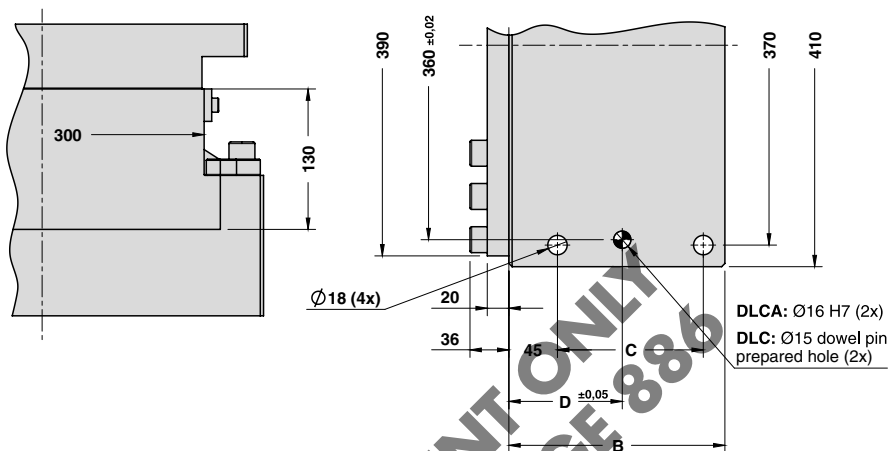

CAM DIAGRAM

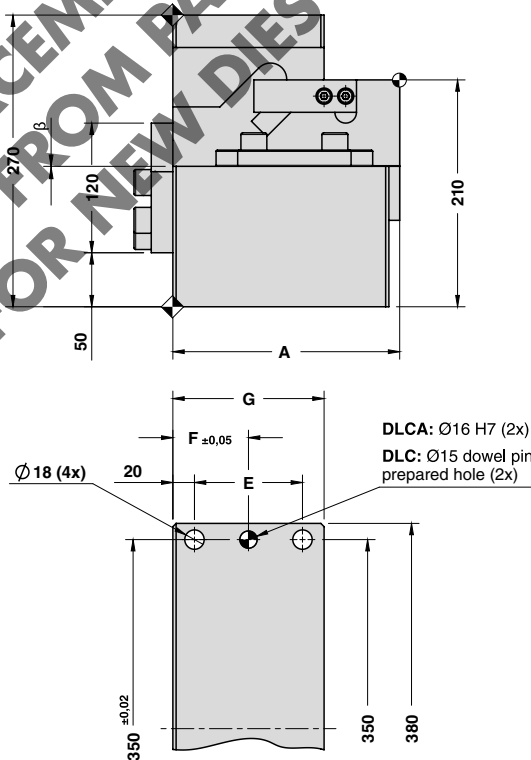
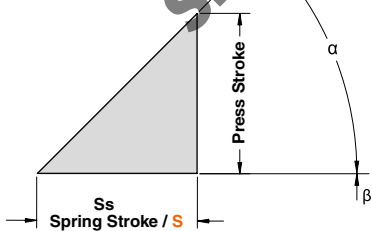

Work Angle	Inner Angle	Slider Work Stroke (mm)	Press Stroke (mm)	Spring Stroke (mm)
β	α	S	Ps	Ss
0°	45°	40	40	40
0°	45°	60	60	60

Cam Units
DLC/DLCA

DIE MOUNTED CAM UNIT - HORIZONTALSCHIEBER - UNITÀ A CAMME A BASE STAMPO

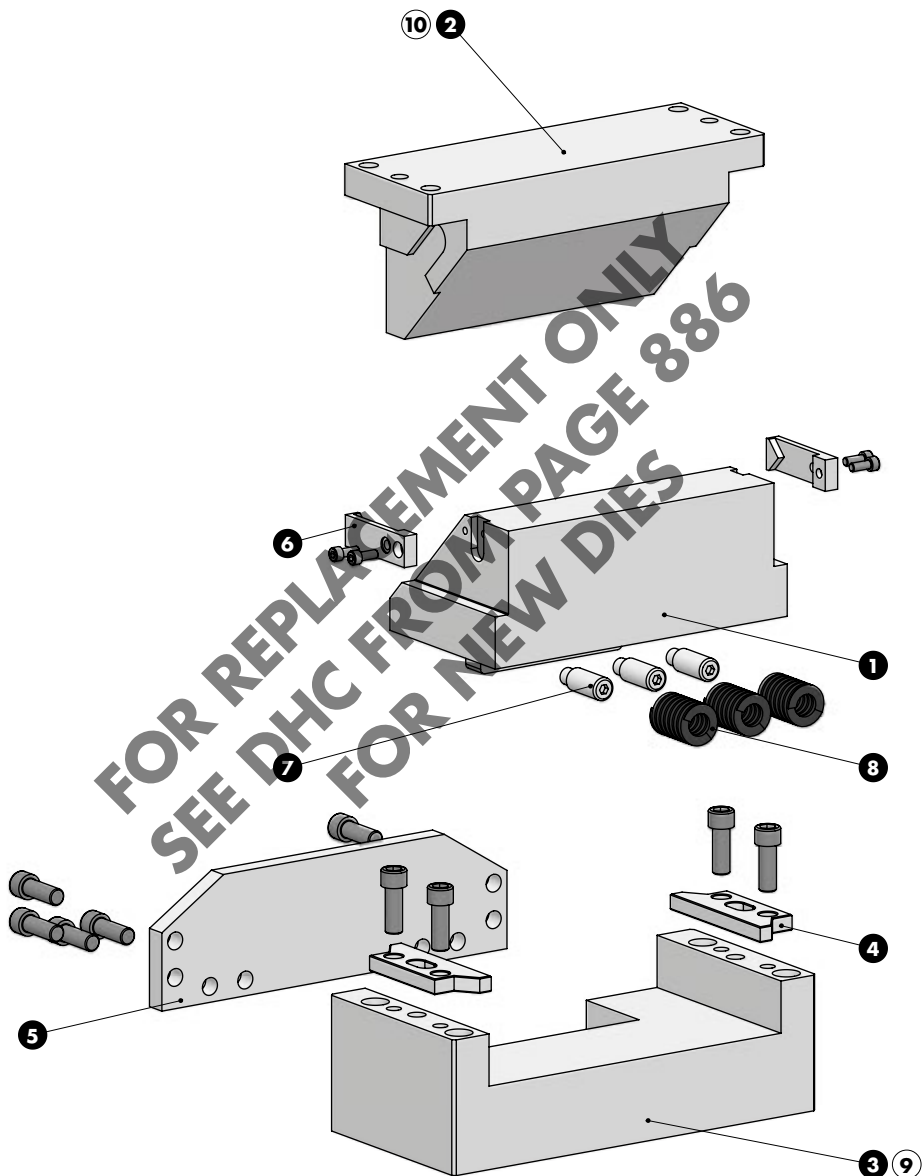

DIE MOUNTED CAM UNIT - HORIZONTALSCHIEBER - UNITÀ A CAMME A BASE STAMPO

SLIDER STRUCTURE, POSITIVE RETURN STRUCTURE AND CLEARANCES

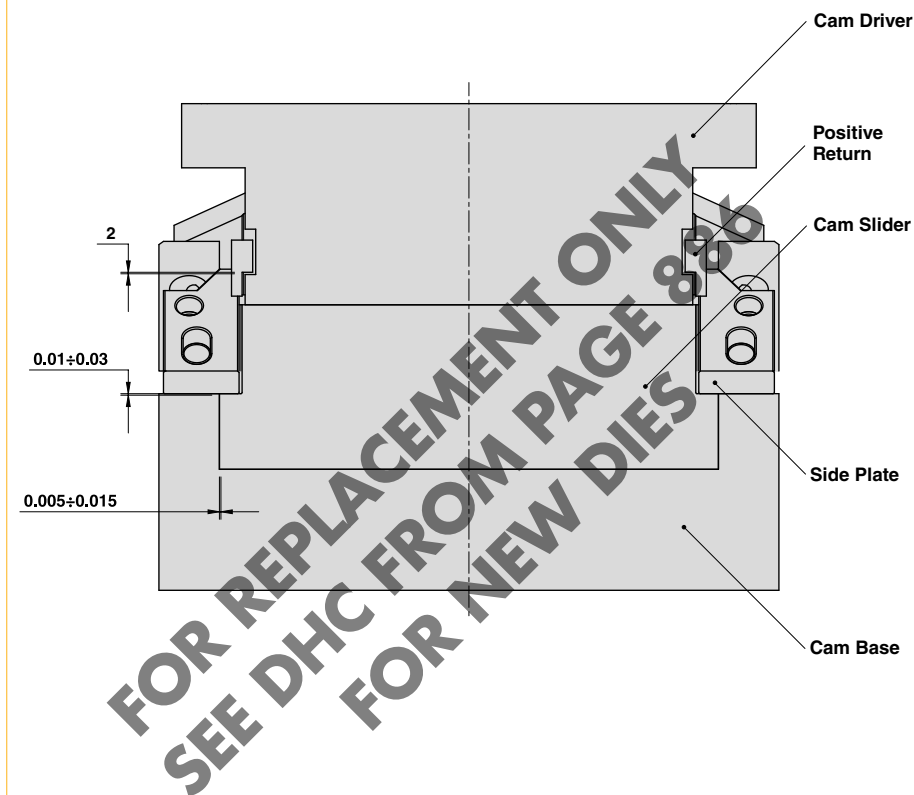

PART LIST

Particular number	Description	Material	Quantity
1	Cam Slider	GG-25 + Graphite	1
2	Cam Driver	GG-25 + Graphite	1
3	Cam Base	GG-25	1
4	Side Plate	CK45	2
5	Stopper Plate	St44	1
6	Positive Return	CK45	2
7	Spring Guide Pin	CK45	3
8	Spring	-	3
9	Cam Base Fixing Screws M16x90 DIN 912	-	4
10	Cam Driver Fixing Screws M16x60 DIN 912	-	4