

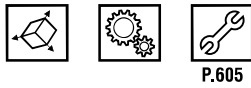

AERIAL CAM UNIT - OBEN HÄNGENDER SCHIEBER - UNITÀ A CAMME SOSPESA

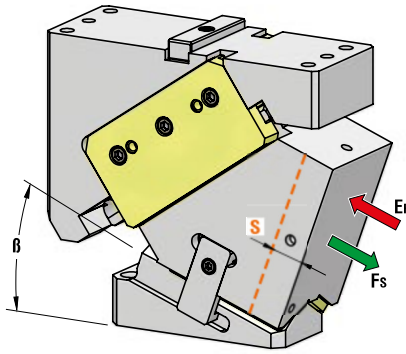

OMCR CODE	Work Angle	Stroke (mm)	Max Work Force with shoulder (kN)	Extraction Force (kN)
	β	S	F _s	E _f Gas Spring
CHV110.00	0°	30,85	357	11,4
CHV110.05	5°	34,07	366	11,4
CHV110.10	10°	34,46	369	12,2
CHV110.15	15°	38,07	372	12,2
CHV110.20	20°	41,84	375	12,2
CHV110.25	25°	43,38	378	12,8
CHV110.30	30°	48	381	12,8
CHV110.35	35°	50,75	384	13,4
CHV110.40	40°	56,79	387	13,4
CHV110.45	45°	61,52	390	13,6
CHV110.50	50°	48,24	393	13,6
CHV110.55	55°	54,06	396	13,6
CHV110.60	60°	63,75	399	14,0
CHV110.65	65°	75,42	402	14,3
CHV110.70	70°	95,02	405	14,4
CHV110.75	75°	95,13	407	14,4

STOCK	ORDER EXAMPLE	Art.	Work Angle = 5°
		CHV110	05

OMCR CODE	Work Angle	Overall Dimensions (mm)												
		β	A	B	C	D	E	F	G	H	I	J	K	L
CHV110.00	0°	278	70	60	270	210	85	35	15	155	15	255	97,5	290
CHV110.05	5°	285,45	74,28	60	265	205	85	35	15	155	15	255	117	290
CHV110.10	10°	292,94	79,21	60	255	195	85	35	15	155	15	255	124,5	290
CHV110.15	15°	300,41	84,79	60	250	190	85	35	15	155	15	255	133,5	290
CHV110.20	20°	307,80	91,02	60	245	185	85	35	15	155	15	255	141	290
CHV110.25	25°	305,05	97,89	50	228	178	40	45	15	135	20	260	140	300
CHV110.30	30°	309,61	109,72	50	222	172	40	45	15	135	20	260	147,5	300
CHV110.35	35°	316,06	117,58	50	217	167	40	45	15	135	20	260	155	300
CHV110.40	40°	322,23	126	50	213	163	40	45	15	135	20	260	162,5	300
CHV110.45	45°	311,62	131,41	10	193	183	55	45	20	120	15	265	148,5	295
CHV110.50	50°	309,74	147,60	10	182	172	55	45	20	120	15	265	154,5	295
CHV110.55	55°	302,27	165,76	10	167	157	55	45	20	120	15	265	175,5	295
CHV110.60	60°	305,96	174,61	10	165	155	55	45	20	120	15	265	175,5	295
CHV110.65	65°	285,71	195,11	0	137	137	55	25	20	100	15	265	155,5	295
CHV110.70	70°	288,18	208,33	0	135	135	55	25	20	100	15	265	155,5	295
CHV110.75	75°	290,36	211,76	0	134	134	55	25	20	100	15	275	155,5	310



AERIAL CAM UNIT - OBEN HÄNGENDER SCHIEBER - UNITÀ A CAMME SOSPESA

X VIEW

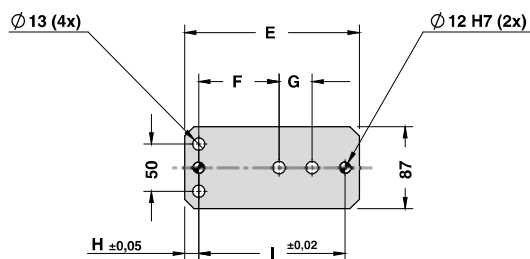
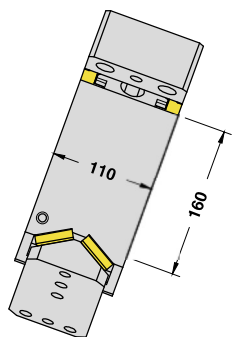

CAM DIAGRAM

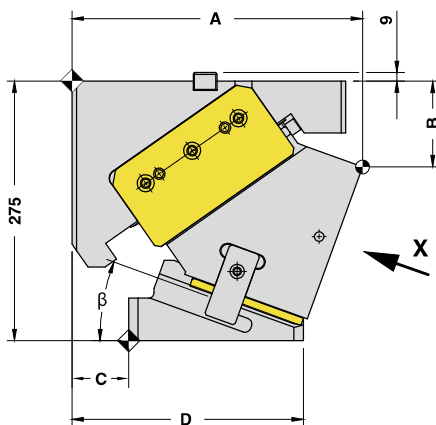
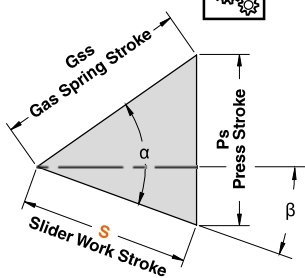

Cam Units CHV

Work Angle	Inner Angle	Slider Work Stroke (mm)	Press Stroke (mm)	Gas Spring Stroke (mm)
β	α	S	Ps	Gss
0°	50°	30,85	36,77	48
5°	50°	34,07	36,91	48
10°	55°	34,46	39,93	48
15°	55°	38,07	40,71	48
20°	55°	41,84	41,84	48
25°	60°	43,38	45,87	48
30°	60°	48,00	48,00	48
35°	65°	50,75	53,11	48
40°	65°	56,79	56,79	48
45°	70°	61,52	63,79	48
50°	70°	48,24	48,24	33
55°	75°	54,06	55,57	33
60°	75°	63,75	63,75	33
65°	80°	75,42	76,90	33
70°	80°	95,02	95,02	33
75°	85°	95,13	96,23	25

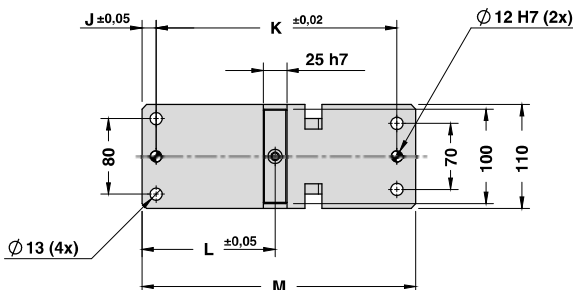



AERIAL CAM UNIT - OBEN HÄNGENDER SCHIEBER - UNITÀ A CAMME SOSPESA

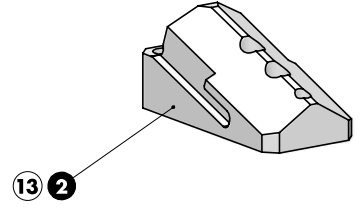
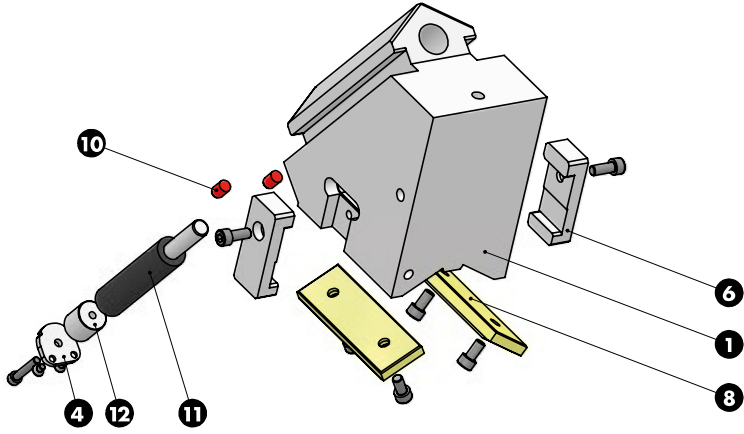
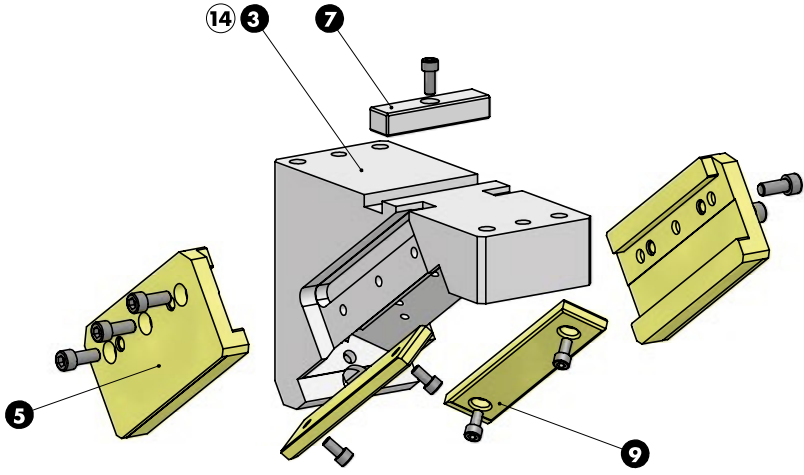



AERIAL CAM UNIT - OBEN HÄNGENDER SCHIEBER - UNITÀ A CAMME SOSPESA

SLIDER STRUCTURE, POSITIVE RETURN STRUCTURE AND CLEARANCES

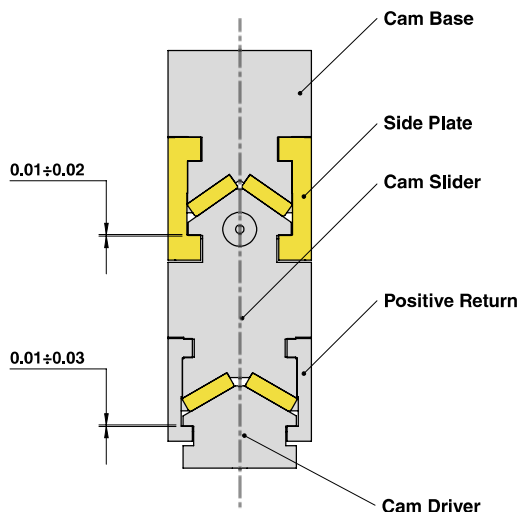

Cam Units CHV

PART LIST

Particular number	Description	Material	Quantity
1	Cam Slider	42CrMo4	1
2	Cam Driver	42CrMo4	1
3	Cam Base	42CrMo4	1
4	Lock Plate	42CrMo4	1
5	Side Plate	CuZn25Al5 + Graphite - HB > 190	2
6	Positive Return	42CrMo4 Nitrided	2
7	Key	CK45	1
8	Wear Plate VDI 3357	CuZn25Al5 + Graphite - HB > 190	2
9	Wear Plate VDI 3357	CuZn25Al5 + Graphite - HB > 190	2
10	Elastomer Cap	Elastomer 92SH	2
11	Gas Spring	-	1
12	Spring Spacer	CK45	1
13	Cam Driver Fixing Screws M12x45 DIN 912	-	4
14	Cam Base Fixing Screws M12x65 DIN 912	-	4
-	Lockout System	(more info on OMCR website)	1

