

DIE MOUNTED CAM UNIT - HORIZONTALSCHIEBER - UNITÀ A CAMME A BASE STAMPO

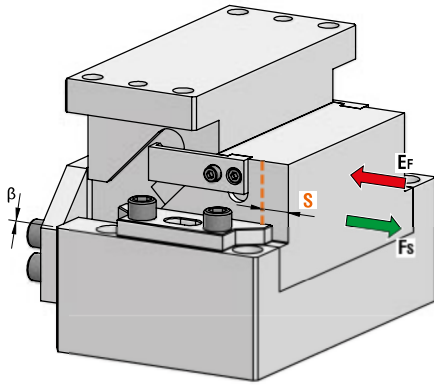

OMCR CODE	Work Angle	Stroke (mm)	Max Work Force with shoulder (kN)	Extraction Force (kN)
	$\beta$	S	F <sub>s</sub>	E <sub>f</sub>
DLC-DLCA200.00.40	0°	40	126	2,91
DLC-DLCA200.00.60	0°	60	126	2,93

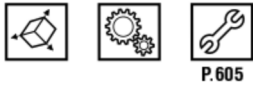

FOR REPLACEMENT ONLY  
SEE DHC FROM PAGE 886  
FOR NEW DIES

		Art.	Work Angle = 0°	Stroke = 60
		DLC200	00	60

OMCR CODE		Work Angle	Stroke (mm)	Overall Dimensions (mm)						
				$\beta$	S	A	B	C	D	E
DLC200.00.40	DLCA200.00.40	0°	40	200	200	135	110	90	65	130
DLC200.00.60	DLCA200.00.60	0°	60	220	210	145	120	110	75	150

DIE MOUNTED CAM UNIT - HORIZONTALSCHIEBER - UNITÀ A CAMME A BASE STAMPO

X VIEW

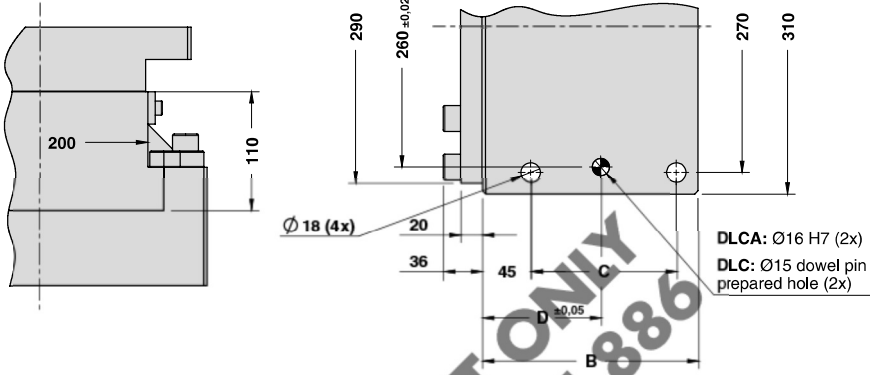

CAM DIAGRAM

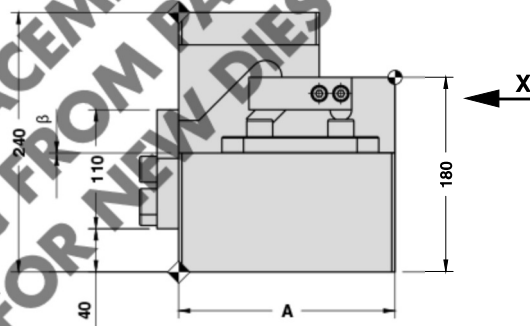
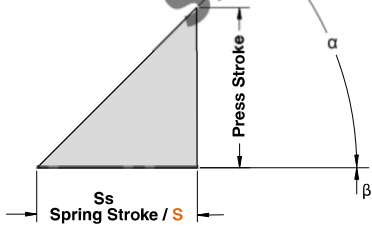

Cam Units  
DLC/DLCA

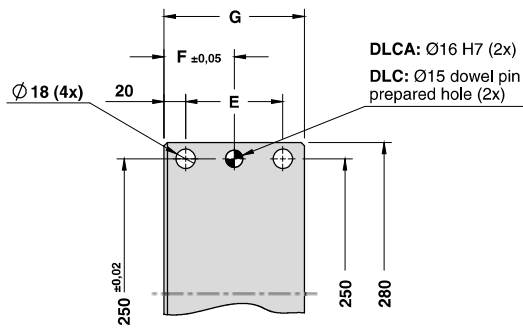

Work Angle	Inner Angle	Slider Work Stroke (mm)	Press Stroke (mm)	Spring Stroke (mm)
$\beta$	$\alpha$	S	Ps	Ss
0°	45°	40	40	40
0°	45°	60	60	60

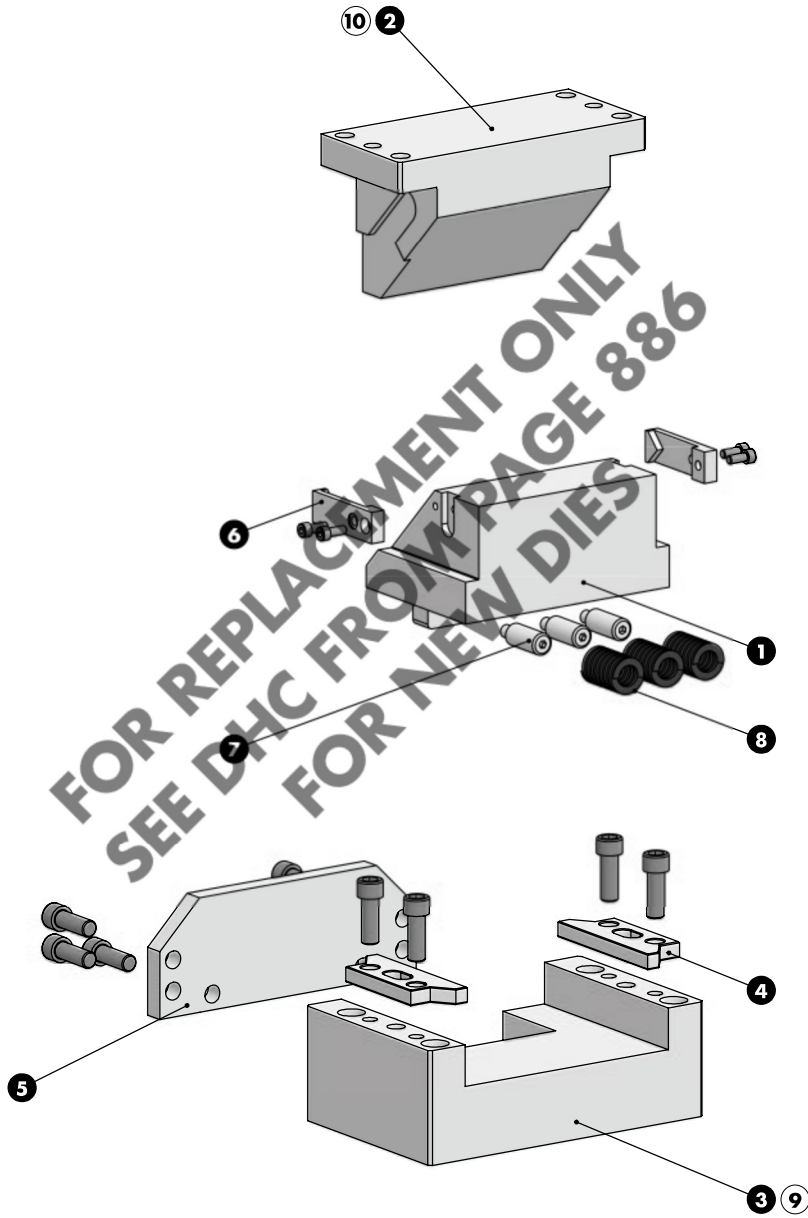

## DIE MOUNTED CAM UNIT - HORIZONTALSCHIEBER - UNITÀ A CAMME A BASE STAMPO

## SLIDER STRUCTURE, POSITIVE RETURN STRUCTURE AND CLEARANCES

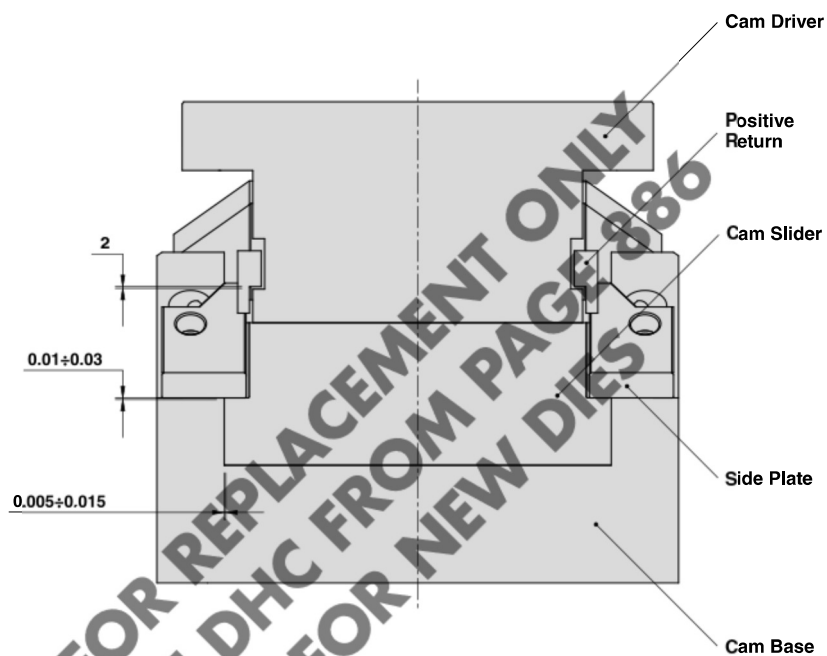
Cam Units  
DLC/DLCA

## PART LIST

Particular number	Description	Material	Quantity
1	Cam Slider	GG-25 + Graphite	1
2	Cam Driver	GG-25 + Graphite	1
3	Cam Base	GG-25	1
4	Side Plate	CK45	2
5	Stopper Plate	St44	1
6	Positive Return	CK45	2
7	Spring Guide Pin	CK45	3
8	Spring	-	3
9	Cam Base Fixing Screws M16x80 DIN 912	-	4
10	Cam Driver Fixing Screws M16x60 DIN 912	-	4