

DIE MOUNTED CAM UNIT - HORIZONTALSCHIEBER - UNITÀ A CAMME A BASE STAMPO

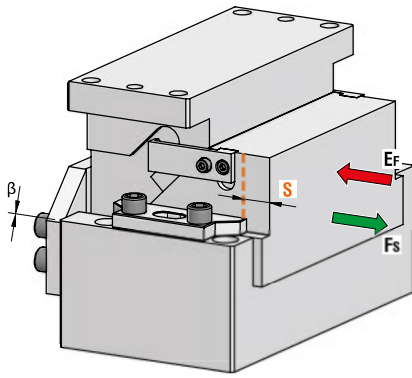

OMCR CODE	Work Angle	Stroke (mm)	Max Work Force with shoulder (kN)	Extraction Force (kN)
	β	S	F _s	E _f
DLC-DLCA250.00.40	0°	40	158	3,80
DLC-DLCA250.00.60	0°	60	158	3,83



FOR REPLACEMENT ONLY
SEE DHC FROM PAGE 886
FOR NEW DIES



Art.	Work Angle = 0°	Stroke = 60
DLC250	00	60

OMCR CODE	Work Angle	Stroke	Overall Dimensions (mm)							
			β	S	A	B	C	D	E	F
DLC250.00.40	DLC250.00.40	0°	40	210	200	135	105	100	70	140
DLC250.00.60	DLC250.00.60	0°	60	230	220	155	125	120	80	160

DIE MOUNTED CAM UNIT - HORIZONTALSCHIEBER - UNITÀ A CAMME A BASE STAMPO

X VIEW

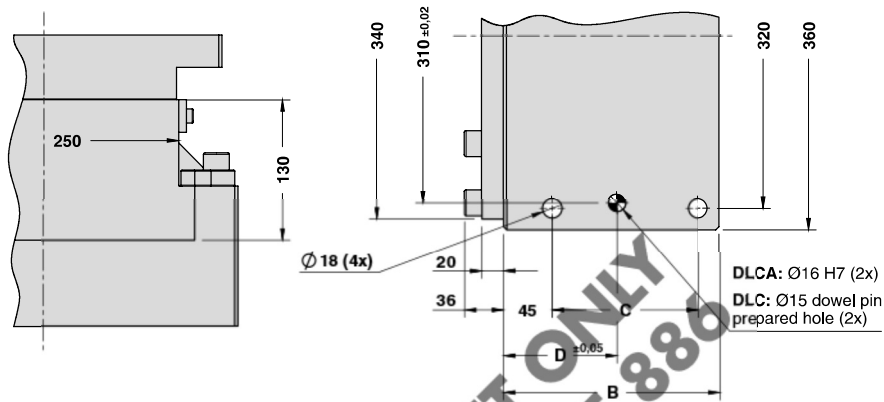

CAM DIAGRAM

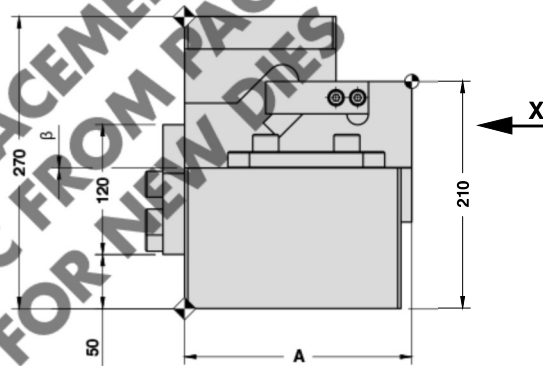
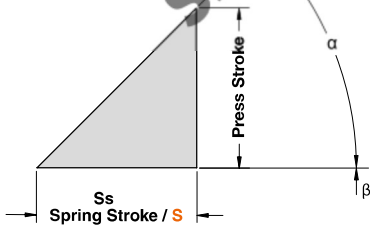

Cam Units
DLC/DLCA

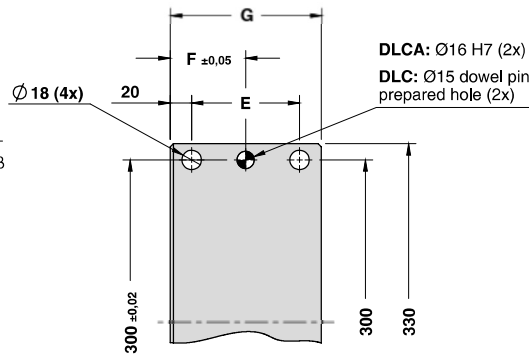

Work Angle	Inner Angle	Slider Work Stroke (mm)	Press Stroke (mm)	Spring Stroke (mm)
β	α	S	Ps	Ss
0°	45°	40	40	40
0°	45°	60	60	60

DIE MOUNTED CAM UNIT - HORIZONTALSCHIEBER - UNITÀ A CAMME A BASE STAMPO

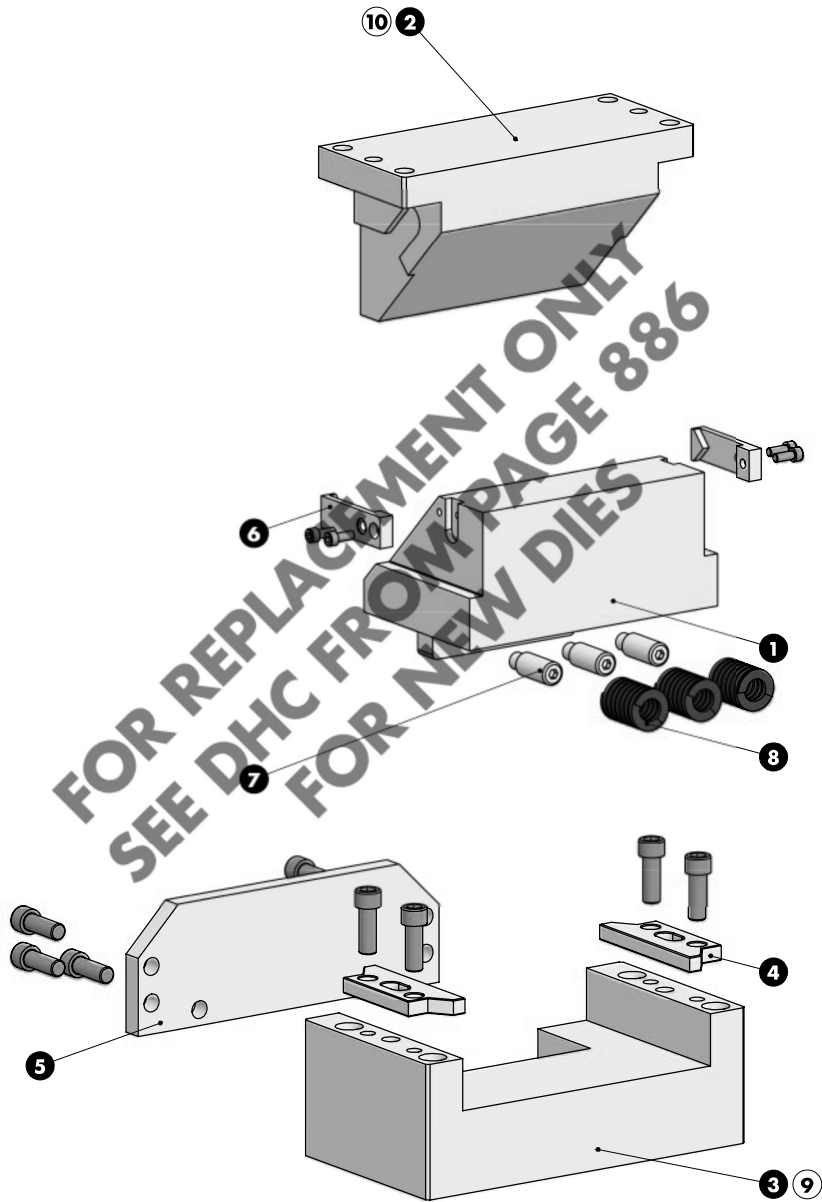

DIE MOUNTED CAM UNIT - HORIZONTALSCHIEBER - UNITÀ A CAMME A BASE STAMPO

SLIDER STRUCTURE, POSITIVE RETURN STRUCTURE AND CLEARANCES

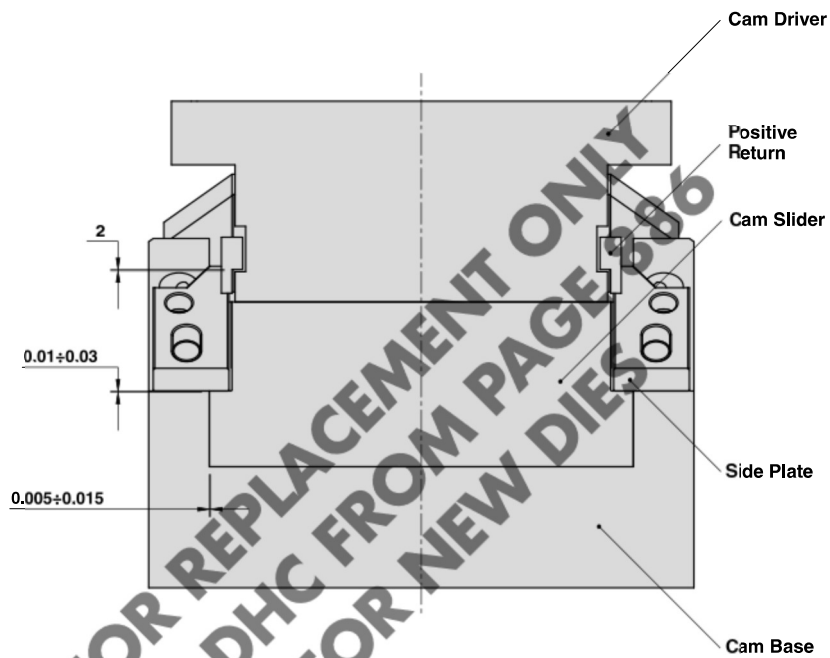

Cam Units
DLC/DLCA

PART LIST			
Particular number	Description	Material	Quantity
1	Cam Slider	GG-25 + Graphite	1
2	Cam Driver	GG-25 + Graphite	1
3	Cam Base	GG-25	1
4	Side Plate	CK45	2
5	Stopper Plate	St44	1
6	Positive Return	CK45	2
7	Spring Guide Pin	CK45	3
8	Spring	-	3
9	Cam Base Fixing Screws M16x90 DIN 912	-	4
10	Cam Driver Fixing Screws M16x60 DIN 912	-	4