

Series 227 Product Overview

Features:

- Low profile
- Large handle clearance in the open position.
- Available in stainless steel
- BLK models feature a black, non-reflective finish

Applications:

- Assembly
- Checking fixtures
- Closures
- Woodworking

Also Available:

See page 7.1 for accessories

Accommodates M6 or 5/16" spindle accessory

**227-U**  
Flanged Base  
U-Bar

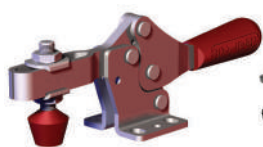

**227-U-LS-BLK** ⓘ  
Blackout Series  
Flanged Base  
U-Bar



**227-USS**  
Flanged Base  
U-Bar, Stainless  
Steel



**227-UB**  
Straight Base  
U-Bar

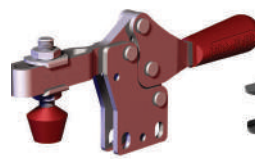

**227-UB-LS-BLK** ⓘ  
Blackout Series  
Straight Base  
U-Bar



**227-U-L** ⓘ  
Flanged Base  
Open Bar

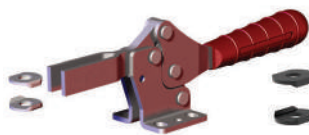

**227-U-L-BLK** ⓘ  
Blackout Series  
Flanged Base  
Open Bar



**227-UB-L** ⓘ  
Straight Base  
Open Bar

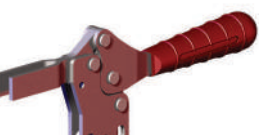

**227-UB-L-BLK** ⓘ  
Blackout Series  
Straight Base  
Open Bar



Note: Clamps shown with included accessories.

ⓘ This item is available upon request

Series 227 Technical Information

Model	Max. Holding Capacity	Clamp Bar Opening (+10°)	Handle Opening (+10°)	Weight	Accessories (Supplied)	
					Spindle Assembly	Flanged Washers
<b>227-U</b>	2220 N [500 lbf]	91°	56°	0,31kg [0.68lb]	225208-M	507107
<b>227-U-LS-BLK</b> ⓘ					--	507107-BLK
<b>227-USS</b>	2670 N [600 lbf]				-207943-M	507907
<b>227-UB</b>	2220 N [500 lbf]				225208-M	507107
<b>227-UB-LS-BLK</b> ⓘ					--	507107-BLK
<b>227-U-L</b> ⓘ					--	507107
<b>227-U-L-BLK</b> ⓘ					--	507107-BLK
<b>227-UB-L</b> ⓘ					--	507107
<b>227-UB-L-BLK</b> ⓘ		--	507107-BLK			

ⓘ This item is available upon request

## Series 227 Holding Capacities

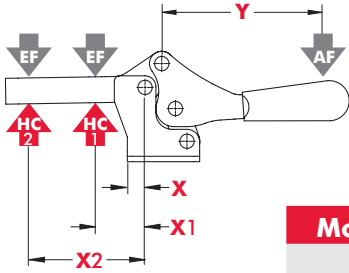

Model	X	X1	X2	Y	±HC1	±HC2	±EF(X1):AF	±EF(X2):AF
<b>U</b>					[500lbf.] 2220N	[225lbf.] 1000N		
<b>USS</b>	[0.39] 10,0	[1.25] 31,8	[2.75] 70,0	[3.58] 91,0	[600lbf.] 2670N	[270lbf.] 1200N	8:1	3:1
<b>UB/U-L/ UB-L</b>					500lbf.] 2220N	[225lbf.] 1000N		

Dimensions shown "mm [inch]" ± HC = Holding Capacity, EF = Exerting Force, AF = Applied Force  
Refer to page 15.4 for additional information.

**227-U**  
Flanged Base  
U-Bar

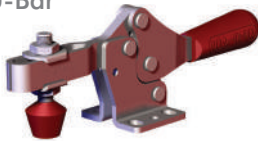

## Series 227 Standard Clamp Dimensions -U/-USS/-UB

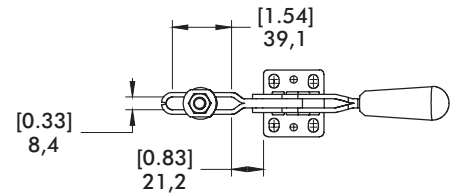

## Series 227 Open Bar

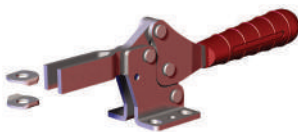

Flanged Base  
**Model**  
**227-U-L**

See page 7.7 for Complete offering of Open bar accessories

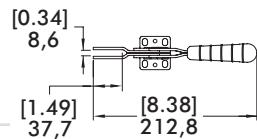

Straight Base  
**Model**  
**227-UB-L**

