

INDUSTRIAL SHOCK ABSORBERS POWERSTOP

INSTALLATION SIZE M25X1.5

▶ PRODUCT SPECIFICATIONS

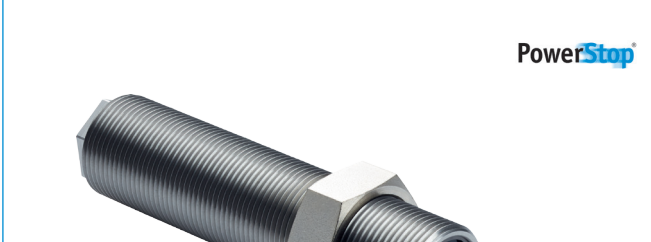

PowerStop®

- ▶ **Angle of Impact max.** 2 [°]
- ▶ **Piston return time** 0.4 [s]
- ▶ **Permitted temperature range** -10 ... +70 [°C]
- ▶ **Max. High Energy pressure (abs.)** 10 [bar]
- ▶ **Max. Standard Energy pressure (abs.)** 1 [bar]
- ▶ **Max. locknut tightening torque** 60 [Nm]
- ▶ **PWIS-free** Yes
- ▶ **RoHS compliant** Yes
- ▶ **REACH compliant** Yes

▶ TECHNICAL DATA

▶ Installation Size: M25X1.5

	Max. energy absorption		Stroke	Impact speed		Return force		Weight	
	Emergency stop operation			min.	max.	min.	max.		
	per stroke	per hour							[m/s]
Order No.	[Nm]	[Nm/h]	[Nm]	[mm]	[m/s]	[N]	[N]	[g]	
HIGH ENERGY									
M25X1.5W	100	80,000	100	25	1.8	4	25	50	300
M25X1.5WS	100	80,000	100	25	1.8	4	25	50	325
M25X1.5WK	100	80,000	100	25	1.8	4	25	50	320
M25X1.5WB	100	80,000	100	25	1.8	4	35	350	345
M25X1.5S	190	100,000	300	25	1.8	3.5	25	50	300
M25X1.5SS	190	100,000	300	25	1.8	3.5	25	50	325
M25X1.5SK	190	100,000	300	25	1.8	3.5	25	50	320
M25X1.5SB	190	100,000	300	25	1.8	3.5	35	350	345
M25X1.5M	210	120,000	400	25	0.8	2.2	25	50	300
M25X1.5MS	210	120,000	400	25	0.8	2.2	25	50	325
M25X1.5MK	210	120,000	400	25	0.8	2.2	25	50	320
M25X1.5MB	210	120,000	400	25	0.8	2.2	35	350	345
M25X1.5H	210	120,000	450	25	0.2	1.2	25	50	300
M25X1.5HS	210	120,000	450	25	0.2	1.2	25	50	325
M25X1.5HK	210	120,000	450	25	0.2	1.2	25	50	320
M25X1.5HB	210	120,000	450	25	0.2	1.2	35	350	345

	Max. energy absorption		Stroke	Impact speed		Return force		Weight	
	Emergency stop operation			min.	max.	min.	max.		
	per stroke	per hour							[m/s]
Order no.	[Nm]	[Nm/h]	[Nm]	[mm]	[m/s]	[N]	[N]	[g]	
STANDARD ENERGY									
M25X1.5RS	90	80,000	90	25	1.8	3.5	10	35	285
M25X1.5RSS	90	80,000	90	25	1.8	3.5	10	35	310
M25X1.5RSK	90	80,000	90	25	1.8	3.5	10	35	305
M25X1.5RM	90	80,000	90	25	0.8	2.2	10	35	285
M25X1.5RMS	90	80,000	90	25	0.8	2.2	10	35	310
M25X1.5RMK	90	80,000	90	25	0.8	2.2	10	35	305
M25X1.5RH	90	80,000	90	25	0.2	1.2	10	35	285
M25X1.5RHS	90	80,000	90	25	0.2	1.2	10	35	310
M25X1.5RHK	90	80,000	90	25	0.2	1.2	10	35	305

► TECHNICAL DRAWINGS

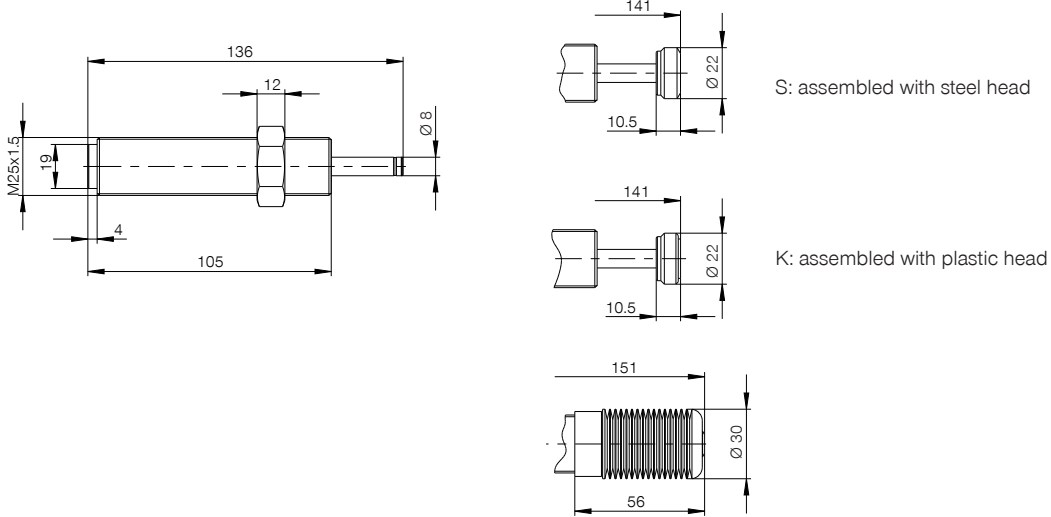

► ACCESSORIES

► Installation Size: **M25X1.5**

Pos.	Order no.	Accessories	Weight [g]	Remarks
①	MSM25X1.5	Steel locknut	35	
①	MVM25X1.5	Stainless steel locknut	35	
②	MAH25X1.5	Stop sleeve	130	Including 1x MVM25X1.5
③	MKF25X1.5	Clamping flange	235	Max. tightening torque of the screws 22 Nm
④	MRA25X1.5	Side load adapter / air barrier adapter	385	Max. angle of impact 30°, suitable MSM, MVM, MAH and MKF in the size M33X1.5 Including setscrew in compressed air connection M5
⑤	MKM25X1.5	Cooling nut	65	Increase of the energy absorption per hour up to 1.5 times

