

Mâner fix • DIN 39
24450.0132

Descrierea produsului



Material

- Oțel, strunjit, zincat prin galvanizare, pasivat

Desen



Figura 1



Figura 2



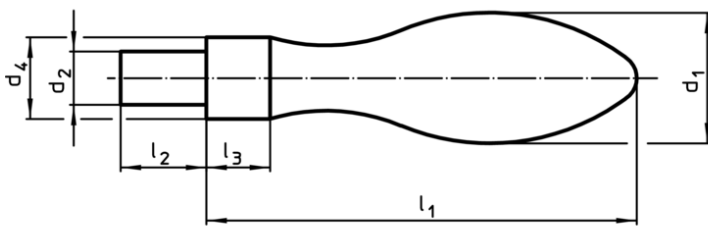

Figura 2

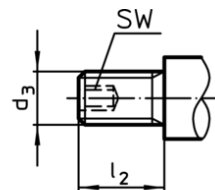
Informații comandă

| Dimensiuni | | | | | | SW |  | RoHS | REACH | Ref. Nr. |
|--|----------------|-----------------------|----------------|----------------|----------------|------|---|---------------------|------------------------------|------------|
| d ₁ | d ₃ | d ₄ h13 | l ₁ | l ₂ | l ₃ | [mm] | [g] | | | |
| cu bosaj cu filet exterior, forma E – figura 2, oțel | | | | | | | | | | |
| 32 | M12 | 20 | 100 | 21 | 13 | 6 | 346 | Reclamație- RoHS | nu conține materiale SVHC | 24450.0132 |

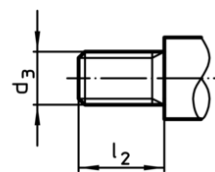
Exemplu de aplicație

